

ENG-CDR21013-R2-CDs.pdf Markup Summary

1 (1)

and plan reconstruction. To fill in contact the Utility Notification Center
if checking any of these approved plans, the Grading and Erosion Control
or Stormwater Management (SWM) Plans and approved for use under the
California Engineering Council Manual (CECM)
California Engineering Council Manual (CECM) Volume 1 and
California Engineering Council Manual (CECM) Volume 2 and
California Engineering Council Manual (CECM) Volume 3 and
California Engineering Council Manual (CECM) Volume 4 and
California Engineering Council Manual (CECM) Volume 5 and
California Engineering Council Manual (CECM) Volume 6 and
California Engineering Council Manual (CECM) Volume 7 and
California Engineering Council Manual (CECM) Volume 8 and
California Engineering Council Manual (CECM) Volume 9 and
California Engineering Council Manual (CECM) Volume 10 and
California Engineering Council Manual (CECM) Volume 11 and
California Engineering Council Manual (CECM) Volume 12 and
California Engineering Council Manual (CECM) Volume 13 and
California Engineering Council Manual (CECM) Volume 14 and
California Engineering Council Manual (CECM) Volume 15 and
California Engineering Council Manual (CECM) Volume 16 and
California Engineering Council Manual (CECM) Volume 17 and
California Engineering Council Manual (CECM) Volume 18 and
California Engineering Council Manual (CECM) Volume 19 and
California Engineering Council Manual (CECM) Volume 20 and
California Engineering Council Manual (CECM) Volume 21 and
California Engineering Council Manual (CECM) Volume 22 and
California Engineering Council Manual (CECM) Volume 23 and
California Engineering Council Manual (CECM) Volume 24 and
California Engineering Council Manual (CECM) Volume 25 and
California Engineering Council Manual (CECM) Volume 26 and
California Engineering Council Manual (CECM) Volume 27 and
California Engineering Council Manual (CECM) Volume 28 and
California Engineering Council Manual (CECM) Volume 29 and
California Engineering Council Manual (CECM) Volume 30 and
California Engineering Council Manual (CECM) Volume 31 and
California Engineering Council Manual (CECM) Volume 32 and
California Engineering Council Manual (CECM) Volume 33 and
California Engineering Council Manual (CECM) Volume 34 and
California Engineering Council Manual (CECM) Volume 35 and
California Engineering Council Manual (CECM) Volume 36 and
California Engineering Council Manual (CECM) Volume 37 and
California Engineering Council Manual (CECM) Volume 38 and
California Engineering Council Manual (CECM) Volume 39 and
California Engineering Council Manual (CECM) Volume 40 and
California Engineering Council Manual (CECM) Volume 41 and
California Engineering Council Manual (CECM) Volume 42 and
California Engineering Council Manual (CECM) Volume 43 and
California Engineering Council Manual (CECM) Volume 44 and
California Engineering Council Manual (CECM) Volume 45 and
California Engineering Council Manual (CECM) Volume 46 and
California Engineering Council Manual (CECM) Volume 47 and
California Engineering Council Manual (CECM) Volume 48 and
California Engineering Council Manual (CECM) Volume 49 and
California Engineering Council Manual (CECM) Volume 50 and
California Engineering Council Manual (CECM) Volume 51 and
California Engineering Council Manual (CECM) Volume 52 and
California Engineering Council Manual (CECM) Volume 53 and
California Engineering Council Manual (CECM) Volume 54 and
California Engineering Council Manual (CECM) Volume 55 and
California Engineering Council Manual (CECM) Volume 56 and
California Engineering Council Manual (CECM) Volume 57 and
California Engineering Council Manual (CECM) Volume 58 and
California Engineering Council Manual (CECM) Volume 59 and
California Engineering Council Manual (CECM) Volume 60 and
California Engineering Council Manual (CECM) Volume 61 and
California Engineering Council Manual (CECM) Volume 62 and
California Engineering Council Manual (CECM) Volume 63 and
California Engineering Council Manual (CECM) Volume 64 and
California Engineering Council Manual (CECM) Volume 65 and
California Engineering Council Manual (CECM) Volume 66 and
California Engineering Council Manual (CECM) Volume 67 and
California Engineering Council Manual (CECM) Volume 68 and
California Engineering Council Manual (CECM) Volume 69 and
California Engineering Council Manual (CECM) Volume 70 and
California Engineering Council Manual (CECM) Volume 71 and
California Engineering Council Manual (CECM) Volume 72 and
California Engineering Council Manual (CECM) Volume 73 and
California Engineering Council Manual (CECM) Volume 74 and
California Engineering Council Manual (CECM) Volume 75 and
California Engineering Council Manual (CECM) Volume 76 and
California Engineering Council Manual (CECM) Volume 77 and
California Engineering Council Manual (CECM) Volume 78 and
California Engineering Council Manual (CECM) Volume 79 and
California Engineering Council Manual (CECM) Volume 80 and
California Engineering Council Manual (CECM) Volume 81 and
California Engineering Council Manual (CECM) Volume 82 and
California Engineering Council Manual (CECM) Volume 83 and
California Engineering Council Manual (CECM) Volume 84 and
California Engineering Council Manual (CECM) Volume 85 and
California Engineering Council Manual (CECM) Volume 86 and
California Engineering Council Manual (CECM) Volume 87 and
California Engineering Council Manual (CECM) Volume 88 and
California Engineering Council Manual (CECM) Volume 89 and
California Engineering Council Manual (CECM) Volume 90 and
California Engineering Council Manual (CECM) Volume 91 and
California Engineering Council Manual (CECM) Volume 92 and
California Engineering Council Manual (CECM) Volume 93 and
California Engineering Council Manual (CECM) Volume 94 and
California Engineering Council Manual (CECM) Volume 95 and
California Engineering Council Manual (CECM) Volume 96 and
California Engineering Council Manual (CECM) Volume 97 and
California Engineering Council Manual (CECM) Volume 98 and
California Engineering Council Manual (CECM) Volume 99 and
California Engineering Council Manual (CECM) Volume 100 and

Subject: COMMENT
Page Index: 1
Date: 1/28/2022 10:20:40 AM
Author: Alivia Plankis
Color: ■
Layer:
Space:
Page Label: 1

State which year is applicable.

3 (10)

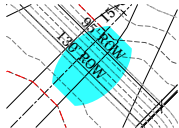

Subject:
Page Index: 3
Date: 1/25/2022 1:32:14 PM
Author: dsdrice
Color: ■
Layer:
Space:
Page Label: 3

ROW

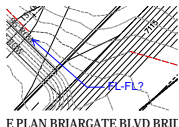

E PLAN BRIARGATE BLVD BRID

Subject: Callout
Page Index: 3
Date: 1/25/2022 1:32:49 PM
Author: dsdrice
Color: ■
Layer:
Space:
Page Label: 3

FL-FL?

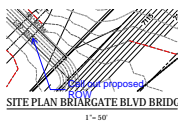

SITE PLAN BRIARGATE BLVD BRIDC
1-50

Subject: Callout
Page Index: 3
Date: 1/25/2022 1:33:56 PM
Author: dsdrice
Color: ■
Layer:
Space:
Page Label: 3

Call out proposed ROW

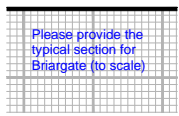

Subject: Callout
Page Index: 3
Date: 1/25/2022 3:03:51 PM
Author: dsdrice
Color: ■
Layer:
Space:
Page Label: 3

Please provide the typical section for Briargate (to scale)

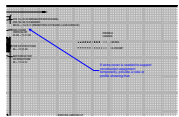

Subject: Callout
Page Index: 3
Date: 1/27/2022 10:53:13 AM
Author: dsdrice
Color: ■
Layer:
Space:
Page Label: 3

If extra cover is needed to support construction equipment temporarily, provide a note or profile showing that.

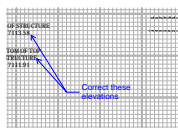

Subject: Callout
Page Index: 3
Date: 1/27/2022 10:54:14 AM
Author: dsdrice
Color: ■
Layer:
Space:
Page Label: 3

Correct these elevations

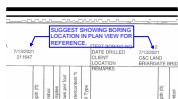

Subject: COMMENT
Page Index: 3
Date: 1/28/2022 10:21:07 AM
Author: Alivia Plankis
Color: ■
Layer:
Space:
Page Label: 3

SUGGEST SHOWING BORING LOCATION IN PLAN VIEW FOR REFERENCE.

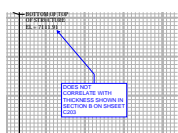

Subject: COMMENT
Page Index: 3
Date: 1/28/2022 10:21:15 AM
Author: Alivia Plankis
Color: ■
Layer:
Space:
Page Label: 3

DOES NOT CORRELATE WITH THICKNESS SHOWN IN SECTION B ON SHSHEET C203

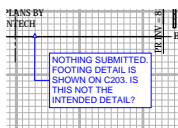

Subject: COMMENT
Page Index: 3
Date: 1/28/2022 10:21:07 AM
Author: Alivia Plankis
Color: ■
Layer:
Space:
Page Label: 3

NOTHING SUBMITTED. FOOTING DETAIL IS SHOWN ON C203. IS THIS NOT THE INTENDED DETAIL?

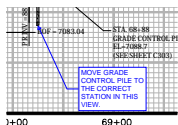

Subject: COMMENT
Page Index: 3
Date: 1/28/2022 10:21:07 AM
Author: Alivia Plankis
Color: ■
Layer:
Space:
Page Label: 3

MOVE GRADE CONTROL PILE TO THE CORRECT STATION IN THIS VIEW.

4 (14)

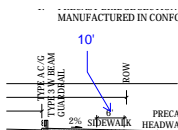

Subject: Callout
Page Index: 4
Date: 1/25/2022 2:05:49 PM
Author: dsdrice
Color: ■
Layer:
Space:
Page Label: 4

10'

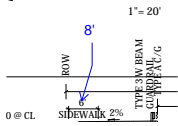

Subject: Callout
Page Index: 4
Date: 1/25/2022 2:05:36 PM
Author: dsdrice
Color: ■
Layer:
Space:
Page Label: 4

8'

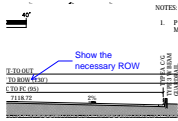

Subject: Callout
Page Index: 4
Date: 1/25/2022 2:06:21 PM
Author: dsdrice
Color: ■
Layer:
Space:
Page Label: 4

Show the necessary ROW

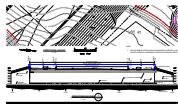

Subject: Dimension
Page Index: 4
Date: 1/25/2022 2:07:55 PM
Author: dsdrice
Color: ■
Layer:
Space:
Page Label: 4

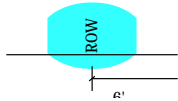

Subject:
Page Index: 4
Date: 1/25/2022 2:08:38 PM
Author: dsdrice
Color: ■
Layer:
Space:
Page Label: 4

ROW

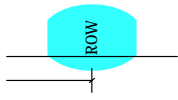

Subject:
Page Index: 4
Date: 1/25/2022 2:09:03 PM
Author: dsdrice
Color: ■
Layer:
Space:
Page Label: 4

ROW

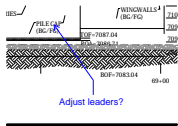

Subject: Callout
Page Index: 4
Date: 1/25/2022 2:10:20 PM
Author: dsdrice
Color: ■
Layer:
Space:
Page Label: 4

Adjust leaders?

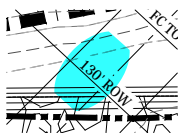

Subject: 130'
Page Index: 4
Date: 1/25/2022 2:11:19 PM
Author: dsdrice
Color: ■
Layer:
Space:
Page Label: 4

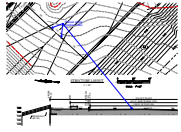

Subject: Callout
Page Index: 4
Date: 1/25/2022 2:17:02 PM
Author: dsdrice
Color: ■
Layer:
Space:
Page Label: 4

Please show median C&G



Subject: PRECAST
Page Index: 4
Date: 1/26/2022 5:25:07 PM
Author: dsdrice
Color: ■
Layer:
Space:
Page Label: 4

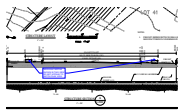

Subject: COMMENT
Page Index: 4
Date: 1/28/2022 10:22:09 AM
Author: Alivia Plankis
Color: ■
Layer:
Space:
Page Label: 4

SIDEWALK WIDTHS SHOWN IN THIS VIEW DO NOT APPEAR TO MATCH PLAN VIEW.

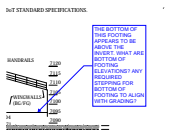

Subject: COMMENT
Page Index: 4
Date: 1/28/2022 10:22:09 AM
Author: Alivia Plankis
Color: ■
Layer:
Space:
Page Label: 4

THE BOTTOM OF THIS FOOTING APPEARS TO BE ABOVE THE INVERT. WHAT ARE BOTTOM OF FOOTING ELEVATIONS? ANY REQUIRED STEPPING FOR BOTTOM OF FOOTING TO ALIGN WITH GRADING?

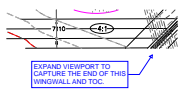

Subject: COMMENT
Page Index: 4
Date: 1/28/2022 10:22:09 AM
Author: Alivia Plankis
Color: ■
Layer:
Space:
Page Label: 4

EXPAND VIEWPORT TO CAPTURE THE END OF THIS WINGWALL AND TOC.

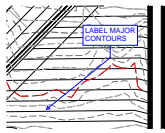

Subject: COMMENT
Page Index: 4
Date: 1/28/2022 10:22:09 AM
Author: Alivia Plankis
Color: ■
Layer:
Space:
Page Label: 4

LABEL MAJOR CONTOURS

5 (14)



Subject: COMMENT
Page Index: 5
Date: 1/28/2022 10:22:36 AM
Author: Alivia Plankis
Color: ■
Layer:
Space:
Page Label: 5

CIP CONCRETE WALLS SHOULD HAVE EXPANSION JOINTS AND CONTROL JOINTS PER CDOT AND GENERAL ENGINEERING PRACTICE FOR LONG RETAINING WALLS. PROVIDE DETAILS AND NOTES.

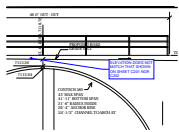

Subject: COMMENT
Page Index: 5
Date: 1/28/2022 10:22:36 AM
Author: Alivia Plankis
Color: ■
Layer:
Space:
Page Label: 5

ELEVATION DOES NOT MATCH THAT SHOWN ON SHEET C201 NOR C202

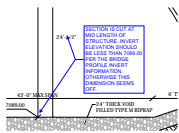

Subject: COMMENT
Page Index: 5
Date: 1/28/2022 10:22:36 AM
Author: Alivia Plankis
Color: ■
Layer:
Space:
Page Label: 5

SECTION IS CUT AT MID LENGTH OF STRUCTURE. INVERT ELEVATION SHOULD BE LESS THAN 7089.00 PER THE BRIDGE PROFILE INVERT INFORMATION. OTHERWISE THIS DIMENSION SEEMS OFF.



Subject: COMMENT
Page Index: 5
Date: 1/28/2022 10:22:36 AM
Author: Alivia Plankis
Color: ■
Layer:
Space:
Page Label: 5

CONFIRM THAT THIS IS A PILE CAP. THERE ARE NO H-PILES SHOWN HERE.

IF H-PILES ARE INTENDED HOW FAR ARE THEY EXPECTED TO BE DRIVEN? PROVIDE AN ESTIMATED TIP ELEVATION. ALSO NEED DETAILS TO SHOW EMBEDMENT INTO PILE CAP.

AN ELEVATION VIEW OF THE WALL COULD HELP CLARIFY.

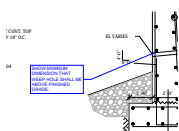

Subject: COMMENT
Page Index: 5
Date: 1/28/2022 10:22:36 AM
Author: Alivia Plankis
Color: ■
Layer:
Space:
Page Label: 5

SHOW MINIMUM DIMENSION THAT WEEP HOLE SHALL BE ABOVE FINISHED GRADE.

GEOTECHNICAL REPORT STATES THAT EXPANSIVE SOIL COULD BE ENCOUNTERED IN SOME AREAS. HOW IS THIS BEING HANDLED FOR THE CONSPAN STRUCTURE FOUNDATIONS AND WINGWALLS?

Subject: COMMENT
Page Index: 5
Date: 1/28/2022 10:22:36 AM
Author: Alivia Plankis
Color: ■
Layer:
Space:
Page Label: 5

GEOTECHNICAL REPORT STATES THAT EXPANSIVE SOIL COULD BE ENCOUNTERED IN SOME AREAS. HOW IS THIS BEING HANDLED FOR THE CONSPAN STRUCTURE FOUNDATIONS AND WINGWALLS?

SHEET NOT PROVIDED OR THIS IS MISLABELED.

Subject: COMMENT
Page Index: 5
Date: 1/28/2022 10:22:36 AM
Author: Alivia Plankis
Color: ■
Layer:
Space:
Page Label: 5

SHEET NOT PROVIDED OR THIS IS MISLABELED.

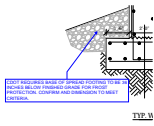

Subject: COMMENT
Page Index: 5
Date: 1/28/2022 10:22:36 AM
Author: Alivia Plankis
Color: ■
Layer:
Space:
Page Label: 5

CDOT REQUIRES BASE OF SPREAD FOOTING TO BE 36 INCHES BELOW FINISHED GRADE FOR FROST PROTECTION. CONFIRM AND DIMENSION TO MEET CRITERIA.

NO H-PILES ARE SHOWN HERE NOR IN FOUNDATION PLAN. PLEASE CLARIFY THE DESIGN OF THIS WALL.

Subject: COMMENT
Page Index: 5
Date: 1/28/2022 10:22:57 AM
Author: Alivia Plankis
Color: ■
Layer:
Space:
Page Label: 5

NO H-PILES ARE SHOWN HERE NOR IN FOUNDATION PLAN. PLEASE CLARIFY THE DESIGN OF THIS WALL.

UNCLEAR WHAT THIS IS POINTING TO.

Subject: COMMENT
Page Index: 5
Date: 1/28/2022 10:23:06 AM
Author: Alivia Plankis
Color: ■
Layer:
Space:
Page Label: 5

UNCLEAR WHAT THIS IS POINTING TO.

UNCLEAR WHICH SOIL WAS ASSUMED FOR DESIGN. GEOTECH REPORT GIVES THREE DIFFERENT ALLOWABLE BEARING PRESSURES FOR THREE DIFFERNT TYPES OF BEARING SOIL. INCLUDE DESIGN ALLOWABLE BEARING PRESSURE IN PLANS. HOWEVER, IT SHOULD BE NOTED THAT CDOT REQUIRES LRFD DESIGN AND NOT ASD.

Subject: COMMENT
Page Index: 5
Date: 1/28/2022 10:22:36 AM
Author: Alivia Plankis
Color: ■
Layer:
Space:
Page Label: 5

UNCLEAR WHICH SOIL WAS ASSUMED FOR DESIGN. GEOTECH REPORT GIVES THREE DIFFERENT ALLOWABLE BEARING PRESSURES FOR THREE DIFFERNT TYPES OF BEARING SOIL. INCLUDE DESIGN ALLOWABLE BEARING PRESSURE IN PLANS. HOWEVER, IT SHOULD BE NOTED THAT CDOT REQUIRES LRFD DESIGN AND NOT ASD.

Subject: COMMENT
Page Index: 5
Date: 1/28/2022 10:22:36 AM
Author: Alivia Plankis
Color: ■
Layer:
Space:
Page Label: 5

DESIGN SEEMS INCOMPLETE. IS THIS A SPREAD FOOTING OR A RETAINING WALL ON H-PILE WITH PILE CAP? IF THE LATTER, ADDITIONAL DETAILS ARE NEEDED. WHAT IS BOTTOM OF FOOTING ELEVATION AT EACH WALL?

Subject: COMMENT
Page Index: 5
Date: 1/28/2022 10:22:36 AM
Author: Alivia Plankis
Color: ■
Layer:
Space:
Page Label: 5

SUGGEST PROVIDING DETAILS SHOWING THE EXCAVATION RECOMMENDATIONS OUTLINED IN THE GEOTECHNICAL REPORT FOR THE STRUCTURES AND FOUNDATIONS.

Subject: COMMENT
Page Index: 5
Date: 1/28/2022 10:22:36 AM
Author: Alivia Plankis
Color: ■
Layer:
Space:
Page Label: 5

This seems to be the only call out or detail for the riprap lined channel. Are there dimensions or station limits called out anywhere? The drainage report refers to soil riprap instead of void filled riprap.

6 (1)

Subject: COMMENT
Page Index: 6
Date: 1/28/2022 10:23:31 AM
Author: Alivia Plankis
Color: ■
Layer:
Space:
Page Label: 6

NEED TO PROVIDE THE ACTUAL M-STD INTENDED. THERE IS MORE THAN ONE M-606.

7 (5)

Subject: COMMENT
Page Index: 7
Date: 1/28/2022 10:23:57 AM
Author: Alivia Plankis
Color: ■
Layer:
Space:
Page Label: 7

IS THIS EQUIVALENT TO CDOT CLASS 1 BACKFILL OR THE GEOTECHNICAL RECOMMENDATION?

Subject: COMMENT
Page Index: 7
Date: 1/28/2022 10:23:57 AM
Author: Alivia Plankis
Color: ■
Layer:
Space:
Page Label: 7

HOW DOES THE PRECAST FABRICATOR KNOW THE DIMENSIONS OF THE HEADWALLS? SUGGEST PROVIDING BASIC ELEVATIONS AND DIMENSIONS TO ASSIST IN SHOP DRAWING DEVELOPMENT.



Subject: COMMENT
Page Index: 7
Date: 1/28/2022 10:23:57 AM
Author: Alivia Plankis
Color: ■
Layer:
Space:
Page Label: 7

WHERE DOES THIS APPLY?



Subject: COMMENT
Page Index: 7
Date: 1/28/2022 10:23:57 AM
Author: Alivia Plankis
Color: ■
Layer:
Space:
Page Label: 7

WHERE DOES THIS APPLY?

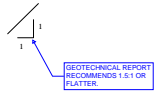

Subject: COMMENT
Page Index: 7
Date: 1/28/2022 10:23:57 AM
Author: Alivia Plankis
Color: ■
Layer:
Space:
Page Label: 7

GEOTECHNICAL REPORT RECOMMENDS 1.5:1 OR FLATTER.

8 (11)

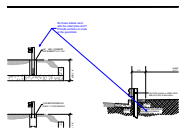

Subject: Callout
Page Index: 8
Date: 1/25/2022 2:21:29 PM
Author: dsdrice
Color: ■
Layer:
Space:
Page Label: 8

Do these details work with the steel plate arch?
Provide sections to scale at the guardrails.



Subject:
Page Index: 8
Date: 1/25/2022 2:20:00 PM
Author: dsdrice
Color: ■
Layer:
Space:
Page Label: 8

OUN

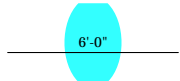

Subject:
Page Index: 8
Date: 1/25/2022 2:20:31 PM
Author: dsdrice
Color: ■
Layer:
Space:
Page Label: 8

6'-0"

VARIES
(8'-0")

Subject:
Page Index: 8
Date: 1/25/2022 2:20:36 PM
Author: dsdrice
Color: 
Layer:
Space:
Page Label: 8

VARIES

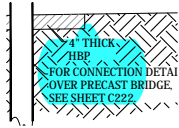

Subject:
Page Index: 8
Date: 1/25/2022 2:21:09 PM
Author: dsdrice
Color: 
Layer:
Space:
Page Label: 8

P
FOR CONNECTIO

DETAILS SEEM INCOMPLETE. WHAT IS THE HEIGHT OF THE CONCRETE ENCASEMENT? WHAT ARE THE DIMENSIONS AND HEIGHT OF THE OF THE CONCRETE PEDESTALS?
IS REINFORCEMENT NEEDED?
WHERE ARE THESE MOUNTING DETILS TO BE USED?

Subject: COMMENT
Page Index: 8
Date: 1/28/2022 10:24:13 AM
Author: Alivia Plankis
Color: 
Layer:
Space:
Page Label: 8

DETAILS SEEM INCOMPLETE. WHAT IS THE HEIGHT OF THE CONCRETE ENCASEMENT? WHAT ARE THE DIMENSIONS AND HEIGHT OF THE OF THE CONCRETE PEDESTALS?

IS REINFORCEMENT NEEDED?

WHERE ARE THESE MOUNTING DETILS TO BE USED?

NEED TO PROVIDE THE ACTUAL M-STD INTENDED. THERE IS MORE THAN ONE M-606.

Subject: COMMENT
Page Index: 8
Date: 1/28/2022 10:24:13 AM
Author: Alivia Plankis
Color: 
Layer:
Space:
Page Label: 8

NEED TO PROVIDE THE ACTUAL M-STD INTENDED. THERE IS MORE THAN ONE M-606.

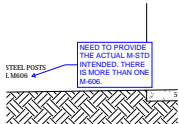

Subject: COMMENT
Page Index: 8
Date: 1/28/2022 10:24:13 AM
Author: Alivia Plankis
Color: 
Layer:
Space:
Page Label: 8

NEED TO PROVIDE THE ACTUAL M-STD INTENDED. THERE IS MORE THAN ONE M-606.

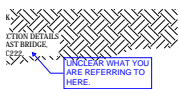

Subject: COMMENT
Page Index: 8
Date: 1/28/2022 10:24:13 AM
Author: Alivia Plankis
Color: 
Layer:
Space:
Page Label: 8

UNCLEAR WHAT YOU ARE REFERRING TO HERE.

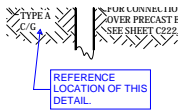

Subject: COMMENT
Page Index: 8
Date: 1/28/2022 10:24:13 AM
Author: Alivia Plankis
Color: ■
Layer:
Space:
Page Label: 8

REFERENCE LOCATION OF THIS DETAIL.

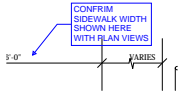

Subject: COMMENT
Page Index: 8
Date: 1/28/2022 10:24:13 AM
Author: Alivia Plankis
Color: ■
Layer:
Space:
Page Label: 8

CONFIRM SIDEWALK WIDTH SHOWN HERE WITH PLAN VIEWS

9 (4)



Subject: COMMENT
Page Index: 9
Date: 1/28/2022 10:24:50 AM
Author: Alivia Plankis
Color: ■
Layer:
Space:
Page Label: 9

WINGWALL ALSO?

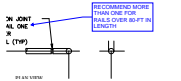

Subject: COMMENT
Page Index: 9
Date: 1/28/2022 10:24:50 AM
Author: Alivia Plankis
Color: ■
Layer:
Space:
Page Label: 9

RECOMMEND MORE THAN ONE FOR RAILS OVER 80-FT IN LENGTH



Subject: COMMENT
Page Index: 9
Date: 1/28/2022 10:24:50 AM
Author: Alivia Plankis
Color: ■
Layer:
Space:
Page Label: 9

WHERE? IS THIS THE FIXED JOINT DETAIL?



Subject: COMMENT
Page Index: 9
Date: 1/28/2022 10:24:50 AM
Author: Alivia Plankis
Color: ■
Layer:
Space:
Page Label: 9

EPC ENGINEERING CRITERIA MANUAL SECTION 2.5 STATES THAT RAILINGS SHALL NOT HAVE OPENINGS LARGE ENOUGH TO PASS A 4-INCH SPHERE. THIS IS CONSISTENT WITH AAHSTO AND CDOT CRITERIA FOR PEDESTRIAN RAILINGS. IT SHOULD BE DISCUSSED WITH THE COUNTY IF THE RAILINGS ON THE WINGWALLS AND HEADWALLS ARE CONSIDERED PEDESTRIAN RAILINGS. SIDEWALKS ARE PARALLEL TO SOME WINGWALLS AND THE WALLS ARE WITHIN APPROX. 10' FT. OR LESS IN SOME LOCATIONS.

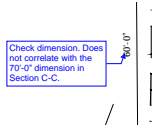

Subject: COMMENT
Page Index: 10
Date: 1/28/2022 10:26:05 AM
Author: Alivia Plankis
Color: ■
Layer:
Space:
Page Label: 10

Check dimension. Does not correlate with the 70'-0" dimension in Section C-C.

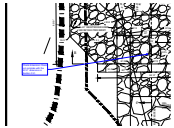

Subject: COMMENT
Page Index: 10
Date: 1/28/2022 10:26:05 AM
Author: Alivia Plankis
Color: ■
Layer:
Space:
Page Label: 10

Check dimension. Does not correlate with the 30'-0" dimension in Section C-C.

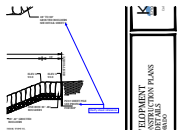

Subject: COMMENT
Page Index: 10
Date: 1/28/2022 10:26:05 AM
Author: Alivia Plankis
Color: ■
Layer:
Space:
Page Label: 10

Clarify sheet reference.

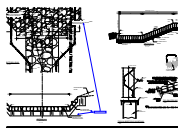

Subject: COMMENT
Page Index: 10
Date: 1/28/2022 10:26:05 AM
Author: Alivia Plankis
Color: ■
Layer:
Space:
Page Label: 10

Clarify sheet reference.

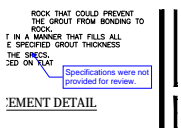

Subject: COMMENT
Page Index: 10
Date: 1/28/2022 10:26:05 AM
Author: Alivia Plankis
Color: ■
Layer:
Space:
Page Label: 10

Specifications were not provided for review.

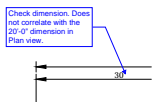

Subject: COMMENT
Page Index: 10
Date: 1/28/2022 10:26:05 AM
Author: Alivia Plankis
Color: ■
Layer:
Space:
Page Label: 10

Check dimension. Does not correlate with the 20'-0" dimension in Plan view.

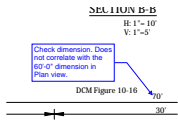

Subject: COMMENT
Page Index: 10
Date: 1/28/2022 10:26:05 AM
Author: Alivia Plankis
Color: ■
Layer:
Space:
Page Label: 10

Check dimension. Does not correlate with the 60'-0" dimension in Plan view.

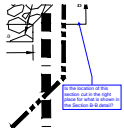

Subject: COMMENT
Page Index: 10
Date: 1/28/2022 10:26:05 AM
Author: Alivia Plankis
Color: ■
Layer:
Space:
Page Label: 10

Is the location of this section cut in the right place for what is shown in the Section B-B detail?



Subject: DELETION
Page Index: 10
Date: 1/28/2022 10:26:05 AM
Author: Alivia Plankis
Color: ■
Layer:
Space:
Page Label: 10



Subject: COMMENT
Page Index: 10
Date: 1/28/2022 10:26:05 AM
Author: Alivia Plankis
Color: ■
Layer:
Space:
Page Label: 10

Clarify this reference, which criteria manual?

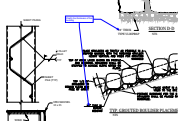

Subject: COMMENT
Page Index: 10
Date: 1/28/2022 10:26:05 AM
Author: Alivia Plankis
Color: ■
Layer:
Space:
Page Label: 10

Clarify the thickness of the bedding



Subject: COMMENT
Page Index: 10
Date: 1/28/2022 10:26:05 AM
Author: Alivia Plankis
Color: ■
Layer:
Space:
Page Label: 10

What does this reference mean?

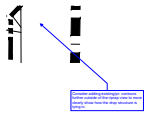

Subject: COMMENT
Page Index: 10
Date: 1/28/2022 10:26:05 AM
Author: Alivia Plankis
Color: ■
Layer:
Space:
Page Label: 10

Consider adding existing/pr. contours further outside of the riprap view to more clearly show how the drop structure is tying in.

11 (14)

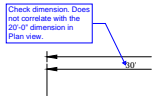

Subject: COMMENT
Page Index: 11
Date: 1/28/2022 10:26:34 AM
Author: Alivia Plankis
Color: ■
Layer:
Space:
Page Label: 11

Check dimension. Does not correlate with the 20'-0" dimension in Plan view.



Subject: DELETION
Page Index: 11
Date: 1/28/2022 10:26:34 AM
Author: Alivia Plankis
Color: ■
Layer:
Space:
Page Label: 11

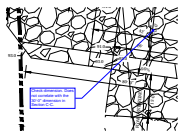

Subject: COMMENT
Page Index: 11
Date: 1/28/2022 10:26:34 AM
Author: Alivia Plankis
Color: ■
Layer:
Space:
Page Label: 11

Check dimension. Does not correlate with the 30'-0" dimension in Section C-C.

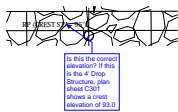

Subject: COMMENT
Page Index: 11
Date: 1/28/2022 10:26:34 AM
Author: Alivia Plankis
Color: ■
Layer:
Space:
Page Label: 11

Is this the correct elevation? If this is the 4' Drop Structure, plan sheet C301 shows a crest elevation of 93.0

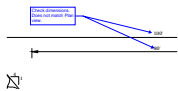

Subject: COMMENT
Page Index: 11
Date: 1/28/2022 10:26:34 AM
Author: Alivia Plankis
Color: ■
Layer:
Space:
Page Label: 11

Check dimensions. Does not match Plan view.

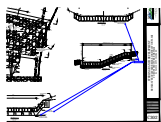

Subject: COMMENT
Page Index: 11
Date: 1/28/2022 10:26:34 AM
Author: Alivia Plankis
Color: ■
Layer:
Space:
Page Label: 11

Clarify sheet reference.

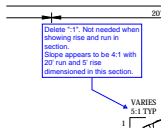

Subject: COMMENT
Page Index: 11
Date: 1/28/2022 10:26:34 AM
Author: Alivia Plankis
Color: ■
Layer:
Space:
Page Label: 11

Delete ":1". Not needed when showing rise and run in section.
 Slope appears to be 4:1 with 20' run and 5' rise dimensioned in this section.

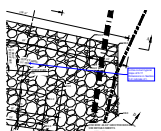

Subject: COMMENT
Page Index: 11
Date: 1/28/2022 10:26:34 AM
Author: Alivia Plankis
Color: ■
Layer:
Space:
Page Label: 11

Is this correct typical slope of 5:1? Dimensions in Section C-C indicate 4:1.

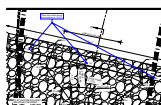

Subject: COMMENT
Page Index: 11
Date: 1/28/2022 10:26:34 AM
Author: Alivia Plankis
Color: ■
Layer:
Space:
Page Label: 11

These three dimensions do not add up to 118'-0".

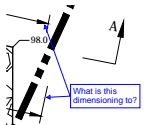

Subject: COMMENT
Page Index: 11
Date: 1/28/2022 10:26:34 AM
Author: Alivia Plankis
Color: ■
Layer:
Space:
Page Label: 11

What is this dimensioning to?

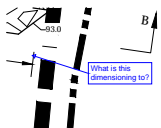

Subject: COMMENT
Page Index: 11
Date: 1/28/2022 10:26:34 AM
Author: Alivia Plankis
Color: ■
Layer:
Space:
Page Label: 11

What is this dimensioning to?

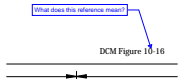

Subject: COMMENT
Page Index: 11
Date: 1/28/2022 10:26:34 AM
Author: Alivia Plankis
Color: ■
Layer:
Space:
Page Label: 11

What does this reference mean?

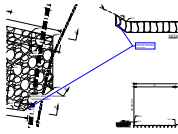

Subject: COMMENT
Page Index: 11
Date: 1/28/2022 10:26:34 AM
Author: Alivia Plankis
Color: ■
Layer:
Space:
Page Label: 11

Check riprap limits against section B-B, looks like they extend further.

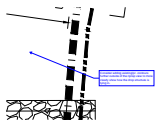

Subject: COMMENT
Page Index: 11
Date: 1/28/2022 10:26:34 AM
Author: Alivia Plankis
Color: ■
Layer:
Space:
Page Label: 11

Consider adding existing/pr. contours further outside of the riprap view to more clearly show how the drop structure is tying in.

12 (5)



Subject: COMMENT
Page Index: 12
Date: 1/28/2022 10:26:56 AM
Author: Alivia Plankis
Color: ■
Layer:
Space:
Page Label: 12

This is shown on Sheet C301. Why repeat here?

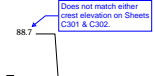

Subject: COMMENT
Page Index: 12
Date: 1/28/2022 10:26:56 AM
Author: Alivia Plankis
Color: ■
Layer:
Space:
Page Label: 12

Does not match either crest elevation on Sheets C301 & C302.

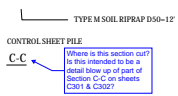

Subject: COMMENT
Page Index: 12
Date: 1/28/2022 10:26:56 AM
Author: Alivia Plankis
Color: ■
Layer:
Space:
Page Label: 12

Where is this section cut? Is this intended to be a detail blow up of part of Section C-C on sheets C301 & C302?

FOR GRADE C
STR

Sheet Pile Size?
What is total
length needed?

Subject: COMMENT
Page Index: 12
Date: 1/28/2022 10:26:56 AM
Author: Alivia Plankis
Color: ■
Layer:
Space:
Page Label: 12

Sheet Pile Size?
What is total length needed?



This riprap is not shown on the drop structure details.

Subject: COMMENT
Page Index: 12
Date: 1/28/2022 10:26:56 AM
Author: Alivia Plankis
Color: ■
Layer:
Space:
Page Label: 12

This riprap is not shown on the drop structure details.