

APPENDIX A: Hydrology and Hydraulic Calculations

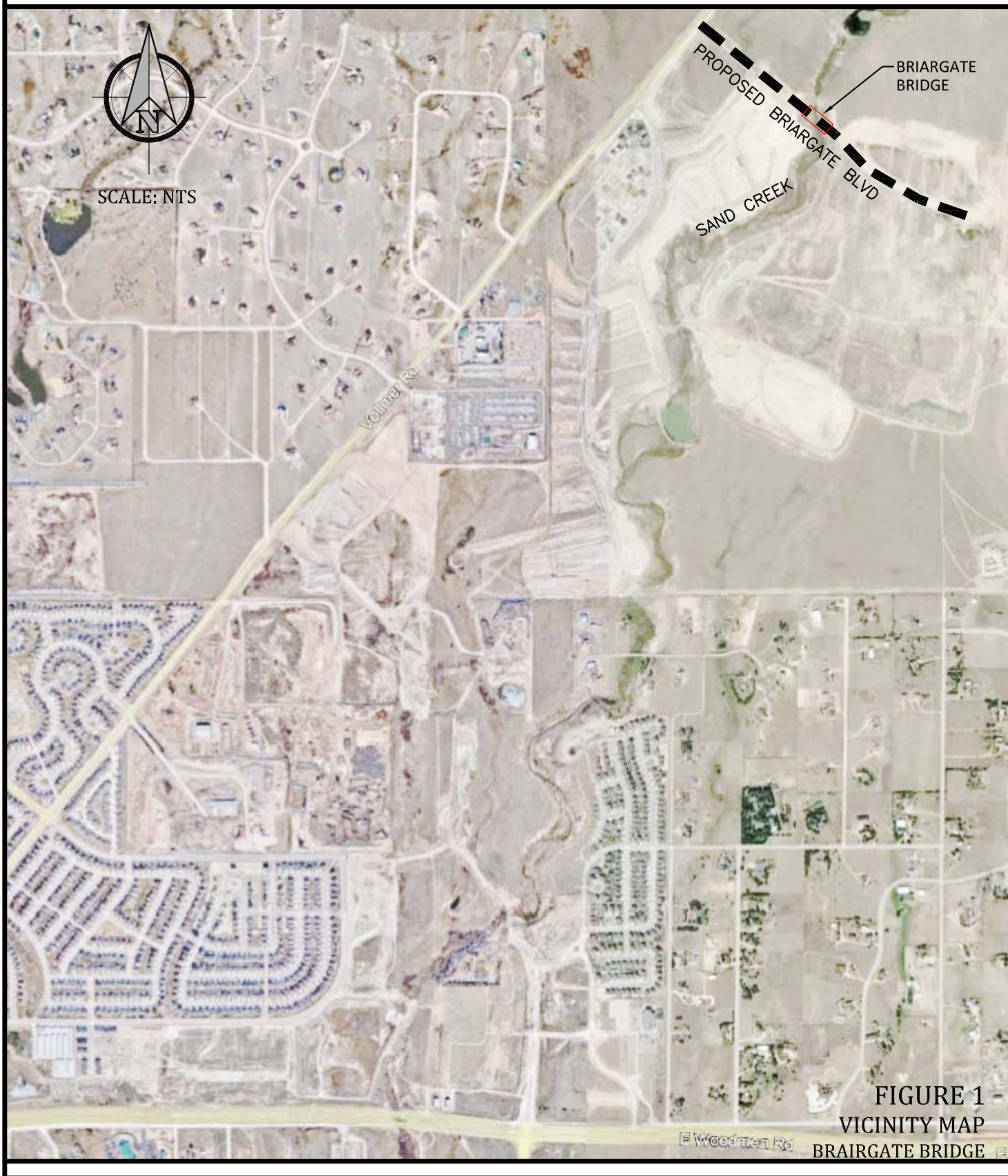

FIGURE 1
VICINITY MAP
BRAIRGATE BRIDGE

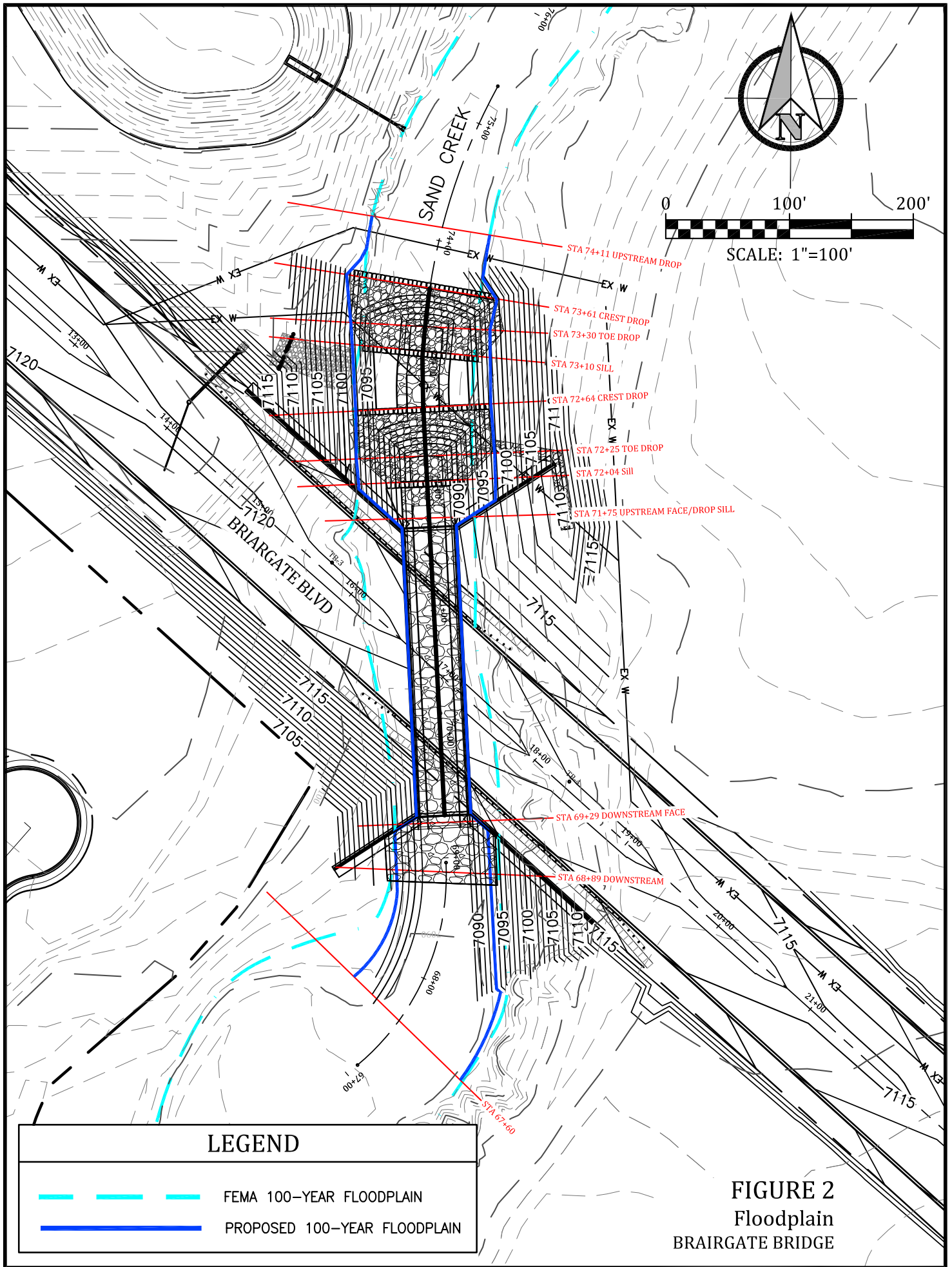

FIGURE 2
Floodplain
BRAIRGATE BRIDGE

8.1 Riprap Sizing

Procedures for sizing rock to be used in soil riprap, void-filled riprap, and riprap over bedding are the same.

8.1.1 Mild Slope Conditions

When subcritical flow conditions occur and/or slopes are mild (less than 2 percent), UDFCD recommends the following equation (Hughes, et al, 1983):

$$d_{50} \geq \left[\frac{VS^{0.17}}{4.5(G_s - 1)^{0.66}} \right]^2 \quad \text{Equation 8-11}$$

Where:

V = mean channel velocity (ft/sec)

S = longitudinal channel slope (ft/ft)

d_{50} = mean rock size (ft)

G_s = specific gravity of stone (minimum = 2.50, typically 2.5 to 2.7), Note: In this equation ($G_s - 1$) considers the buoyancy of the water, in that the specific gravity of water is subtracted from the specific gravity of the rock.

Note that Equation 8-11 is applicable for sizing riprap for channel lining with a longitudinal slope of no more than 2%. This equation is not intended for use in sizing riprap for steep slopes (typically in excess of 2 percent), rundowns, or protection downstream of culverts. Information on rundowns is provided in Section 7.0 of the *Hydraulic Structures* chapter of the USDCM, and protection downstream of culverts is discussed in the *Culverts and Bridges* chapter. For channel slopes greater than 2% use one of the methods presented in 8.1.2.

Rock size does not need to be increased for steeper channel side slopes, provided the side slopes are no steeper than 2.5H:1V (UDFCD 1982). Channel side slopes steeper than 2.5H:1V are not recommended because of stability, safety, and maintenance considerations. See Figure 8-34 for riprap placement specifications. At the upstream and downstream termination of a riprap lining, the thickness should be increased 50% for at least 3 feet to prevent undercutting.

8.1.2 Steep Slope Conditions

Steep slope rock sizing equations are used for applications where the slope is greater than 2 percent and/or flows are in the supercritical flow regime. The following rock sizing equations may be referred to for riprap design analysis on steep slopes:

- CSU Equation, *Development of Riprap Design Criteria by Riprap Testing in Flumes: Phase II* (prepared by S.R. Abt, et al, Colorado State University, 1988). This method was developed for steep slopes from 2 to 20 percent.
- USDA- Agricultural Research Service Equations, *Design of Rock Chutes* (by K.M. Robinson, et al, USDA- ARS, 1998 Transactions of ASAE) and *An Excel Program to Design Rock Chutes for Grade*

Riprap Sizing at Briargate Bridge

per UDFCD Eq. 8-11

From HECRAS! 100yr velocities

S = 0.2%

Velocities:

5.36 ft/s

upstream approach

12.0 ft/s

outlet

10.4 ft/s

departure

$$d_{50} \geq \left[\frac{V^{1.7}}{4.5(G_s - 1)^{0.66}} \right]^2$$

V = mean channel velocity

S = longitudinal slope (ft/ft)

d₅₀ = mean rock size (ft)

G_s = specific gravity of stone (2.5 to 2.7)

$$\frac{12.0 (.002)^{.17}}{4.5(2.5-1)^{0.66}}$$

= 1.0

$$\boxed{(12" D_{50})}$$

DESIGN OF ROADSIDE CHANNELS WITH FLEXIBLE LININGS

Hydraulic Engineering Circular No. 15

Prepared By

Simons, Li & Associates, Inc.
3555 Stanford Road
P.O. Box 1816
Fort Collins, Colorado 80522

For

U.S. Department of Transportation
Federal Highway Administration

October 25, 1985

Table 4.1. Permissible Shear Stresses for Lining Materials.

Lining Category	Lining Type	Permissible Unit Shear Stress (lb/ft ²)
Temporary	Woven Paper Net	0.15
	Jute Net	0.45
	Fiberglass Roving*	0.75
	Straw and Erosion Net	1.45
	Curled Wood Mat (TRM)	1.55
	Nylon Mat	2.00
Vegetative	Class A	3.70
	Class B	2.10
	Class C	1.00
	Class D	0.60
	Class E	0.35
Gravel Riprap	1-inch	0.40
	2-inch	0.80
Rock Riprap	6-inch	2.50
	12-inch	5.00

* single and double applications

TABLE 3.1.--Classification of vegetal covers as to degree of retardance (6)

Note: Covers classified have been tested in experimental channels.
Covers were green and generally uniform.

Retardance	Cover	Condition
A	Weeping lovegrass	Excellent stand, tall, (average 30")
	Yellow bluestem <i>Ischaemum</i> ..	Excellent stand, tall, (average 36")
B	Kudzu	Very dense growth, uncut
	Bermudagrass	Good stand, tall (average 12")
	Native grass mixture (little bluestem, blue grama, and other long and short mid-west grasses)	Good stand, unmowed
	Weeping lovegrass	Good stand, tall, (average 24")
	<i>Lespedeza sericea</i>	Good stand, not woody, tall (average 19")
	Alfalfa	Good stand, uncut, (average 11")
	Weeping lovegrass	Good stand, mowed, (average 13")
	Kudzu	Dense growth, uncut
C	Blue grama	Good stand, uncut, (average 13")
	Crabgrass	Fair stand, uncut (10 to 48")
	Bermudagrass	Good stand, mowed (average 6")
	Common lespedeza	Good stand, uncut (average 11")
	Grass-legume mixture--summer (orchard grass, redtop, Italian ryegrass, and common lespedeza)	Good stand, uncut (6 to 8 inches)
	Centipedegrass	Very dense cover (average 6 inches)
	Kentucky bluegrass	Good stand, headed (6 to 12 inches)
D	Bermudagrass	Good stand, cut to 2.5-inch height
	Common lespedeza	Excellent stand, uncut (average 4.5")
	Buffalograss	Good stand, uncut (3 to 6 inches)
	Grass-legume mixture--fall, spring (Orchardgrass, redtop, Italian ryegrass, and common lespedeza)	Good stand, uncut (4 to 5 inches)
	<i>Lespedeza sericea</i>	After cutting to 2-inch height. Very good stand before cutting.
E	Bermudagrass	Good stand, cut to 1.5 inches height
	Bermudagrass	Burned stubble.

2021 Sand Creek at Briargate Pkwy Plan: 1) Proposed Floodway 8/29/2021 2) CE Floodway 8/29/2021

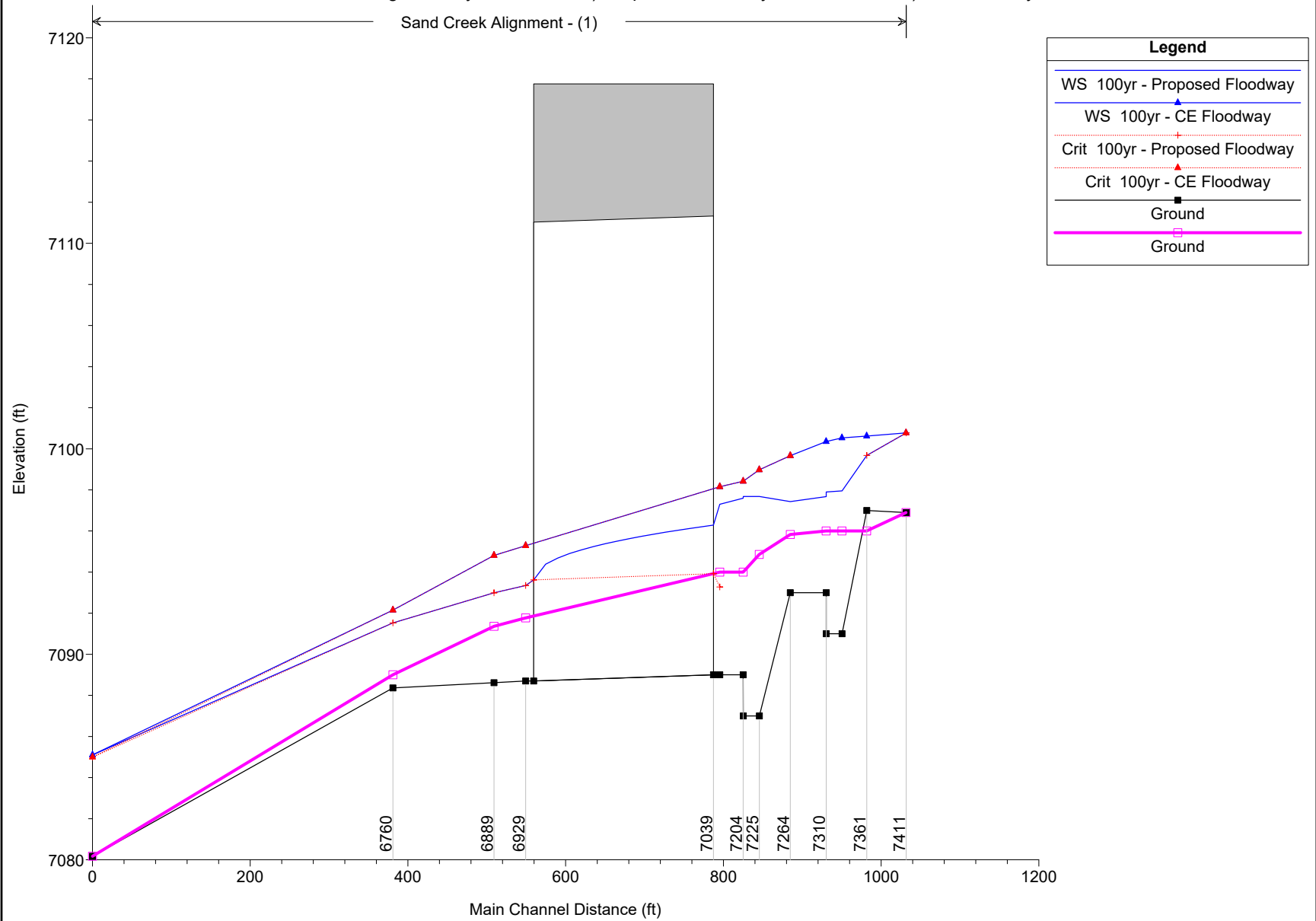

HEC-RAS Plan: Proposed Floodway River: Sand Creek Reach: Briargate Only Profile: 100yr

Reach	River Sta	Profile	Q Total	Min Ch El	W.S. Elev	Crit W.S.	E.G. Elev	E.G. Slope	Vel Chnl	Flow Area	Top Width	Froude # Chl
			(cfs)	(ft)	(ft)	(ft)	(ft)	(ft/ft)	(ft/s)	(sq ft)	(ft)	
Briargate Only	7411	100yr	2600.00	7096.90	7100.77	7100.77	7102.29	0.006934	9.95	271.39	94.46	0.98
Briargate Only	7361	100yr	2600.00	7097.00	7099.68	7099.68	7100.91	0.017318	8.92	292.17	120.38	1.00
Briargate Only	7330	100yr	2600.00	7091.00	7097.96		7098.36	0.002520	5.07	512.43	112.64	0.42
Briargate Only	7311	100yr	2600.00	7091.00	7097.90		7098.31	0.002238	5.16	512.93	113.74	0.40
Briargate Only	7310	100yr	2600.00	7093.00	7097.67		7098.29	0.004384	6.32	417.88	111.89	0.55
Briargate Only	7264	100yr	2600.00	7093.00	7097.43		7098.07	0.005030	6.41	406.42	109.33	0.58
Briargate Only	7225	100yr	2600.00	7087.00	7097.68		7097.88	0.000672	3.59	736.21	111.84	0.23
Briargate Only	7205	100yr	2600.00	7087.00	7097.68		7097.86	0.000709	3.45	754.43	111.05	0.23
Briargate Only	7204	100yr	2600.00	7089.00	7097.60		7097.84	0.001077	3.97	655.17	110.37	0.29
Briargate Only	7175	100yr	2600.00	7089.00	7097.30	7093.27	7097.75	0.001695	5.36	485.53	62.00	0.34
Briargate Only	7039		Culvert									
Briargate Only	6929	100yr	2600.00	7088.70	7093.35	7093.35	7095.58	0.006400	11.99	216.92	57.00	0.99
Briargate Only	6889	100yr	2600.00	7088.62	7092.99	7092.99	7094.66	0.007309	10.36	250.93	75.74	1.00
Briargate Only	6760	100yr	2600.00	7088.36	7091.53	7091.53	7092.88	0.007224	9.33	284.07	119.86	0.97
Briargate Only	6379	100yr	2600.00	7080.17	7085.10	7085.00	7085.90	0.007296	7.21	365.05	200.02	0.92

2021 Sand Creek at Briargate Pkwy Plan: Proposed Floodway 8/29/2021

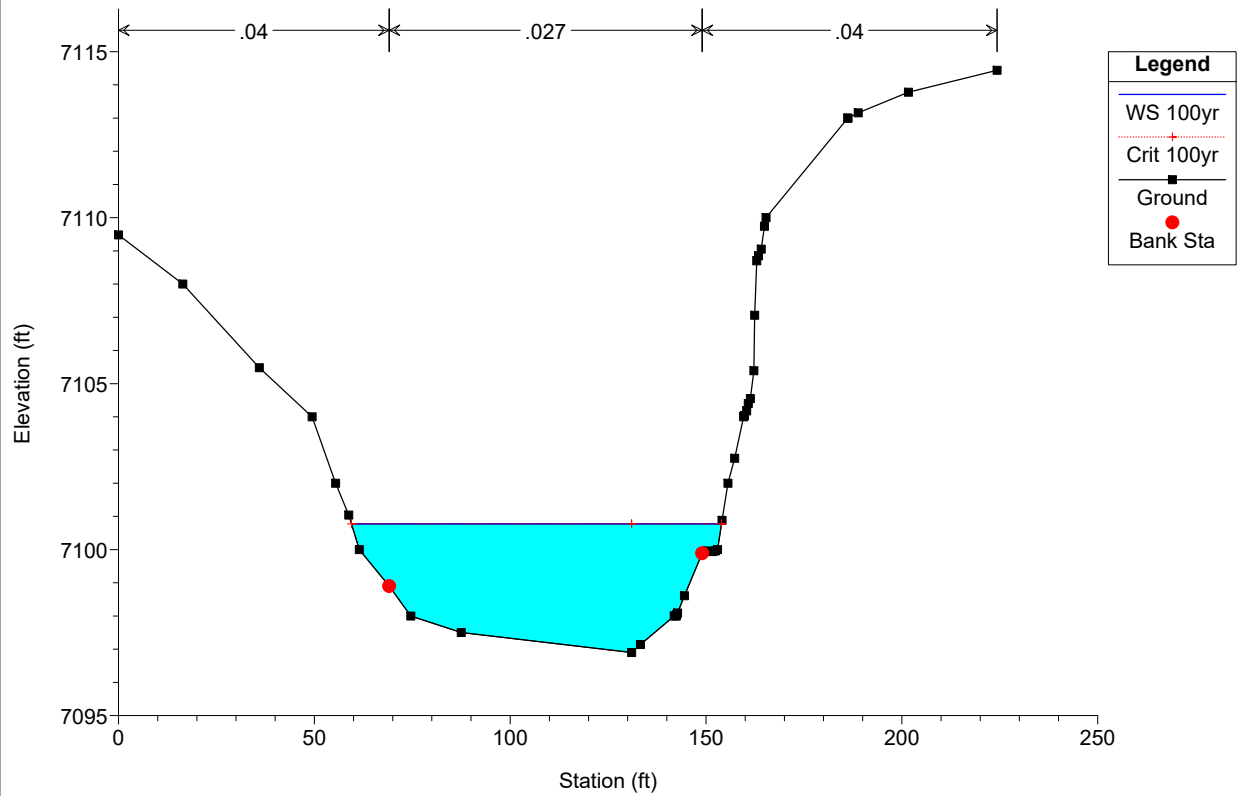

2021 Sand Creek at Briargate Pkwy Plan: Proposed Floodway 8/29/2021
Drop Crest

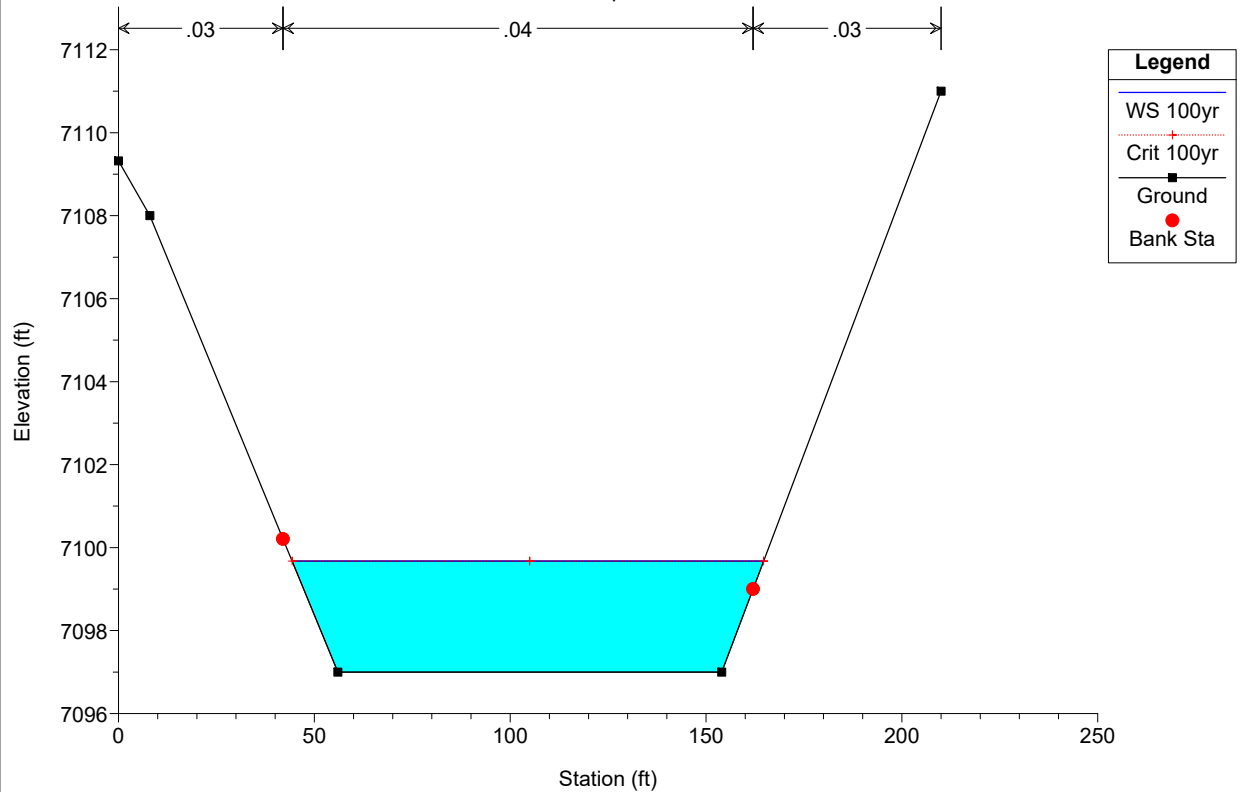

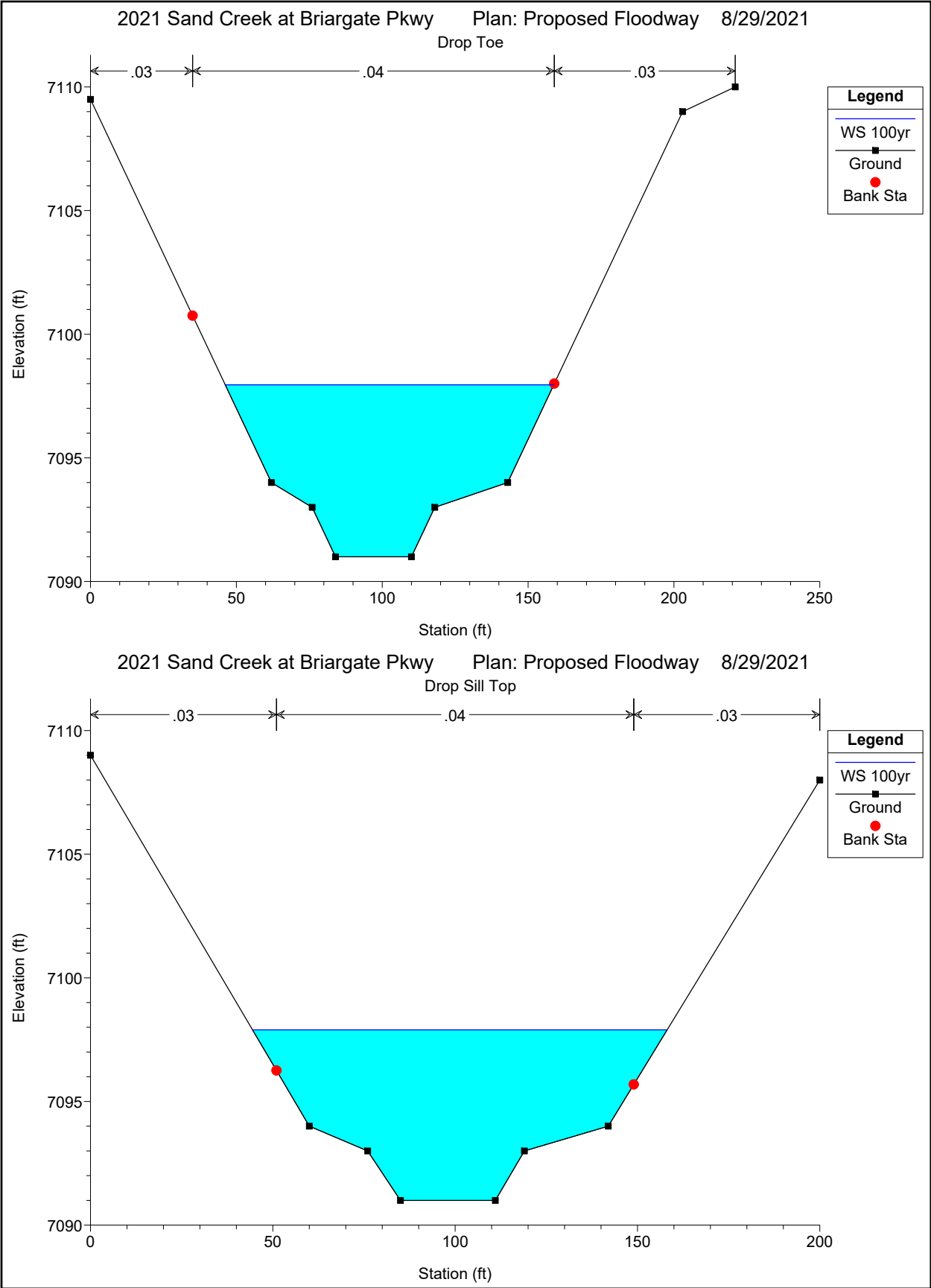

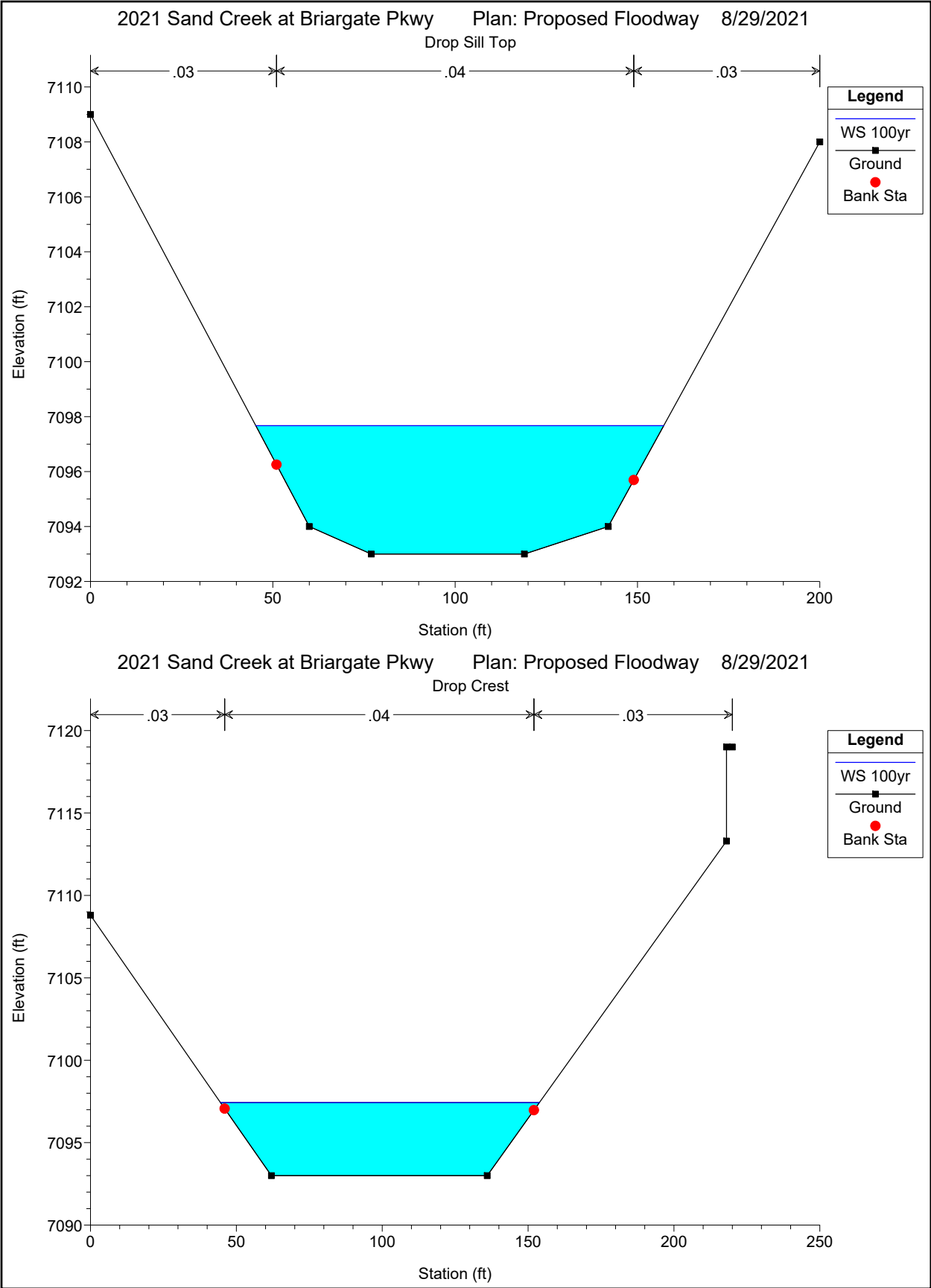

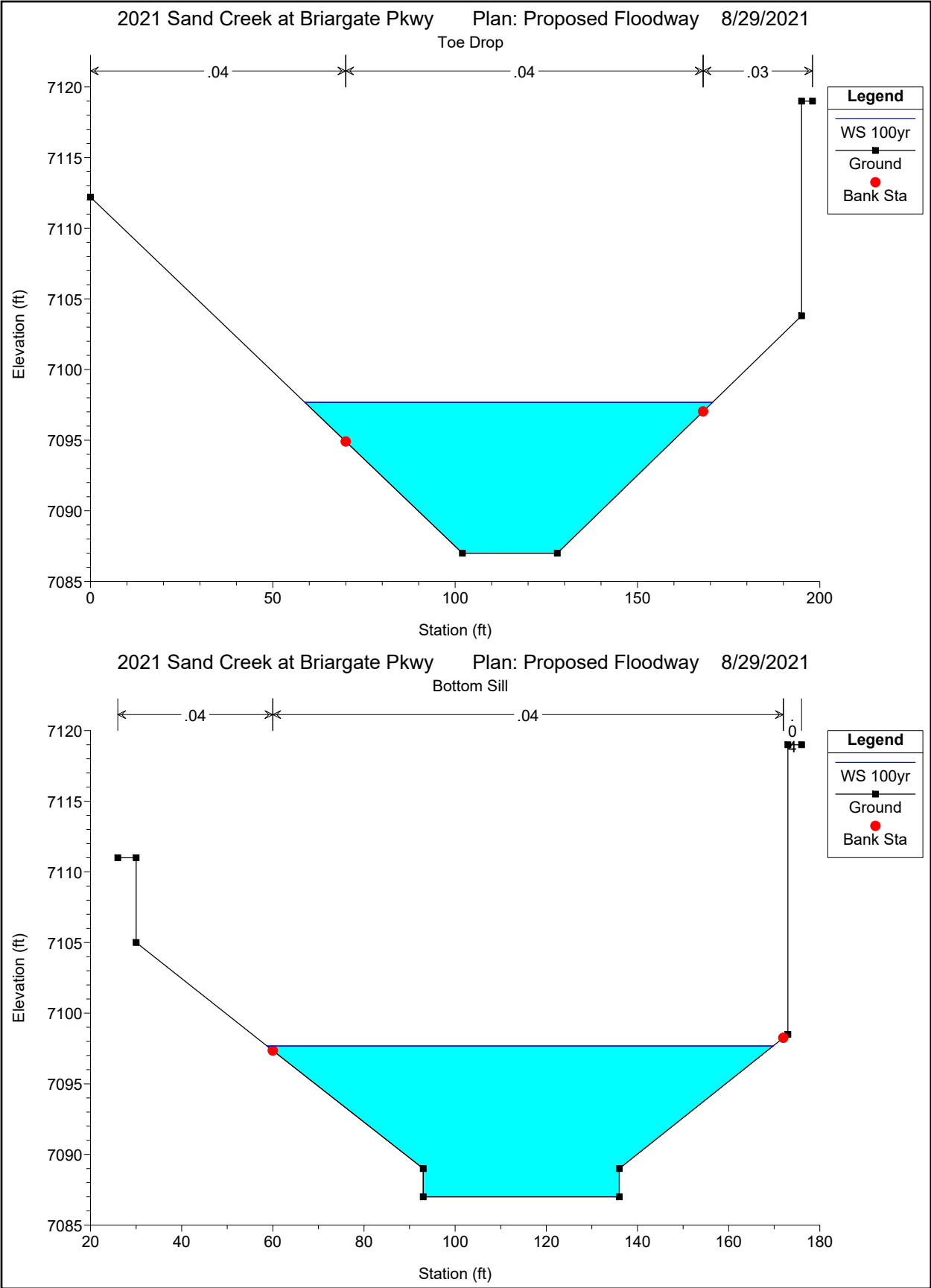

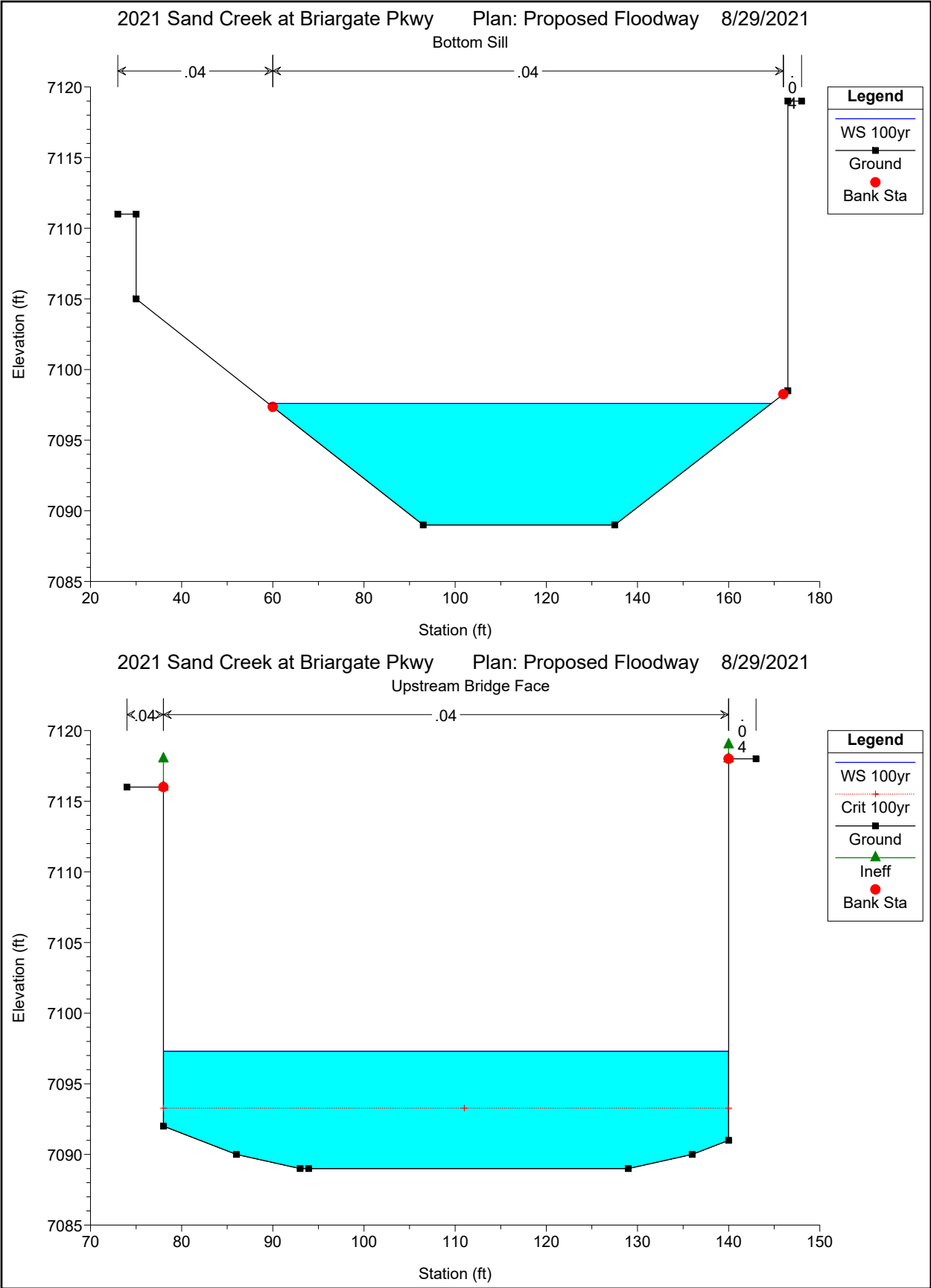

2021 Sand Creek at Briargate Pkwy Plan: Proposed Floodway 8/29/2021
Briargate Parkway

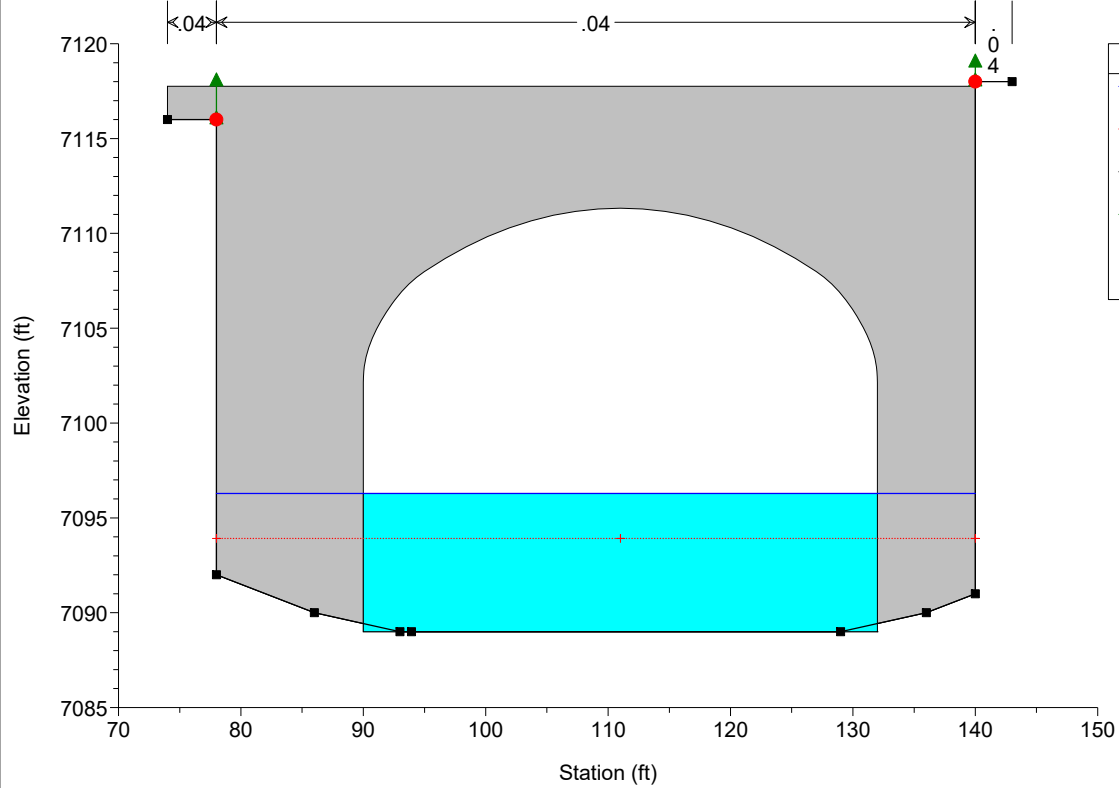

2021 Sand Creek at Briargate Pkwy Plan: Proposed Floodway 8/29/2021
Briargate Parkway

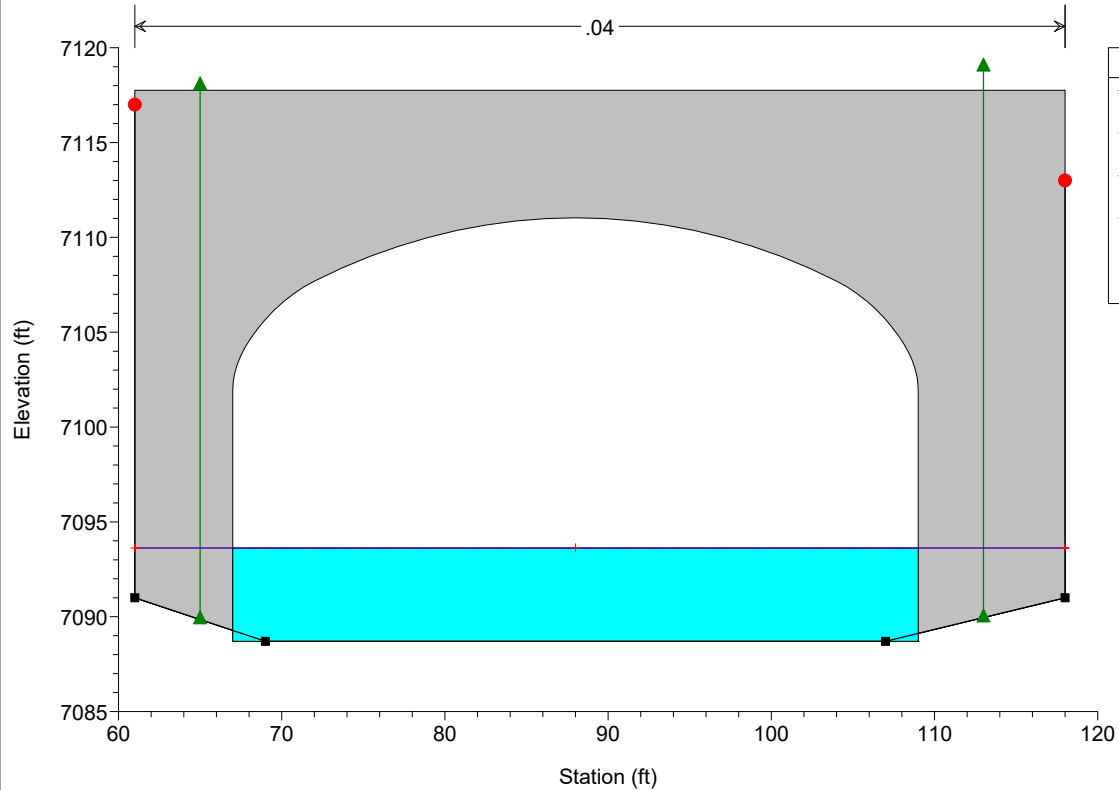

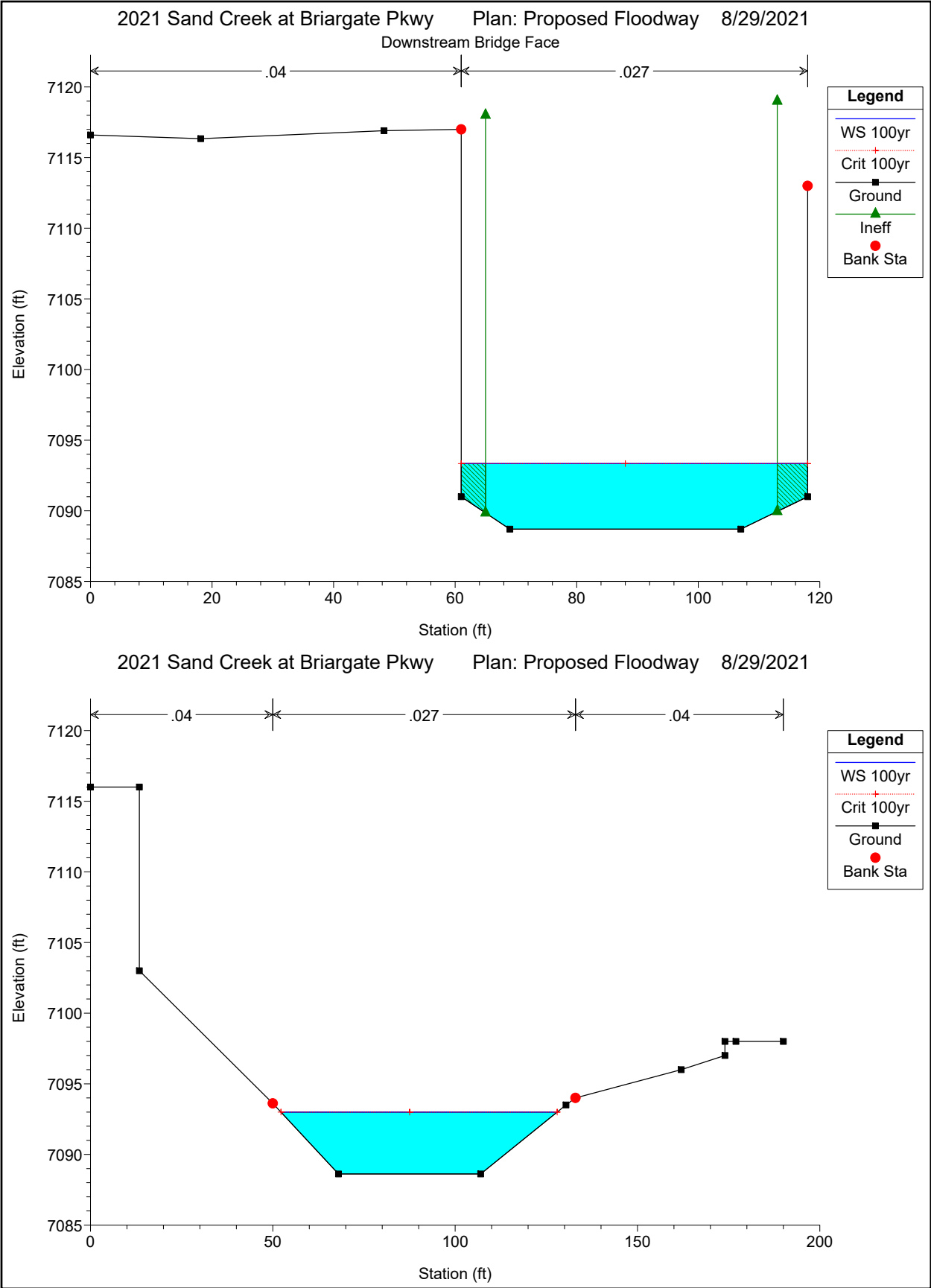

2021 Sand Creek at Briargate Pkwy Plan: Proposed Floodway 8/29/2021

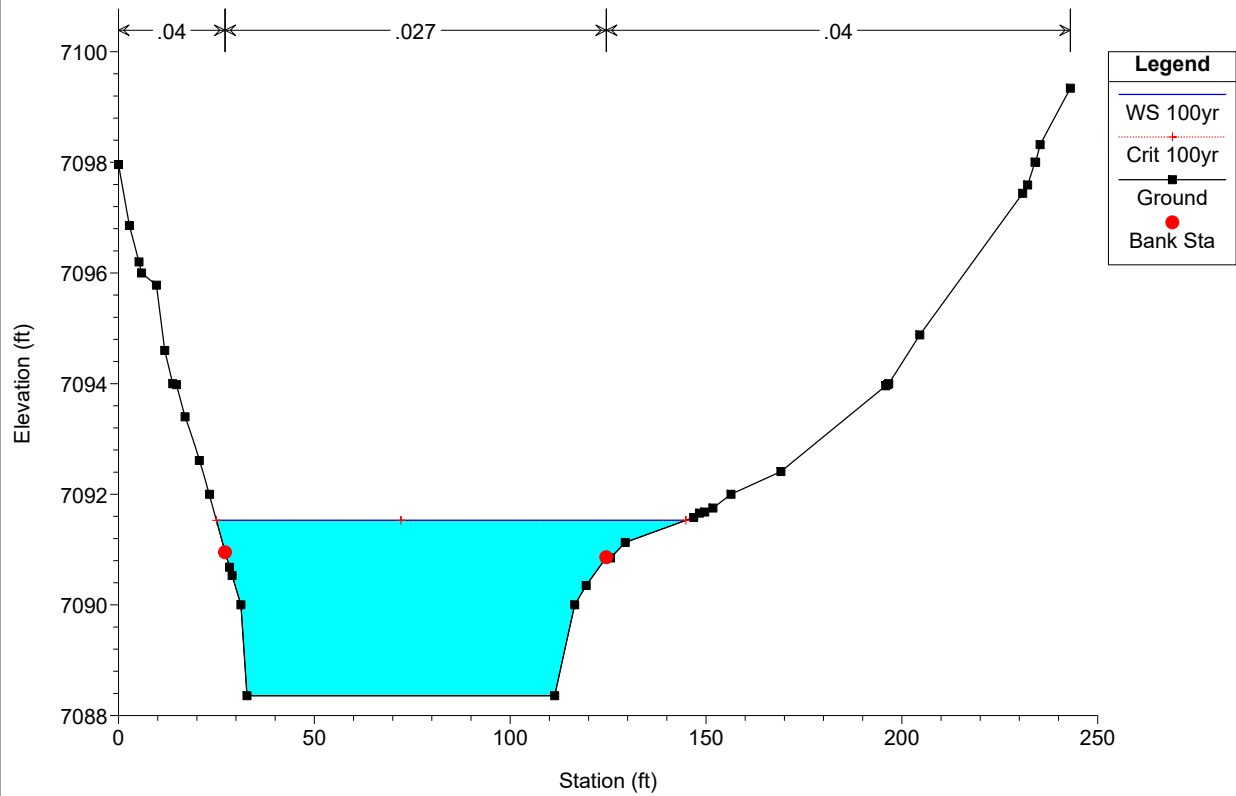

2021 Sand Creek at Briargate Pkwy Plan: Proposed Floodway 8/29/2021

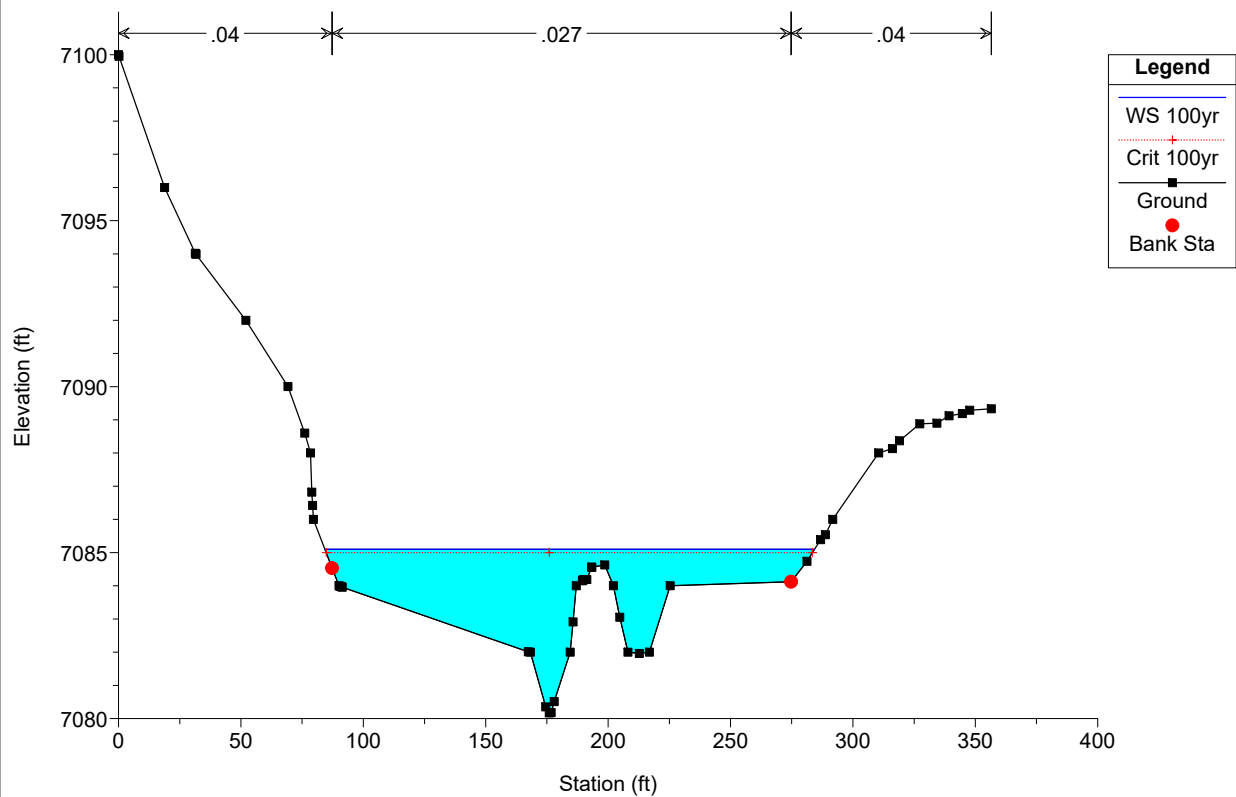

Appendix B

Sterling Ranch Road and Briargate Parkway Bridges Geotechnical Report



ENTECH
ENGINEERING, INC.

505 ELKTON DRIVE
COLORADO SPRINGS, CO 80907
PHONE (719) 531-5599
FAX (719) 531-5238

**SUBSURFACE SOIL INVESTIGATION
BRIARGATE BOULEVARD OVER SAND CREEK
EL PASO COUNTY, COLORADO**

Prepared for:

**C&C Land
20 Boulder Crescent, 2nd Floor
Colorado Springs, Colorado 80903**

Attn: Chaz Collins

July 29, 2021

Respectfully Submitted,
ENTECH ENGINEERING, INC.

Daniel P. Stegman

Reviewed by:

Austin M. Nossokoff, P.E.



AMN/amn

Encl.

Entech Job No. 211647

F:\AA projects\2021\211647-C&C Land-Briargate at Sand Creek-200-SSI\211647 ssi.doc

Table of Contents

1.0 INTRODUCTION.....	1
2.0 PROJECT AND SITE DESCRIPTION	2
3.0 SUBSURFACE EXPLORATIONS AND LABORATORY TESTING	2
4.0 SUBSURFACE CONDITIONS	3
4.1 Soil and Rock	3
4.2 Groundwater	5
5.0 GEOTECHNICAL EVALUATION AND RECOMMENDATIONS.....	5
5.1 Foundation Recommendations.....	6
5.1.1 Deep Foundation Systems (Driven H-piles).....	6
5.1.2 Shallow Foundation Parameters.....	7
5.1.3 Retaining Wall Parameters	8
5.2 Site Seismic Classification	8
5.3 Surface and Subsurface Drainage.....	9
5.4 Concrete	9
5.5 Foundation Excavation Observations	9
5.6 Structural Fill.....	10
5.7 Utility Trench Backfill	11
5.8 General Backfill	11
5.9 Excavation Stability.....	12
5.10 Winter Construction	12
5.11 Construction Observations	12
6.0 CLOSURE.....	13

Tables

Table 1 Summary of Laboratory Test Results

Table 2 Briargate Blvd over Sand Creek – LPile Design Parameters

Figures

Figure 1: Vicinity Map

Figure 2: Site Plan/Test Boring Map

List of Appendices

Appendix A Laboratory Testing Results

**SUBSURFACE SOIL INVESTIGATION
BRIARGATE BOULEVARD OVER SAND CREEK
EL PASO COUNTY, COLORADO**

1.0 INTRODUCTION

C&C Land is planning the construction of a vehicular bridge over sand creek for the proposed Briargate Boulevard in El Paso County northeast of Colorado Springs, Colorado. The approximate location of the site is shown on the Vicinity Map, Figure 1. The planned layout of the proposed bridge is shown on Figure 2, the Site Plan/Test Boring Map.

This report describes the subsurface investigation conducted for the planned bridge and provides recommendations for foundation design and construction. The subsurface soil investigation included drilling test borings at two (2) locations within the footprints of the planned bridge foundations, collecting samples of soil, and conducting a geotechnical evaluation of the investigation findings. All drilling and subsurface investigation activities were performed by Entech Engineering, Inc. (Entech). The contents of this report, including the geotechnical evaluation and recommendations, are subject to the limitations and assumptions presented in Section 6.0.

2.0 PROJECT AND SITE DESCRIPTION

It is Entech's understanding that the project will consist of the construction of a vehicular bridge spanning Sand Creek with driven H-pile foundations and associated site improvements. At the time of drilling, the site for the proposed bridge was vacant. The crossing for the proposed Briargate Boulevard had been graded at the time of drilling. Sand Creek flows to the south. Current vegetation on the site consisted of grasses and small shrubs.

3.0 SUBSURFACE EXPLORATIONS AND LABORATORY TESTING

The subsurface conditions were investigated by drilling two (2) exploratory test borings, one at each bridge abutment. The borings were drilled to depths 20 feet below the existing ground surface using a truck-mounted continuous flight auger-drilling rig supplied and operated by Entech Engineering, Inc. Boring Logs descriptive of the subsurface conditions encountered during drilling and subsequent to drilling are presented in Appendix A. At the conclusion of drilling, observations of groundwater levels were made in each of the open borings. The approximate locations of the test borings are indicated on Figure 2.

Soil samples were obtained from the borings utilizing the Standard Penetration Test (ASTM D-1586) using a California Sampler. Results of the Standard Penetration Test (SPT) are included on the Test Boring Logs in terms of N-values expressed in blows per foot (bpf). Soil samples recovered from the borings were visually classified and recorded on the Test Boring Logs. The soil classifications were later verified utilizing laboratory testing and grouped by soil type. The soil type numbers are included on the Test Boring Logs. It should be understood that the soil descriptions shown on the Test Boring Logs may vary between boring location and sample depth.

It should also be noted that the lines of stratigraphic separation shown on the Test Boring Logs represent approximate boundaries between soil types and the actual stratigraphic transitions may be more gradual and vary with location. The Test Boring Logs are presented in Appendix A.

Moisture Content, ASTM D-2216, was obtained in the laboratory for all recovered samples. Grain-Size, ASTM D-422, and Atterberg Limits, ASTM D-4318, were determined for various samples for the purpose of classification and to obtain pertinent engineering characteristics. Volume change testing was performed on selected samples using the Swell/Consolidation Test (ASTM D-4546) in order to evaluate potential expansion/consolidation characteristics of the soil and bedrock. Sulfate testing was performed on select samples to determine the corrosive characteristics of the soils. The Laboratory Test Results are included in Appendix B and summarized in Table 1.

4.0 SUBSURFACE CONDITIONS

One (1) soil type and two (2) bedrock types were encountered in the borings drilled for the subsurface investigation: Type 1: slightly silty to silty sand (SM-SW), Type 2: slightly silty sandstone (SM-SW), and Type 3: sandy siltstone (ML). The soils were classified in accordance with the Unified Soil Classification System (USCS) using the laboratory testing results and the observations made during drilling.

4.1 Soil and Rock

Soil Type 1 is a slightly silty to silty sand (SM-SW). The sand was encountered in both of the test borings at the existing ground surface extending to depths of 4 to 5 feet. Standard Penetration Testing conducted on the sand resulted in an SPT N-value of 47 blows per foot (bpf), which indicates dense states. Moisture content and grain size testing resulted in a moisture content of 17 percent with approximately 8 percent of the soil size particles passing the No. 200 sieve. Atterberg limit testing was performed on a sample of sand and resulted in a liquid limit of no value with a plastic index of non-plastic. Sulfate tests performed on a sample of

the sand resulted in less than 0.01 percent sulfate by weight, indicating the sand exhibits negligible potential for concrete degradation due to below grade sulfate attack.

Soil Type 2 is a slightly silty sandstone bedrock (SM). The sandstone was encountered in both of the test borings at depths ranging from 4 to 5 feet bgs and extending to depths of 9 to 14 feet and again at depths ranging from 16 to 19 feet bgs and extending to the termination of the borings (20 feet). Standard Penetration Testing conducted on the sandstone resulted in N-values of 50 to greater than 50 blows per foot (bpf), indicating the sandstone is dense to very dense in terms of density. Moisture content and grain size testing resulted in moisture contents of 11 to 16 percent with approximately 8 percent of the soil size particles passing the No. 200 sieve. Atterberg limit testing was performed on a sample of sand and resulted in a liquid limit of no value with a plastic index of non-plastic. Sulfate tests performed on a sample of the sandstone resulted in 0.00 percent sulfate by weight, indicating the sandstone exhibits negligible potential for concrete degradation due to below grade sulfate attack.

Soil Type 3 is a sandy siltstone bedrock (ML). The siltstone was encountered in both of the test borings at depths of 9 to 14 feet bgs and extending to depths of 16 to 19 feet bgs. Standard Penetration Testing conducted on the soil resulted in N-values of greater than 50 blows per foot (bpf), indicating the soil is hard in terms of consistency. Moisture content and grain size testing resulted in moisture contents of 14 to 17 percent with approximately 70 percent of the soil size particles passing the No. 200 sieve. Atterberg limit testing resulted in a liquid limit of 36 and a plastic index of 8. Swell/Consolidation Testing resulted in a volume change of 3.7 percent, indicating the siltstone exhibits a high expansion potential. Sulfate tests performed on a sample of the siltstone resulted in 0.00 percent sulfate by weight, indicating the siltstone exhibits negligible potential for concrete degradation due to below grade sulfate attack.

Additional descriptions and engineering properties of the soil encountered during drilling are included on the boring logs. Laboratory Testing Results are summarized on Table 1 and presented in Appendix B. It should be understood that the soil descriptions reported on the boring logs may vary between boring locations and sampling depths. Similarly, the lines of stratigraphic separation shown on the boring logs represent approximate boundaries between soil types and the actual transitions between types may be more gradual or variable.

4.2 Groundwater

Groundwater was encountered at depths ranging from 1-1/2 to 3-1/2 feet in the test borings drilled on this site. Groundwater will affect development of significant foundation excavations or during installation of deep utilities depending on the final grading plans. Creek flow will vary due to rainfall, drainage, and other factors not readily apparent at this time. Unstable conditions may be encountered where excavations approach the groundwater level. Stabilization using shot rock or geogrids may be necessary. It should be noted that groundwater levels, observed at the time of the subsurface investigation, could change due to seasonal variations, changes in land runoff characteristics and future development including of nearby areas.

5.0 GEOTECHNICAL EVALUATION AND RECOMMENDATIONS

The following discussion is based on the subsurface conditions encountered in the borings drilled in the planned bridge footprint. If subsurface conditions different from those described herein are encountered during construction or if the project elements change from those described, Entech Engineering, Inc. should be notified so that the evaluation and recommendations presented can be reviewed and revised if necessary.

The site will be developed by constructing a bridge over Sand Creek and associated site improvements at the Briargate Boulevard Crossing. The proposed bridge is expected to utilize a driven H-pile foundation.

Subsurface soil conditions encountered in the test borings drilled for the planned interchanges consisted of slightly silty to silty sand overlying interbedded slightly silty sandstone and sandy siltstone. Bedrock was encountered at depths of 4 to 5 feet in the test borings. The surficial sands and were encountered in dense states. The underlying sandstone was encountered in dense to very dense states, and the underlying siltsone was encountered at hard consistencies.

5.1 Foundation Recommendations

The main purpose of the subsurface investigation was to gather soil and bedrock information for the proposed bridge abutments for use in providing foundation recommendations and design values. Recommendations for bridge supports using driven H-piles, shallow spread footings, and parameters for retaining walls are provided.

5.1.1 Deep Foundation Systems (Driven H-piles)

Based on evaluation of the site subsurface conditions, it is believed that the planned H-piles will achieve most of their compressive strength through end bearing and skin friction in the underlying sandstone and siltstone bedrock (Soil Types 2 and 3). Some frictional resistance will also be developed in the overburden sand (Soil Type 1). Design parameters for use in the H-pile design, which include allowable end bearing, side resistance, and resisting factors are presented in Table 2. L Pile parameters for the sand, sandstone, and siltstone are also included in Table 2. The recommendations and parameters apply to piles spaced by horizontal distances of at least 3 times the pile width. If the piles are spaced closer, reductions in the allowable pile capacity may be warranted. The following unit weights are recommended for the site soil and bedrock.

Unit weight of native overburden sand	120 pcf
Unit weight of sandstone bedrock	125 pcf
Unit weight of siltstone bedrock	125 pcf

It is recommended that full-time observation of the H-pile installation be performed to compile driving logs for each pile. At a minimum, the log should include: the driving resistance per foot of pile and per inch of pile over the last 3 inches; the pile driver make and model; rated energy; pile cushion/condition; observed damage; and final pile top location. The guidance set forth in the State of Colorado Standard Specifications for Road and Bridge Construction, Section 502, Piling, is recommended. Piles should be driven 10 feet into bedrock or refusal.

5.1.2 Shallow Foundation Parameters

Structures associated with the bridges can be supported with shallow foundations resting on the native sands, recompacted loose sands, or sandstone. It should be noted that due to potential shallow groundwater on this site (due to the proximity to Sand Creek), extensive subgrade improvements are anticipated to support shallow foundations. The foundation members should bear on the native site sands, sandstone, or be recompacted according to the "Structural Fill" paragraph. Any topsoil must be removed and the existing subgrade cleared of any debris prior to excavation. Loose soils or uncontrolled fill material beneath foundation components will require removal and recompaction. Any expansive soils encountered beneath the foundation will require removal and replacement with non-expansive structural fill compacted according to the "Structural Fill" paragraph. Any new fill should be placed to the requirements of the "Structural Fill" paragraph. On-site granular sands may be used as structural fill as approved by Entech. Any import material should be approved by Entech prior to hauling to the site.

Provided the above recommendations are followed, an allowable bearing pressure of 2400 psf is recommended for the native sands. For recompacted sands or imported granular structural fill, an allowable bearing capacity of 3000 psf is recommended. An allowable bearing capacity of 3500 psf is recommended for undisturbed sandstone. Footings should extend a minimum of 30 inches below the adjacent exterior surface grade for frost protection. Following the above foundation subgrade preparation recommendations, and adhering to the recommended maximum allowable bearing pressure, it is expected to result in foundation designs which should limit total and differential vertical movements.

Foundation excavations are recommended to extend at least 3 feet horizontally beyond the foundation limits in order to provide adequate space for installation of drain materials (if necessary) and placement of controlled fill. All foundation excavation side slopes should be inclined at angles of 1 $\frac{1}{2}$ horizontal to 1 vertical or flatter, as necessary, to provide for excavation sidewall stability during construction or as required by OSHA regulations.

Entech should observe overexcavated subgrades as well as the overall foundation excavation subgrade and evaluate if the exposed conditions are consistent with those described in this

report. Entech should also provide recommendations for overexcavation depth and other subgrade improvements, if necessary, and the need for drain systems based on the excavation conditions observed at that time.

5.1.3 Retaining Wall Parameters

The following values are recommended for use in designing retaining walls with unbalanced lateral loading that may be associated with this project. Roadway/Vehicle surcharge loading is required for wall design.

Recommended Design Values – Lateral Loading

Equivalent fluid density for lateral earth pressure (active), pcf (site granular soils)	45
Equivalent fluid density for lateral earth pressure (passive), pcf	300
Equivalent fluid density for lateral earth pressure (at rest), pcf	60
Soil density (compacted sand), pcf	125
Angle of Internal Friction (loose silty sand)	26°
Angle of Internal Friction (compacted silty sand)	34°
Coefficient of sliding between concrete and silty gravelly sand	0.35
Bearing capacity of sand, psf	2400 psf
Bearing capacity of sandstone, psf	3500 psf

*Note: The above lateral loading design values are for level back slope angles and no surcharge loads. If wall backfill is submerged, water pressures must be taken into account as additional wall loading. If backfill slope angles are greater than zero degrees, or if the backfill is surcharged, the design values must be adjusted to account for additional lateral loading.

5.2 Site Seismic Classification

Based on the subsurface conditions encountered at the site and in accordance with Section 1613 of the 2015 International Building Code (IBC), the site meets the conditions of a Site Class C.

5.3 Surface and Subsurface Drainage

Positive surface drainage must be maintained around structures to minimize infiltration of surface water. A minimum gradient of 5 percent in the first 10 feet adjacent to foundation components is recommended. A minimum gradient of 2 percent is recommended for paved areas. All grades should be directed away from structures.

5.4 Concrete

Soluble sulfate testing was conducted on three samples of the site soils to evaluate the potential for sulfate attack on concrete placed below the surface grade. The test results indicated 0.00 to less than 0.01 percent soluble sulfate by weight for the site soils. The test results indicate the sulfate component of the in-place site soils present a negligible exposure threat to concrete placed below grade that comes into contact with the site soils.

Type II cement is recommended for concrete at this site. To further avoid concrete degradation during construction it is recommended that concrete not be placed on frozen or wet ground. Care should be taken to prevent the accumulation or ponding of water in foundation excavations prior to the placement of concrete. If standing water is present in the foundation excavations, it should be removed by ditching to sumps and pumping the water away from the foundation area prior to concrete placement. If concrete is placed during periods of cold temperatures, the concrete must be kept from freezing. This may require covering the concrete with insulated blankets and adding heat to prohibit freezing.

5.5 Foundation Excavation Observations

Subgrade preparation for bridge foundations and associated improvements should be observed by Entech Engineering prior to construction of the foundation elements in order to verify that (1) no anomalies are present, (2) materials of the proper bearing capacity have been encountered or placed, and (3) no soft, loose, uncontrolled fill material, expansive soil or debris are present in the foundation area prior to concrete placement or backfilling. Pile driving should be observed to verify proper embedment or refusal. Piles should be driven 10 feet into bedrock or refusal.

Entech should make final recommendations for over-excavation or stabilization, if required, at the time of excavation observation, if necessary.

5.6 Structural Fill

Areas to receive fill should have all topsoil, organic material or debris removed. Fill must be properly benched. The surface should be scarified and moisture conditioned to within ± 2 percent of its optimum moisture content and compacted to 95 percent of its maximum Modified Proctor Dry Density (ASTM D-1557) beneath footings or floor slabs prior to placing new fill. New fill beneath footings should be non-expansive and be placed in thin lifts not to exceed 6 inches after compaction while maintaining at least 95 percent of its maximum Modified Proctor Dry Density (ASTM D-1557). These materials should be placed at a moisture content conducive to compaction, usually ± 2 percent of Proctor optimum moisture content. The placement and compaction of fill should be observed and tested by Entech Engineering, Inc. Imported soils should be approved by Entech Engineering, Inc. prior to being hauled to the site and on-site granular soils prior to placement.

Compacted, non-expansive granular soil, free of organics, debris and cobbles greater than 3-inches in diameter, is recommended for filling foundation components. All fill placed within the foundation areas should be non-expansive and be compacted to a minimum of 95 percent of the soils maximum dry density as determined by the Modified Proctor Test (ASTM D-1557). Fill material placed beneath floor slabs should be compacted to a minimum of 95 percent of its maximum Modified Proctor Dry Density, ASTM D-1557. Fill material should be placed in horizontal lifts such that each finished lift has a compacted thickness of six inches or less. Fill should be placed at water contents conducive to achieving adequate compaction, usually within ± 2 percent of the optimum water content as determined by ASTM D-1557. Mechanical methods can be used for placement and compaction of fill; however, heavy equipment should be kept at distance from the structure to avoid overstressing. No water flooding techniques of any type should be used for compaction or placement of fill material.

5.7 Utility Trench Backfill

Fill placed in utility trenches should be compacted to a minimum of 95 percent of its maximum dry density as determined by the Standard Proctor Test (ASTM D-698) for cohesive soils and 95 percent as determined by the Modified Proctor Test (ASTM D-1557) for cohesionless soils. Fill should be placed in horizontal lifts having a compacted thickness of six inches or less and at a water content conducive to adequate compaction, within ± 2 percent of the optimum water content. Mechanical methods should be used for fill placement; however, heavy equipment should be kept at a distance from foundation walls. No water flooding techniques of any type should be used for compaction or placement of utility trench fill.

Trench backfill placement should be performed in accordance with El Paso County specifications. All excavation and excavation shoring/bracing should be performed in accordance with OSHA guidelines.

5.8 General Backfill

Any areas to receive fill outside the foundation limits should have all topsoil, organic material, and debris removed. Fill must be properly benched into existing slopes in order to be adequately compacted. The fill receiving surface should be scarified to a depth of 12-inches and moisture conditioned to ± 2 percent of the optimum water content, and compacted to a minimum of 95 percent of the ASTM D-1557 maximum dry density before the addition of new fill. Fill should be placed in thin lifts not to exceed 6 inches in thickness after compaction while maintaining at least 95 percent of the ASTM D-1557 maximum dry density. Fill material should be free of vegetation and other unsuitable material and shall not contain rocks or fragments greater than 3-inches. Topsoil and strippings should be segregated from all other fill sources on the site. Fill placement and compaction beneath and around foundations, in utility trenches, beneath roadways or other structural features of the project should be observed and tested by Entech during construction.

5.9 Excavation Stability

Excavation sidewalls must be properly sloped, benched and/or otherwise supported in order to maintain stable conditions. All excavation openings and work completed therein shall conform to OSHA Standards as put forward in CFR 29, Part 1926.650-652, (Subpart P).

5.10 Winter Construction

In the event construction of the planned construction occurs during winter, foundations and subgrades should be protected from freezing conditions. Concrete should not be placed on frozen soil and once concrete has been placed, it should not be allowed to freeze. Similarly, once exposed, the foundation subgrade should not be allowed to freeze. During site grading and subgrade preparation, care should be taken to avoid burial of snow, ice or frozen material within the planned construction area.

5.11 Construction Observations

It is recommended that Entech observe and document the following activities during construction of the building foundations.

- Excavated subgrades and subgrade preparation.
- H-Pile Installation
- Placement of drains (if installed).
- Placement/compaction of fill material for the foundation components and retaining walls.
- Placement/compaction of utility bedding and trench backfill.

6.0 CLOSURE

The subsurface investigation, geotechnical evaluation and recommendations presented in this report are intended for use of C&C Land with application to the proposed bridge over Sand Creek at Briargate Boulevard and associated site improvements, in El Paso County northeast of Colorado Springs, Colorado. In conducting the subsurface investigation, laboratory testing, engineering evaluation and reporting, Entech Engineering, Inc. endeavored to work in accordance with generally accepted professional geotechnical and geologic practices and principles consistent with the level of care and skill ordinarily exercised by members of the geotechnical profession currently practicing in same locality and under similar conditions. No other warranty, expressed or implied is made. During final design and/or construction, if conditions are encountered which appear different from those described in this report, Entech Engineering, Inc. requests that it be notified so that the evaluation and recommendations presented herein can be reviewed and modified as appropriate.

If there are any questions regarding the information provided herein or if Entech Engineering, Inc. can be of further assistance, please do not hesitate to contact us.

TABLES

TABLE 1
SUMMARY OF LABORATORY TEST RESULTS

CLIENT C&C LAND
PROJECT BRIARGATE BRIDGE
JOB NO. 211647

SOIL TYPE	TEST BORING NO.	DEPTH (FT)	WATER (%)	DRY DENSITY (PCF)	PASSING NO. 200 SIEVE (%)	LIQUID LIMIT (%)	PLASTIC INDEX (%)	SULFATE (WT %)	FHA SWELL (PSF)	SWELL/CONSOL (%)	UNIFIED CLASSIFICATION	SOIL DESCRIPTION
1	1	5			7.6	NV	NP	<0.01			SM-SW	SAND, SLIGHTLY SILTY
2	1	20			8.0	NV	NP	0.00			SM-SW	SANDSTONE, SLIGHTLY SILTY
3	2	10	14.7	120.5	70.3	36	8	0.00		3.7	ML	SILTSTONE, SANDY

TABLE 2

Briargate Boulevard over Sand Creek Bridge - LPile Design Parameters

Depth Below Existing Ground Surface		Groundwater Elevation (ft) Below Existing Ground	Soil/Rock Description	Axial Pile Capacity Parameters		PRELIMINARY LPile Parameters					
Top	Bottom			Allowable Side Resistance (ksf)	Allowable End Bearing (ksf)	p-y Curve	Unit Weight γ^1 (pcf)	Peak Friction Angle ϕ (deg)	Initial Static Modulus of Subgrade Reaction, k (pci)	Undrained Cohesion s_u (psf)	Strain Factor ϵ_{su} (in/in)
0	4 to 5	1.5 to 3.5	Slightly Silty Sand	—	—	Sand	120 62 ¹	32	25 20 ¹	N/A	N/A
4 to 5 16 to 19	9 to 14 BOE		Slightly Silty Sandstone	3	30	Sand	125 67 ¹	34	225 125 ¹	N/A	N/A
9 to 14	16 to 19		Sandy Siltstone	3	30	Clay	115 57 ¹	N/A	500	1500	0.005

¹ = Submerged

FIGURES



Vicinity Map
Briargate Blvd Over Sand Creek
El Paso County, CO
For: C & C Land

JOB NO.:
211647

FIG NO.:
1

DRAWN:
AMN

DATE:
7/26/21

CHECKED:

DATE: _____

APPENDIX A: Test Boring Logs

TEST BORING NO. 1
 DATE DRILLED 7/13/2021
 Job # 211647

TEST BORING NO. 2
 DATE DRILLED 7/13/2021
 CLIENT C&C LAND
 LOCATION BRIARGATE BRIDGE

REMARKS	Depth (ft)	Symbol	Samples	Blows per foot	Watercontent %	Soil Type	REMARKS	Depth (ft)	Symbol	Samples	Blows per foot	Watercontent %	Soil Type
WATER @ 1.5', 7/20/21							WATER @ 3.5', 7/20/21						
SAND, SLIGHTLY SILTY, FINE TO COARSE GRAINED, GRAY BROWN, DENSE, VERY MOIST							SAND, SILTY, BROWN						1
	5			47	16.5	1	SANDSTONE, SLIGHTLY SILTY, FINE TO COARSE GRAINED, GRAY BROWN, VERY DENSE, MOIST	5			50	13.2	2
SANDSTONE, SLIGHTLY SILTY, FINE TO COARSE GRAINED, GRAY BROWN, DENSE TO VERY DENSE, VERY MOIST	10			50 6"	11.5	2	SILTSTONE, SANDY, GRAY BROWN, HARD, MOIST	10			50 11"	14.3	3
SILTSTONE, SANDY, GRAY BROWN, HARD, MOIST	15			50 5"	16.0	3	SANDSTONE, SLIGHTLY SILTY, FINE TO COARSE GRAINED, GRAY BROWN, VERY DENSE,	15			50 4"	16.6	3
SANDSTONE, SLIGHTLY SILTY, FINE TO COARSE GRAINED, GRAY BROWN, VERY DENSE, VERY MOIST	20			50 5"	15.5	2		20			50 4"	10.8	2



ENTECH
 ENGINEERING, INC.

505 ELKTON DRIVE
 COLORADO SPRINGS, COLORADO 80907

TEST BORING LOG

DRAWN:

DATE:

CHECKED: *A*

DATE: 7/23/21

JOB NO.:
 211647

FIG NO.:
 A- 1

APPENDIX B: Laboratory Test Results

UNIFIED CLASSIFICATION	SM-SW	CLIENT	C&C LAND
SOIL TYPE #	1	PROJECT	BRIARGATE BRIDGE
TEST BORING #	1	JOB NO.	211647
DEPTH (FT)	5	TEST BY	BL

Sieve Analysis Grain Size Distribution

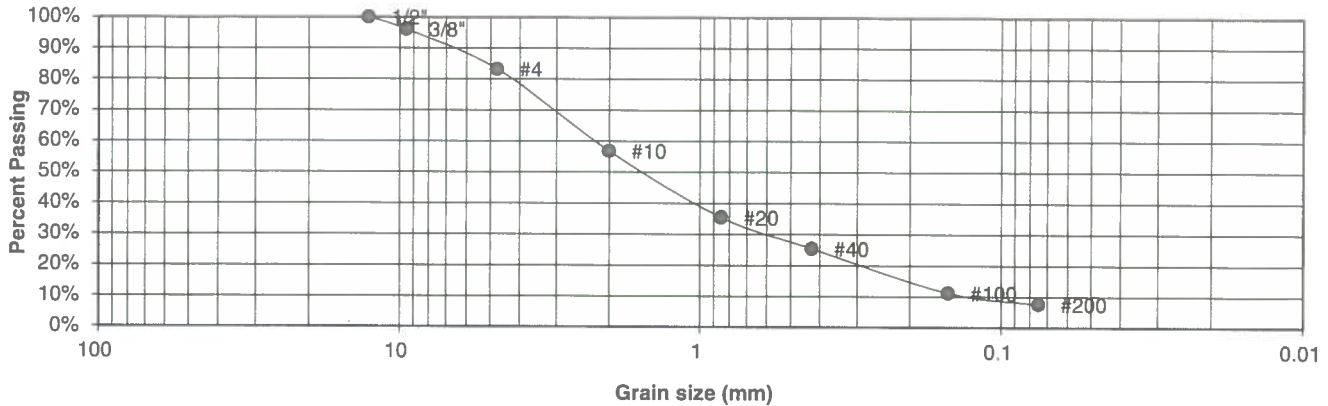

U.S. Sieve #	Percent Finer
3"	
1 1/2"	
3/4"	
1/2"	100.0%
3/8"	96.1%
4	83.2%
10	56.8%
20	35.4%
40	25.4%
100	11.2%
200	7.6%

Atterberg Limits	
Plastic Limit	NP
Liquid Limit	NV
Plastic Index	NP

Swell	
Moisture at start	
Moisture at finish	
Moisture increase	
Initial dry density (pcf)	
Swell (psf)	



ENTECH
ENGINEERING, INC.

505 ELKTON DRIVE
COLORADO SPRINGS, COLORADO 80907

LABORATORY TEST RESULTS

DRAWN:	DATE:	CHECKED:	DATE:
		<i>h</i>	7/23/21

JOB NO.:
211647

FIG NO.:
B-1

UNIFIED CLASSIFICATION	SM-SW	CLIENT	C&C LAND
SOIL TYPE #	2	PROJECT	BRIARGATE BRIDGE
TEST BORING #	1	JOB NO.	211647
DEPTH (FT)	20	TEST BY	BL

**Sieve Analysis
Grain Size Distribution**

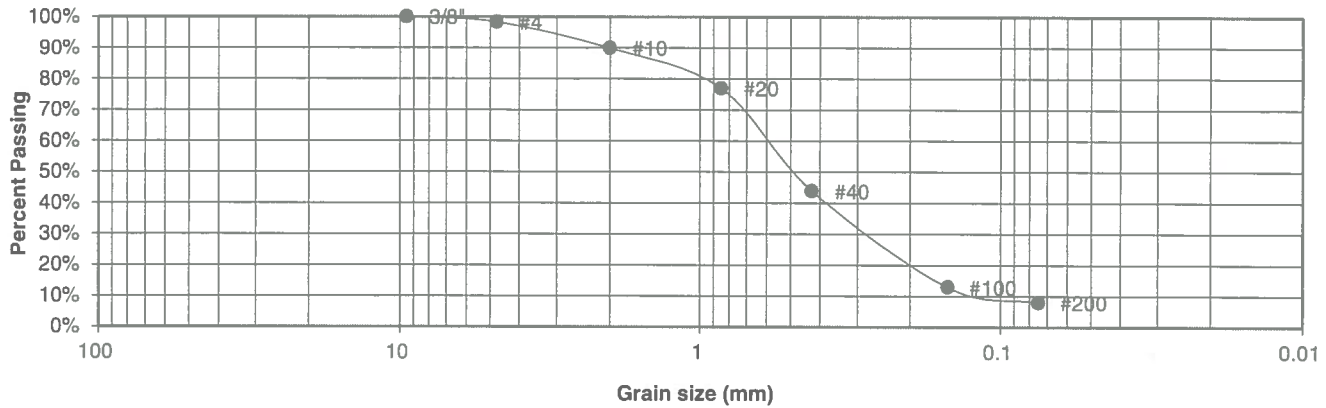

U.S. Sieve #	Percent Finer
3"	
1 1/2"	
3/4"	
1/2"	
3/8"	100.0%
4	98.3%
10	89.9%
20	77.0%
40	43.8%
100	12.9%
200	8.0%

**Atterberg
Limits**
 Plastic Limit NP
 Liquid Limit NV
 Plastic Index NP

Swell
 Moisture at start
 Moisture at finish
 Moisture increase
 Initial dry density (pcf)
 Swell (psf)



**ENTECH
ENGINEERING, INC.**

505 ELKTON DRIVE
COLORADO SPRINGS, COLORADO 80907

**LABORATORY TEST
RESULTS**

DRAWN:

DATE:

CHECKED: *AW*

DATE:

7-29-21

JOB NO.:
211647

FIG NO.:

B-2

UNIFIED CLASSIFICATION	ML	CLIENT	C&C LAND
SOIL TYPE #	3	PROJECT	BRIARGATE BRIDGE
TEST BORING #	2	JOB NO.	211647
DEPTH (FT)	10	TEST BY	BL

**Sieve Analysis
Grain Size Distribution**

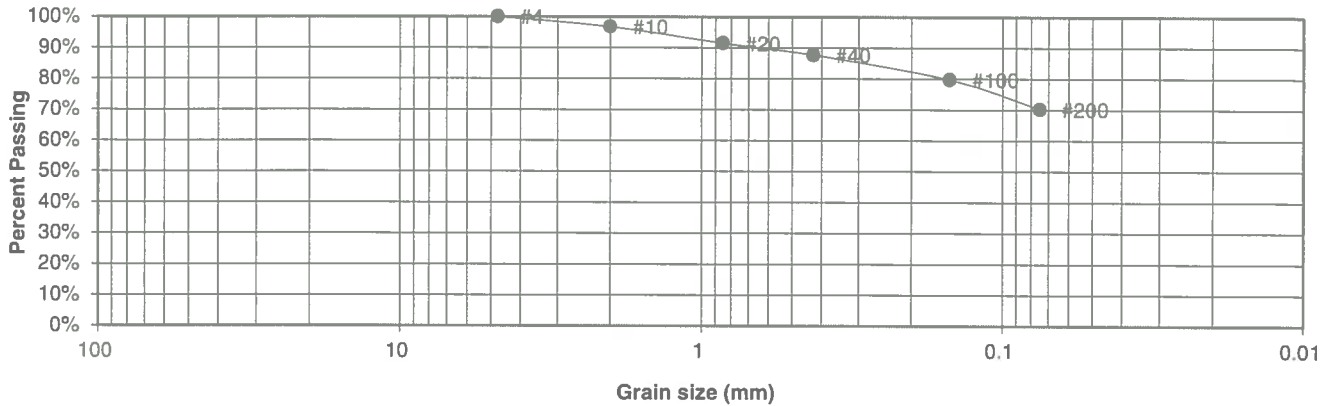

U.S. Sieve #	Percent Finer
3"	
1 1/2"	
3/4"	
1/2"	
3/8"	
4	100.0%
10	96.8%
20	91.5%
40	87.7%
100	79.8%
200	70.3%

Atterberg Limits	
Plastic Limit	28
Liquid Limit	36
Plastic Index	8

<u>Swell</u>	
Moisture at start	
Moisture at finish	
Moisture increase	
Initial dry density (pcf)	
Swell (psf)	



**ENTECH
ENGINEERING, INC.**

505 ELKTON DRIVE
COLORADO SPRINGS, COLORADO 80907

**LABORATORY TEST
RESULTS**

DRAWN:	DATE:	CHECKED:	DATE:
		<i>A</i>	7/23/21

JOB NO.:
211647

FIG NO.:
B-3

CONSOLIDATION TEST RESULTS

TEST BORING #	2	DEPTH(ft)	10
DESCRIPTION	ML	SOIL TYPE	3
NATURAL UNIT DRY WEIGHT (PCF)			121
NATURAL MOISTURE CONTENT			14.7%
SWELL/CONSOLIDATION (%)			3.7%

JOB NO. 211647
 CLIENT C&C LAND
 PROJECT BRIARGATE BRIDGE

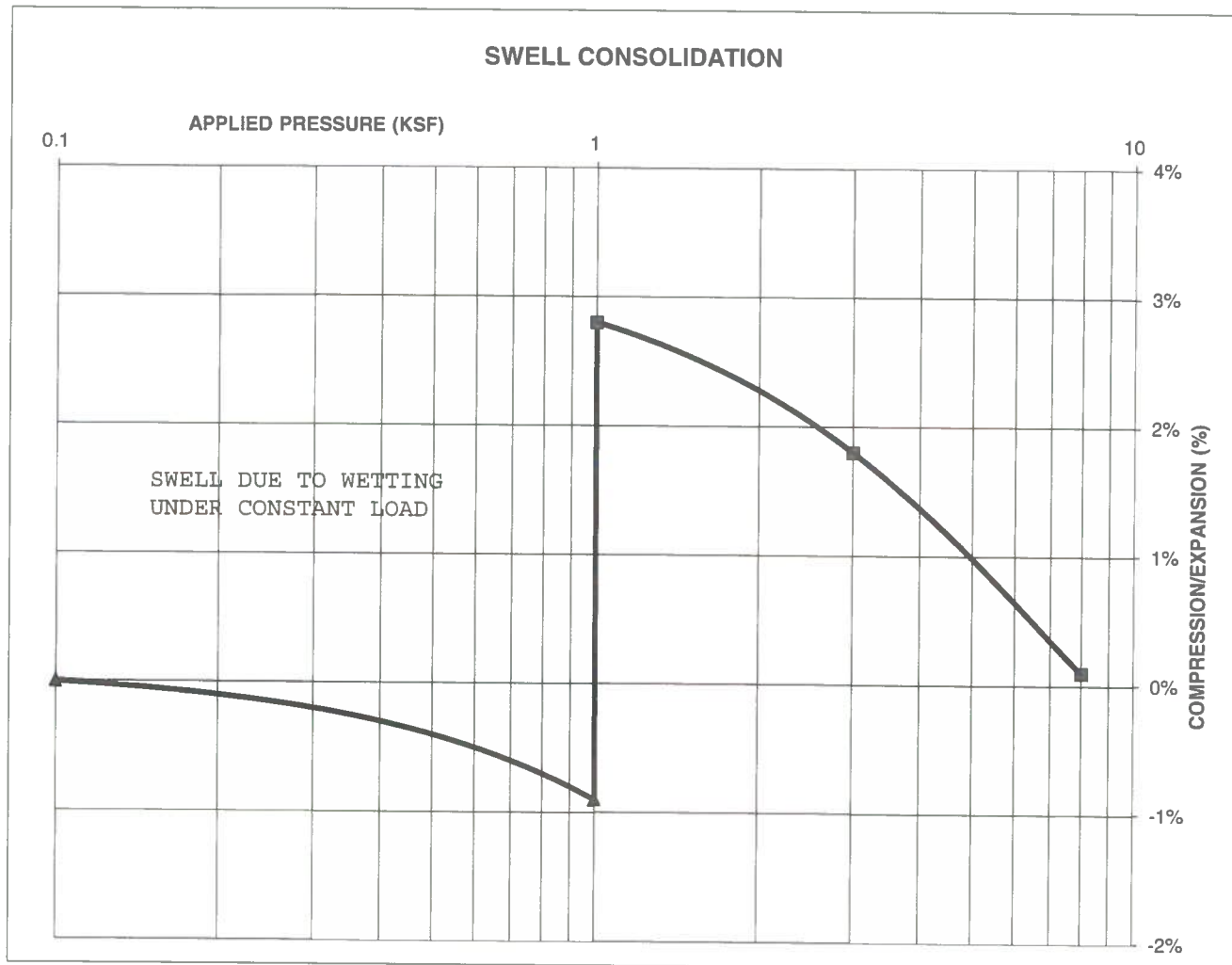

**ENTECH
ENGINEERING, INC.**

505 ELKTON DRIVE
 COLORADO SPRINGS, COLORADO 80907

SWELL CONSOLIDATION TEST RESULTS

DRAWN:

DATE:

CHECKED:

DATE:

7/23/21

JOB NO.:
211647

FIG NO.:
B-4

CLIENT	C&C LAND	JOB NO.	211647
PROJECT	BRIARGATE BRIDGE	DATE	7/19/2021
LOCATION	BRIARGATE BRIDGE	TEST BY	BL

[illegible]

QC BLANK PASS



ENTECH
ENGINEERING, INC.
505 ELKTON DRIVE
COLORADO SPRINGS, COLORADO 80907

LABORATORY TEST SULFATE RESULTS

DATE: 7/23/21

JOB NO.:
211647

B-5

Appendix C
Roadway Design Plans
Briargate Parkway and Sterling Ranch Road
M & S Civil

STERLING RANCH - BRIARGATE PARKWAY
FROM VOLLMER ROAD - WHEATLAND DRIVE
COUNTY OF EL PASO, STATE OF COLORADO
STREET IMPROVEMENT PLANS

INCLUDING SIGNAGE AND STRIPING PLAN

JANUARY 2018

AGENCIES

OWNER/DEVELOPER: SR LAND, LLC
20 BOULDER CRESCENT, SUITE 201
COLORADO SPRINGS, CO 80903
JIM MORLEY (719) 471-1742

CIVIL ENGINEER: M & S CIVIL CONSULTANTS, INC.
20 BOULDER CRESCENT, SUITE 110
COLORADO SPRINGS, CO 80903
VIRGIL A. SANCHEZ P.E. (719) 955-5485

COUNTY ENGINEERING: EL PASO COUNTY PLANNING AND COMMUNITY
DEVELOPMENT
2880 INTERNATIONAL CIRCLE, SUITE 110
COLORADO SPRINGS, CO 80910
JEFF RICE, P.E. (719) 520-6300

TRAFFIC ENGINEERING: EL PASO COUNTY DEPARTMENT OF PUBLIC WORKS
3275 AKERS DRIVE
COLORADO SPRINGS, CO 80922
JENNIFER IRVINE, P.E. (719) 520-6460

WATER RESOURCES: STERLING RANCH METRO DISTRICT ENGINEERS
JDS-HYDRO CONSULTANTS
545 E. PIKES PEAK AVE., SUITE 300
COLORADO SPRINGS, CO 80903
JOHN MCGINN (719) 668-8769

FIRE DISTRICT: BLACK FOREST FIRE PROTECTION DISTRICT
11445 TEACOUT ROAD
COLORADO SPRINGS, CO 80908
CHIEF BRYAN JACK (719) 495-4300

GAS DEPARTMENT: COLORADO SPRINGS UTILITIES
7710 DURANT DR.
COLORADO SPRINGS, CO 80947
TIM WENDT (719) 668-3556

ELECTRIC DEPARTMENT: MOUNTAIN VIEW ELECTRIC
11140 E. WOODMEN ROAD
FALCON, CO 80831
(719) 495-2283

COMMUNICATIONS: CENTURYLINK / COMCAST COMMUNICATIONS
(U.S.C.C. LOCATORS) (800) 922-1987
AT&T (LOCATORS) (719) 635-3674

BENCHMARKS:

1. THE TOP OF AN ALUMINUM SURVEYORS CAP, STAMPED "9853", AT THE SOUTHEAST BOUNDARY CORNER OF BARBARICK SUBDIVISION
NORTHING = 411416.273
EASTING = 235167.071
ELEVATION = 7023.42
2. THE TOP OF A RED PLASTIC SURVEYORS CAP, ILLEGIBLE, AT THE NORTHWEST BOUNDARY CORNER OF PAWNEE RANCHEROS SUBDIVISION
NORTHING = 410095.404
EASTING = 235052.131
ELEVATION = 7000.40
3. THE TOP OF A RED PLASTIC SURVEYORS CAP, STAMPED "38141", AT THE SOUTHWEST BOUNDARY CORNER OF BARBARICK SUBDIVISION
NORTHING = 411399.962
EASTING = 233849.817
ELEVATION = 7030.82

BASIS OF BEARINGS:

THE SOUTH LINE OF THE SOUTHWEST QUARTER (SW1/4) OF SECTION 34, TOWNSHIP 12 SOUTH, RANGE 65 WEST OF THE 6TH P.M. AS MONUMENTED AT THE SOUTHWEST CORNER OF SAID SOUTHWEST QUARTER (SW1/4) BY A 2-1/2" ALUMINUM CAP STAMPED "LS 11624" AND AT THE SOUTHEAST CORNER OF SAID SOUTHWEST QUARTER (SW1/4) BY A 2-1/2" ALUMINUM CAP STAMPED "LS 11624", SAID LINE BEARS N 89°14'14" E, A DISTANCE OF 2,722.56 FEET.

RECEIVED
JAN 04 2018

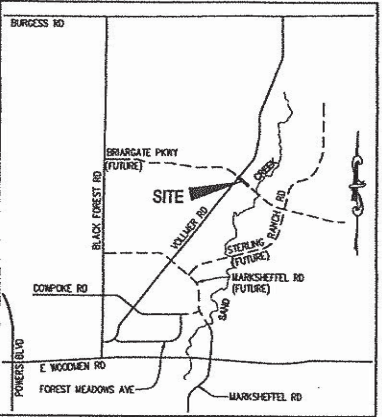

VICINITY MAP
N.T.S.

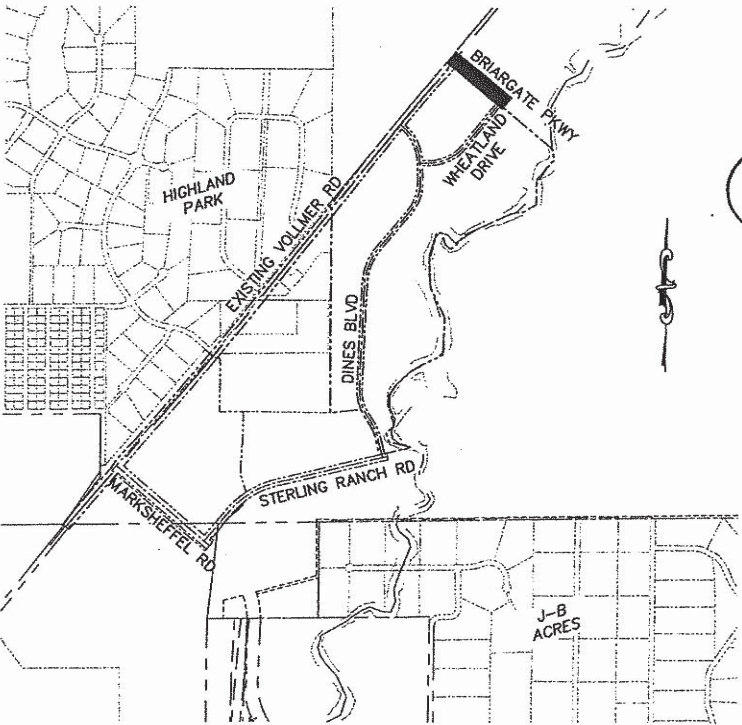

SITE MAP
N.T.S.

ABBREVIATIONS

ACT	ACTUAL	FL	FLOW LINE	PT	POINT OF TANGENCY
BCR	BACK OF CURB RETURN	FT	FEET FOOT	PROP	PROPOSED
BOV	BLOWOFF VALVE ASSEMBLY	FUT	FUTURE	REM	REMOVE
BRK	BREAK	GR	GRADE	RSW	RIGHTS OF WAY
BT	BEGINNING OF TRANSITION	HORIZ	HORIZONTAL	RSNTS	RESTRAINTS
CATV	CABLE TV	HP	HIGH POINT ELEVATION	RT	RIGHT
CL	CLASS, CENTERLINE	INT	INTERSECTION	SH	SANITARY SEWER
CLS	CLEARANCE	LP	LOW POINT ELEVATION	SD	STANDARD DETAIL
CONST	CONSTRUCT	LT	LEFT	STA	STATION
CSI	COLORADO SPRINGS UTILITIES	LOC	LOCATION	STM	STORM
ECR	END CURB RETURN	MIN	MINIMUM	COB	TOP CORNER OF BOX
EDA	EDGE OF ASPHALT	N.S.E.W	NORTH/SOUTH/EAST/WEST	TEL	TELEPHONE
EDP	EDGE OF PAVEMENT	NIS	NOT TO SCALE	TYP	TYPICAL
EL	ELEVATION	PCC	POINT OF COMPOUND CURVATURE	UNK	UNKNOWN
ELC	EL PASO COUNTY	PC	POINT OF CURB RETURN	UP	UNDERGROUND POWER
ESMT	EASMENT	PL	PROPERTY LINE	UTL	UTILITY
ET	EXIST	PUB	POINT OF REVERSE CURVE	VERT	VERTICAL
EX	EXISTING	PM	POINT OF VERTICAL INTERSECTION	WTR	WATER LINE
EXT	EXTENDING	PVC	POINT OF VERTICAL CURVE	XING	CROSSING
GA	GRADE BREAK	PVT	POINT OF VERTICAL TANGENT	YD	YARD (CUBIC)

LEGEND

PROPOSED GAS	PROPOSED SANITARY SEWER	PROPOSED WATER	RIGHT-OF-WAY	PROPERTY LINE	FIRE HYDRANT (EXISTING)	FIRE HYDRANT (PROPOSED)	STORM DRAIN	VALVE (PROPOSED)	VALVE (EXISTING)	BLOWOFF ASSY. (PROPOSED)	BLOWOFF ASSY. (EXISTING)	PLUG (PROPOSED)	PLUG (EXISTING)
ANCHOR, CONC. REVERSE	ANCHOR	ANCHOR	ANCHOR	ANCHOR	ANCHOR	ANCHOR	ANCHOR	ANCHOR	ANCHOR	ANCHOR	ANCHOR	ANCHOR	ANCHOR
EXISTING GAS	EXISTING SANITARY SEWER	EXISTING WATER	EXISTING RIGHT-OF-WAY	EXISTING PROPERTY LINE	EXISTING FIRE HYDRANT	EXISTING FIRE HYDRANT	EXISTING STORM DRAIN	EXISTING VALVE	EXISTING VALVE	EXISTING BLOWOFF ASSY.	EXISTING BLOWOFF ASSY.	EXISTING PLUG	EXISTING PLUG
EXISTING GAS	EXISTING SANITARY SEWER	EXISTING WATER	EXISTING RIGHT-OF-WAY	EXISTING PROPERTY LINE	EXISTING FIRE HYDRANT	EXISTING FIRE HYDRANT	EXISTING STORM DRAIN	EXISTING VALVE	EXISTING VALVE	EXISTING BLOWOFF ASSY.	EXISTING BLOWOFF ASSY.	EXISTING PLUG	EXISTING PLUG
EXISTING GAS	EXISTING SANITARY SEWER	EXISTING WATER	EXISTING RIGHT-OF-WAY	EXISTING PROPERTY LINE	EXISTING FIRE HYDRANT	EXISTING FIRE HYDRANT	EXISTING STORM DRAIN	EXISTING VALVE	EXISTING VALVE	EXISTING BLOWOFF ASSY.	EXISTING BLOWOFF ASSY.	EXISTING PLUG	EXISTING PLUG

APPROVALS:

ENGINEER'S STATEMENT:

THESE DETAILED PLANS AND SPECIFICATIONS WERE PREPARED UNDER MY DIRECTION AND SUPERVISION. SAID DETAILED PLANS AND SPECIFICATIONS HAVE BEEN PREPARED ACCORDING TO THE CRITERIA ESTABLISHED BY THE COUNTY FOR DETAILED DRAINAGE PLANS AND SPECIFICATIONS, AND SAID DETAILED PLANS AND SPECIFICATIONS ARE IN CONFORMITY WITH THE MASTER PLAN OF THE DRAINAGE BASIN. SAID DETAILED DRAINAGE PLANS AND SPECIFICATIONS MEET THE PURPOSES FOR WHICH THE PARTICULAR DRAINAGE FACILITY(S) IS DESIGNED. I ACCEPT RESPONSIBILITY FOR ANY LIABILITY CAUSED BY ANY NEGLIGENT ACTS, ERRORS, OR OMISSIONS ON MY PART IN PREPARATION OF THE DETAILED IMPROVEMENT PLANS AND SPECIFICATIONS.

VIRGIL A. SANCHEZ, COLORADO P.E. NO. 37160
FOR AND ON BEHALF OF M&S CIVIL CONSULTANTS, INC.

1-4-18
DATE

OWNER/DEVELOPER STATEMENT:

I, THE OWNER HAVE READ AND WILL COMPLY WITH ALL OF THE REQUIREMENTS SPECIFIED IN THESE DETAILED PLANS AND SPECIFICATIONS.

EL PASO COUNTY:

COUNTY PLAN REVIEW IS PROVIDED ONLY FOR GENERAL CONFORMANCE WITH COUNTY DESIGN CRITERIA. THE COUNTY IS NOT RESPONSIBLE FOR THE ACCURACY AND ADEQUACY OF THE DESIGN, DIMENSIONS, AND/OR ELEVATIONS WHICH SHALL BE CONFIRMED AT THE JOB SITE. THE COUNTY THROUGH APPROVAL OF THIS DOCUMENT ASSUMES NO RESPONSIBILITY FOR COMPLETENESS AND/OR ACCURACY OF THIS DOCUMENT.

FILED IN ACCORDANCE WITH THE REQUIREMENTS OF THE EL PASO COUNTY LAND DEVELOPMENT CODE, DRAINAGE CRITERIA, AND ENGINEERING CRITERIA MANUAL AS AMENDED.

JENNIFER IRVINE, P.E.
COUNTY ENGINEER/ECM ADMINISTRATOR

30 JAN 18
DATE

STERLING RANCH METROPOLITAN DISTRICT:

THESE DOCUMENTS HAVE BEEN REVIEWED AND APPROVED FOR STORM DRAIN AND ASSOCIATED UTILITY SERVICE CONSTRUCTION.

VIRGIL A. SANCHEZ, COLORADO P.E. NO. 37160
FOR AND ON BEHALF OF THE STERLING RANCH METRO. DISTRICT

1-4-18
DATE

SHEET INDEX

- SHEET 1 TITLE SHEET
SHEET 2 NOTES & DETAILS SHEET
SHEET 3 PLAN & PROFILE - "ULTIMATE" BRIARGATE PARKWAY
SHEET 4 PLAN & PROFILE - "INTERIM" BRIARGATE PARKWAY
SHEET 5 SIGNAGE AND STRIPING PLAN

FOR LOCATING & MARKING
GAS, ELECTRIC,
WATER &
TELEPHONE
LINES
FOR BURIED UTILITY INFORMATION
48 HRS BEFORE YOU DIG
CALL 1-800-922-1987

STERLING RANCH - BRIARGATE PARKWAY
STREET IMPROVEMENT PLAN
PROJECT NO. 09-002
SCALE: HORIZONTAL: N/A
VERTICAL: N/A
DATE: 1/3/2018
DESIGNED BY: DUM
DRAWN BY: ELY
CHECKED BY: VAS
SHEET 1 OF 5
S101

20 BOULDER CRESCENT, SUITE 110
COLORADO SPRINGS, CO 80903
PHONE 719.555.5485

CIVIL CONSULTANTS, INC.

FOR AND ON
BEHALF OF
M&S CIVIL
CONSULTANTS,
INC.

VIRGIL A. SANCHEZ, COLORADO P.E. NO. 37160

REVISIONS:

CAUTION

SF 16-013

1. IT SHALL BE THE RESPONSIBILITY OF THE CONTRACTOR TO VERIFY THE EXISTENCE AND LOCATION OF ALL UNDERGROUND UTILITIES ALONG THE ROUTE OF THE WORK. THE OMISSION FROM OR THE INCLUSION OF UTILITY LOCATIONS ON THE PLANS IS NOT TO BE CONSIDERED AS THE NONEXISTENCE OF OR A DEFINITE LOCATION OF EXISTING UNDERGROUND UTILITIES.
2. THE CONTRACTOR WILL TAKE THE NECESSARY PRECAUTIONS TO PROTECT EXISTING UTILITIES FROM DAMAGE DUE TO THIS OPERATION. ANY DAMAGE TO THE UTILITIES WILL BE REPAIRED AT THE CONTRACTOR'S EXPENSE, AND ANY SERVICE DISRUPTION WILL BE SETTLED BY THE CONTRACTOR.
3. ADDITIONAL EROSION CONTROL STRUCTURES MAY BE REQUIRED AT THE TIME OF CONSTRUCTION.
4. ALL BACKFILL, SUB-BASE, AND/OR BASE COURSE (CLASS 6) MATERIAL SHALL BE COMPACTED PER THE SOILS ENGINEER'S RECOMMENDATIONS, AND APPROVED BY EL PASO COUNTY PLANNING AND COMMUNITY DEVELOPMENT DIVISION.
5. ALL STATIONING IS CENTERLINE OF IMPROVEMENTS UNLESS OTHERWISE INDICATED. ALL ELEVATIONS ARE FLOW LINE UNLESS OTHERWISE INDICATED AS TOP BACK OF CURB (TBC), ASPHALT (ASP), OR TOP OF INLET OR BOX (TOB).
6. ALL DISTURBED PAVEMENT EDGES SHALL BE CUT TO NEAT UNITS. REPAIR SHALL CONFORM TO EPC EGM APPENDIX K - 1.2C.
7. ALL INTERSECTION ACCESSES TO BE CONSTRUCTED WITH A 25 FOOT SIGHT VISIBILITY TRIANGLES EXCEPT BARRAGUE PARKWAY AND VOLLMER ROAD WHICH ARE ARTERIALS AND A 50 FOOT SIGHT VISIBILITY TRIANGLE IS REQUIRED AND THERE SHALL BE NO OBSTRUCTIONS GREATER THAN 18" VERTICAL IN THIS AREA.
8. ALL CULVERTS AND STORM DRAIN PIPES SHALL BE SMOOTH INTERIOR CORRUGATED POLYETHYLENE PIPE (HDPE), REINFORCED CONCRETE PIPE (RCP). ALL CULVERTS SHALL BE PLACED COMPLETE WITH FLARED END SECTIONS. ADEQUACY OF MATERIAL THICKNESS FOR ANY CSP INSTALLED SHALL BE VERIFIED BY OWNER'S GEOTECHNICAL ENGINEER TO SUPPORT MINIMUM 50 YEAR DESIGN LIFE. CULVERTS MUST CONFORM TO EPC EGM SECTION 3.32 - CULVERTS.
9. ASPHALT THICKNESS AND BASE COURSE THICKNESS (COMPACTED) FOR ROADS SHALL BE PER DESIGN REPORT BY OWNER'S GEOTECHNICAL ENGINEER. OWNER'S GEOTECHNICAL ENGINEER TO BE ON SITE AT THE TIME OF ROAD CONSTRUCTION TO EVALUATE SOIL CONDITIONS AND DETERMINE IF ADDITIONAL MEASURES ARE NECESSARY TO ASSURE STABILITY OF THE NEW ROADS. PAVEMENT DESIGN SHALL BE APPROVED BY EL PASO COUNTY PLANNING AND COMMUNITY DEVELOPMENT DIVISION PRIOR TO CONSTRUCTION.

1. ALL SIGNS AND PAVEMENT MARKINGS SHALL BE IN COMPLIANCE WITH THE CURRENT MANUAL ON UNIFORM TRAFFIC CONTROL DEVICES (MUTCD).
2. REMOVAL OF EXISTING PAVEMENT MARKINGS SHALL BE ACCOMPLISHED BY A METHOD THAT DOES NOT MATERIALLY DAMAGE THE PAVEMENT. THE PAVEMENT MARKINGS SHALL BE REMOVED TO THE EXTENT THAT THEY WILL NOT BE VISIBLE UNDER DAY OR NIGHT CONDITIONS. AT NO TIME WILL IT BE ACCEPTABLE TO PAINT OVER EXISTING PAVEMENT MARKINGS.
3. ANY DEVIATION FROM THE STRIPING AND SIGNING PLAN SHALL BE APPROVED BY EL PASO COUNTY PLANNING AND COMMUNITY DEVELOPMENT DIVISION.
4. ALL SIGNS SHOWN ON THE SIGNING AND STRIPING PLAN SHALL BE NEW SIGNS. EXISTING SIGNS MAY REMAIN OR BE REUSED IF THEY MEET CURRENT EL PASO COUNTY AND MUTCD STANDARDS.
5. STREET NAME AND REGULATORY STOP SIGNS SHALL BE ON THE SAME POST AT INTERSECTIONS.
6. ALL REMOVED SIGNS SHALL BE DISPOSED OF IN A PROPER MANNER BY THE CONTRACTOR.
7. ALL STREET NAME SIGNS SHALL HAVE "D" SERIES LETTERS, WITH LOCAL ROADWAY SIGNS BEING 4" UPPER-LOWER CASE LETTERING ON 8" BLANK AND NON-LOCAL ROADWAY SIGNS BEING 6" LETTERING, UPPER-LOWER CASE ON 12" BLANK, WITH A WHITE BORDER THAT IS NOT RECESSED. MULTI-LANE ROADWAYS WITH SPEED LIMITS OF 40 MPH OR HIGHER SHALL HAVE 8" UPPER-LOWER CASE LETTERING ON 18" BLANK WITH A WHITE BORDER THAT IS NOT RECESSED. THE WIDTH OF THE NON-RECESSED WHITE BORDERS SHALL MATCH PAGE 255 OF THE 2012 MUTCD "STANDARD HIGHWAY SIGNS"
8. ALL TRAFFIC SIGNS SHALL HAVE A MINIMUM HIGH INTENSITY PRISMATIC GRADE SHEETING.
9. ALL LOCAL RESIDENTIAL STREET SIGNS SHALL BE MOUNTED ON A 1.75" X 1.75" SQUARE TUBE SIGN POST AND STUB POST BASE. FOR OTHER APPLICATIONS, REFER TO THE CDOT STANDARD S-614-8 REGARDING USE OF THE P2 TUBULAR STEEL POST SLIPBASE DESIGN.
10. ALL SIGNS SHALL BE SINGLE SHEET ALUMINUM WITH 0.100" MINIMUM THICKNESS.
11. ALL LIMIT LINES/STOP LINES, CROSSWALK LINES, PAVEMENT LEGENDS, AND ARROWS SHALL BE A MINIMUM 125 MIL THICKNESS PREFORMED THERMOPLASTIC PAVEMENT MARKINGS WITH TAPERED LEADING EDGES PER CDOT STANDARD S-627-1. WORD AND SYMBOL MARKINGS SHALL BE THE NARROW TYPE. STOP BARS SHALL BE 24" IN WIDTH. CROSSWALKS LINES SHALL BE 12" WIDE AND 8' LONG PER CDOT S-627-1.
12. ALL LONGITUDINAL LINES SHALL BE A MINIMUM 15MIL THICKNESS EPOXY PAINT. ALL NON-LOCAL RESIDENTIAL ROADWAYS SHALL INCLUDE BOTH RIGHT AND LEFT EDGE LINE STRIPING AND ANY ADDITIONAL STRIPING AS REQUIRED BY CDOT S-627-1.
13. THE CONTRACTOR SHALL NOTIFY EL PASO COUNTY DEPARTMENT OF PUBLIC WORKS (719) 520-6819 PRIOR TO AND UPON COMPLETION OF SIGNING AND STRIPING.
14. THE CONTRACTOR SHALL OBTAIN A WORK IN THE RIGHT OF WAY PERMIT FROM THE EL PASO COUNTY DEPARTMENT OF PUBLIC WORKS PRIOR TO ANY WORK WITHIN AN EXISTING EL PASO COUNTY ROADWAY, INCLUDING SIGNAGE OR STRIPING.

1. ALL DRAINAGE AND ROADWAY CONSTRUCTION SHALL MEET THE STANDARDS AND SPECIFICATIONS OF THE CITY OF COLORADO SPRINGS/EL PASO COUNTY DRAINAGE CRITERIA MANUAL, VOLUMES 1 AND 2, AND THE EL PASO COUNTY ENGINEERING CRITERIA MANUAL.
2. CONTRACTOR SHALL BE RESPONSIBLE FOR THE NOTIFICATION AND FIELD NOTIFICATION OF ALL EXISTING UTILITIES, WHETHER SHOWN ON THE PLANS OR NOT, BEFORE BEGINNING CONSTRUCTION. LOCATION OF EXISTING UTILITIES SHALL BE VERIFIED BY THE CONTRACTOR PRIOR TO CONSTRUCTION. CALL 811 TO CONTACT THE UTILITY NOTIFICATION CENTER OF COLORADO (UNCC).
3. CONTRACTOR SHALL KEEP A COPY OF THESE APPROVED PLANS, THE GRADING AND EROSION CONTROL PLAN, THE STORMWATER MANAGEMENT PLAN (SWMP), THE SOILS AND GEOTECHNICAL REPORT, AND THE APPROPRIATE DESIGN AND CONSTRUCTION STANDARDS AND SPECIFICATIONS AT THE JOB SITE AT ALL TIMES, INCLUDING THE FOLLOWING:
 - a. EL PASO COUNTY ENGINEERING CRITERIA MANUAL (ECM)
 - b. CITY OF COLORADO SPRINGS/EL PASO COUNTY DRAINAGE CRITERIA MANUAL, VOLUMES 1 AND 2
 - c. COLORADO DEPARTMENT OF TRANSPORTATION (CDOT) STANDARD SPECIFICATIONS FOR ROAD AND BRIDGE CONSTRUCTION
 - d. CDOT M & S STANDARDS
4. NOTWITHSTANDING ANYTHING DEPICTED IN THESE PLANS IN WORDS OR GRAPHIC REPRESENTATION, ALL DESIGN AND CONSTRUCTION RELATED TO ROADS, STORM DRAINAGE AND EROSION CONTROL SHALL CONFORM TO THE STANDARDS AND REQUIREMENTS OF THE MOST RECENT VERSION OF THE RELEVANT ADOPTED EL PASO COUNTY STANDARDS, INCLUDING THE LAND DEVELOPMENT CODE, THE ENGINEERING CRITERIA MANUAL, THE DRAINAGE CRITERIA MANUAL, AND THE DRAINAGE CRITERIA MANUAL VOLUME 2. ANY DEVIATIONS FROM REGULATIONS AND STANDARDS MUST BE REQUESTED, AND APPROVED, IN WRITING. ANY MODIFICATIONS NECESSARY TO MEET CRITERIA AFTER-THE-FACT WILL BE ENTIRELY THE DEVELOPER'S RESPONSIBILITY TO RECTIFY.
5. IT IS THE DESIGN ENGINEER'S RESPONSIBILITY TO ACCURATELY SHOW EXISTING CONDITIONS, BOTH ONSITE AND OFFSITE, ON THE CONSTRUCTION PLANS. ANY MODIFICATIONS NECESSARY DUE TO CONFLICTS, OMISSIONS, OR CHANGED CONDITIONS WILL BE ENTIRELY THE DEVELOPER'S RESPONSIBILITY TO RECTIFY.
6. CONTRACTOR SHALL SCHEDULE A PRE-CONSTRUCTION MEETING WITH EL PASO COUNTY PLANNING AND COMMUNITY DEVELOPMENT - INSPECTIONS, PRIOR TO STARTING CONSTRUCTION.
7. IT IS THE CONTRACTOR'S RESPONSIBILITY TO UNDERSTAND THE REQUIREMENTS OF ALL JURISDICTIONAL AGENCIES AND TO OBTAIN ALL REQUIRED PERMITS, INCLUDING BUT NOT LIMITED TO EL PASO COUNTY EROSION AND STORMWATER QUALITY CONTROL PERMIT (ESQCP), REGIONAL BUILDING FLOODPLAIN DEVELOPMENT PERMIT, U.S. ARMY CORPS OF ENGINEERS-ISSUED 401 AND/OR 404 PERMITS, AND COUNTY AND STATE FUGITIVE DUST PERMITS.
8. CONTRACTOR SHALL NOT DEVIATE FROM THE PLANS WITHOUT FIRST OBTAINING WRITTEN APPROVAL FROM THE DESIGN ENGINEER AND DEPARTMENT OF PUBLIC WORKS. CONTRACTOR SHALL NOTIFY THE DESIGN ENGINEER IMMEDIATELY UPON DISCOVERY OF ANY ERRORS OR INCONSISTENCIES.
9. ALL STORM DRAIN PIPE SHALL BE CLASS III RCP UNLESS OTHERWISE NOTED AND APPROVED BY DEPARTMENT OF PUBLIC WORKS.
10. CONTRACTOR SHALL COORDINATE GEOTECHNICAL TESTING PER ECM STANDARDS. PAVEMENT DESIGN SHALL BE APPROVED BY EL PASO COUNTY DEPARTMENT OF PUBLIC WORKS PRIOR TO PLACEMENT OF CURB AND GUTTER AND PAVEMENT.
11. ALL CONSTRUCTION TRAFFIC MUST ENTER/EXIT THE SITE AT APPROVED CONSTRUCTION ACCESS POINTS.
12. SIGHT VISIBILITY TRIANGLES AS IDENTIFIED IN THE PLANS SHALL BE PROVIDED AT ALL INTERSECTIONS. OBSTRUCTIONS GREATER THAN 18 INCHES VERTICAL ABOVE FLOWLINE ARE NOT ALLOWED WITHIN SIGHT TRIANGLES.
13. SIGNING AND STRIPING SHALL COMPLY WITH EL PASO COUNTY DOT AND MUTCO CRITERIA.
14. CONTRACTOR SHALL OBTAIN ANY PERMITS REQUIRED BY EL PASO COUNTY DEPARTMENT PUBLIC WORKS, INCLUDING WORK WITHIN THE RIGHT-OF-WAY AND SPECIAL TRANSPORT PERMITS.
15. THE LIMITS OF CONSTRUCTION SHALL REMAIN WITHIN THE PROPERTY LINE UNLESS OTHERWISE NOTED. THE OWNER/DEVELOPER SHALL OBTAIN WRITTEN PERMISSION AND EASEMENTS, WHERE REQUIRED, FROM ADJOINING PROPERTY OWNER(S) PRIOR TO ANY OFF-SITE DISTURBANCE, GRADING, OR CONSTRUCTION.

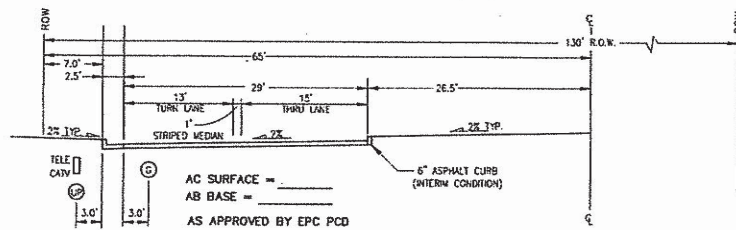

DESIGN SPEED = 50 MPH
POSTED SPEED = 25 MPH

130' R.O.W.

36' 12' 8' 1.5' 12' 12' 36' 65' 10.5' 2.5' 18.0' 6' WIDE MEANDERING SIDEWALK

THRU LANE SHOULDER SHOULDER THRU LANE THRU LANE SHOULDER

2% TRP. 2% TRP. 2% TRP.

EPC TYPE B CURB & GUTTER BOTH SIDES

EPC TYPE A CURB & GUTTER BOTH SIDES

18" OF COLORED PATTEREN CONCRETE SPLASH BLOCK BOTH SIDES OF MEDIAN

TELE CATCH

3.0'

DESIGN SPEED = 50 MPH
POSTED SPEED = 45 MPH

"ULTIMATE" BRIARGATE PARKWAY
(MODIFIED) 4 LANE URBAN PRINCIPAL ARTERIAL CROSS SECTION
SCALE: NTS

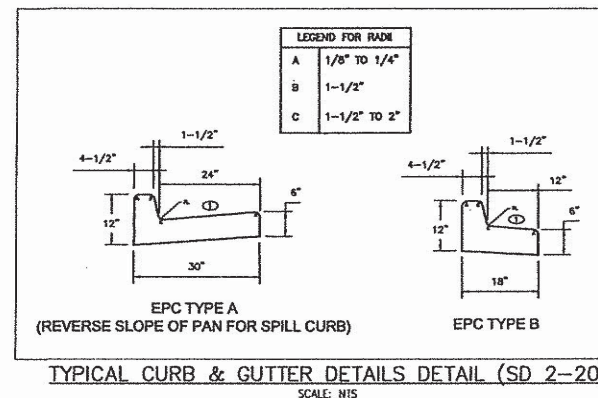

**FOR LOCATING
& MARKING
GAS,
ELECTRIC,
WATER &
TELEPHONE
LINES**

**FOR BURIED UTILITY INFORMATION
48 HRS BEFORE YOU DIG
CALL 1-800-922-1987**

1. IT SHALL BE THE RESPONSIBILITY OF THE CONTRACTOR TO VERIFY THE EXISTENCE AND LOCATION OF ALL UNDERGROUND UTILITIES ALONG THE ROUTE OF THE WORK. THE OMISSION FROM OR THE INCLUSION OF UTILITY LOCATIONS ON THE PLANS IS NOT TO BE CONSIDERED AS THE NONEXISTENCE OF OR A DEFINITE LOCATION OF EXISTING UNDERGROUND UTILITIES.
2. THE CONTRACTOR WILL TAKE THE NECESSARY PRECAUTIONS TO PROTECT EXISTING UTILITIES FROM DAMAGE DUE TO THIS OPERATION. ANY DAMAGE TO THE UTILITIES WILL BE REPAIRED AT THE CONTRACTOR'S EXPENSE, AND ANY SERVICE DISRUPTION WILL BE SETTLED BY THE CONTRACTOR.
3. ADDITIONAL EROSION CONTROL STRUCTURES MAY BE REQUIRED AT THE TIME OF CONSTRUCTION.
4. ALL BACKFILL, SUB-BASE, AND/OR BASE COURSE (CLASS 6) MATERIAL SHALL BE COMPACTED PER THE SOILS ENGINEER'S RECOMMENDATIONS, AND APPROVED BY EL PASO COUNTY DEVELOPMENT SERVICES ENGINEERING DIVISION.
5. ALL STATIONING IS CENTERLINE OF IMPROVEMENTS UNLESS OTHERWISE INDICATED. ALL ELEVATIONS ARE FLOW LINE UNLESS OTHERWISE INDICATED AS TOP BACK OF CURB (TBC), ASPHALT (ASP), OR TOP OF INLET OR BOX (TOB).
6. ALL DISTURBED PAVEMENT EDGES SHALL BE CUT TO NEAT LINES. REPAIR SHALL CONFORM TO EPC ECM APPENDIX K - 1.2C.
7. ALL INTERSECTION ACCESSES TO BE CONSTRUCTED WITH A 25 FOOT SIGHT VISIBILITY TRIANGLES EXCEPT [VOLLMER ROAD/ MARKSHEFFEL ROAD/ BRAINGATE PARKWAY] WHICH IS AN ARTERIAL AND A 50 FOOT SIGHT VISIBILITY TRIANGLE IS REQUIRED AND THERE SHALL BE NO OBSTRUCTIONS GREATER THAN 18" [?] IN THIS AREA.
8. ALL CULVERTS AND STORM DRAIN PIPES SHALL BE SMOOTH INTERIOR CORRUGATED POLYETHYLENE PIPE (HDPE), REINFORCED CONCRETE PIPE (RCP). ALL CULVERTS SHALL BE PLACED COMPLETE WITH FLARED END SECTIONS. ADEQUACY OF MATERIAL THICKNESS FOR ALL CSP INSTALLED SHALL BE VERIFIED BY OWNER'S GEOTECHNICAL ENGINEER TO SUPPORT MINIMUM 50 YEAR DESIGN LIFE. CULVERTS MUST CONFORM TO EPC ECM SECTION 3.32 - CULVERTS.
9. ASPHALT THICKNESS AND BASE COURSE THICKNESS (COMPACTED) FOR ROADS SHALL BE PER DESIGN REPORT BY OWNER'S GEOTECHNICAL ENGINEER. OWNER'S GEOTECHNICAL ENGINEER TO BE ON SITE AT THE TIME OF ROAD CONSTRUCTION TO EVALUATE SOIL CONDITIONS AND DETERMINE IF ADDITIONAL MEASURES ARE NECESSARY TO ASSURE STABILITY OF THE NEW ROADS. PAVEMENT DESIGN SHALL BE APPROVED BY EL PASO COUNTY DEVELOPMENT SERVICES ENGINEERING DIVISION PRIOR TO CONSTRUCTION.

1. ALL SIGNS AND PAVEMENT MARKINGS SHALL BE IN COMPLIANCE WITH THE CURRENT MANUAL ON UNIFORM TRAFFIC CONTROL DEVICES (MUTCD).
2. REMOVAL OF EXISTING PAVEMENT MARKINGS SHALL BE ACCOMPLISHED BY A METHOD THAT DOES NOT MATERIALLY DAMAGE THE PAVEMENT. THE PAVEMENT MARKINGS SHALL BE REMOVED TO THE EXTENT THAT THEY WILL NOT BE VISIBLE UNDER DAY OR NIGHT CONDITIONS. AT NO TIME WILL IT BE ACCEPTABLE TO PAINT OVER EXISTING PAVEMENT MARKINGS.
3. ANY DEVIATION FROM THE STRIPING AND SIGNING PLAN SHALL BE APPROVED BY EL PASO COUNTY DEVELOPMENT SERVICES.
4. ALL SIGNS SHOWN ON THE SIGNING AND STRIPING PLAN SHALL BE NEW SIGNS. EXISTING SIGNS MAY REMAIN OR BE REUSED IF THEY MEET CURRENT EL PASO COUNTY AND MUTCD STANDARDS.
5. STREET NAME AND REGULATORY STOP SIGNS SHALL BE ON THE SAME POST AT INTERSECTIONS.
6. ALL REMOVED SIGNS SHALL BE DISPOSED OF IN A PROPER MANNER BY THE CONTRACTOR.
7. ALL STREET NAME SIGNS SHALL HAVE "D" SERIES LETTERS, WITH LOCAL ROADWAY SIGNS BEING 4" UPPER-LOWER CASE LETTERING ON 8" BLANK AND NON-LOCAL ROADWAY SIGNS BEING 6" LETTERING, UPPER-LOWER CASE ON 12" BLANK, WITH A WHITE BORDER THAT IS NOT RECESSED. MULTI-LANE ROADWAYS WITH SPEED LIMITS OF 40 MPH OR HIGHER SHALL HAVE 8" UPPER-LOWER CASE LETTERING ON 16" BLANK WITH A WHITE BORDER THAT IS NOT RECESSED. THE WIDTH OF THE NON-RECESSED WHITE BORDERS SHALL MATCH PAGE 255 OF THE 2012 MUTCD "STANDARD HIGHWAY SIGNS"
8. ALL TRAFFIC SIGNS SHALL HAVE A MINIMUM HIGH INTENSITY PRISMATIC GRADE SHEETING.
9. ALL LOCAL RESIDENTIAL STREET SIGNS SHALL BE MOUNTED ON A 1.75" X 1.75" SQUARE TUBE SIGN POST AND STUB POST BASE. FOR OTHER APPLICATIONS, REFER TO THE CDOT STANDARD S-614-B REGARDING USE OF THE P2 TUBULAR STEEL POST SUBBASE DESIGN. ALL SIGNS SHALL BE SINGLE SHEET ALUMINUM WITH 0.100" MINIMUM THICKNESS.
10. ALL LIMIT LINES/STOP LINES, CROSSWALK LINES, PAVEMENT LEGENDS, AND ARROWS SHALL BE A MINIMUM 125 MIL THICKNESS PREFORMED THERMOPLASTIC PAVEMENT MARKINGS WITH TAPERED LEADING EDGES PER CDOT STANDARD S-627-1. WORD AND SYMBOL MARKINGS SHALL BE THE NARROW TYPE. STOP BARS SHALL BE 24" IN WIDTH. CROSSWALKS LINES SHALL BE 12" WIDE AND 8' LONG PER CDOT S-627-1.
11. ALL LONGITUDINAL LINES SHALL BE A MINIMUM 15MIL THICKNESS EPOXY PAINT. ALL NON-LOCAL RESIDENTIAL ROADWAYS SHALL INCLUDE BOTH RIGHT AND LEFT EDGE LINE STRIPING AND ANY ADDITIONAL STRIPING AS REQUIRED BY CDOT S-627-1.
12. THE CONTRACTOR SHALL NOTIFY EL PASO COUNTY DEVELOPMENT SERVICES (719) 520-6819 PRIOR TO AND UPON COMPLETION OF SIGNING AND STRIPING.
13. THE CONTRACTOR SHALL OBTAIN A WORK IN THE RIGHT OF WAY PERMIT FROM THE EL PASO COUNTY PUBLIC SERVICE DEPARTMENT (PSD) PRIOR TO ANY SIGNAGE OR STRIPING WORK WITHIN AN EXISTING EL PASO COUNTY ROADWAY.

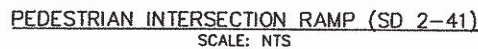

1. ALL DRAINAGE AND ROADWAY CONSTRUCTION SHALL MEET THE STANDARDS AND SPECIFICATIONS OF THE CITY OF COLORADO SPRINGS/EL PASO COUNTY DRAINAGE CRITERIA MANUAL, VOLUMES 1 AND 2, AND THE EL PASO COUNTY ENGINEERING CRITERIA MANUAL.
2. CONTRACTOR SHALL BE RESPONSIBLE FOR THE NOTIFICATION AND FIELD NOTIFICATION OF ALL EXISTING UTILITIES, WHETHER SHOWN ON THE PLANS OR NOT, BEFORE BEGINNING CONSTRUCTION. LOCATION OF EXISTING UTILITIES SHALL BE VERIFIED BY THE CONTRACTOR PRIOR TO CONSTRUCTION. CALL 811 TO CONTACT THE UTILITY NOTIFICATION CENTER OF COLORADO (UNCC).
3. CONTRACTOR SHALL KEEP A COPY OF THESE APPROVED PLANS, THE GRADING AND EROSION CONTROL PLAN, THE STORMWATER MANAGEMENT PLAN (SWMP), THE SOILS AND GEOTECHNICAL REPORT, AND THE APPROPRIATE DESIGN AND CONSTRUCTION STANDARDS AND SPECIFICATIONS AT THE JOB SITE AT ALL TIMES, INCLUDING THE FOLLOWING:
 - a. EL PASO COUNTY ENGINEERING CRITERIA MANUAL (ECM)
 - b. CITY OF COLORADO SPRINGS/EL PASO COUNTY DRAINAGE CRITERIA MANUAL, VOLUMES 1 AND 2
 - c. COLORADO DEPARTMENT OF TRANSPORTATION (CDOT) STANDARD SPECIFICATIONS FOR ROAD AND BRIDGE CONSTRUCTION
 - d. CDOT M & S STANDARDS
4. NOTWITHSTANDING ANYTHING DEPICTED IN THESE PLANS IN WORDS OR GRAPHIC REPRESENTATION, ALL DESIGN AND CONSTRUCTION RELATED TO ROADS, STORM DRAINAGE AND EROSION CONTROL, SHALL CONFORM TO THE STANDARDS AND REQUIREMENTS OF THE MOST RECENT VERSION OF THE RELEVANT ADOPTED EL PASO COUNTY STANDARDS, INCLUDING THE LAND DEVELOPMENT CODE, THE ENGINEERING CRITERIA MANUAL, THE DRAINAGE CRITERIA MANUAL, AND THE DRAINAGE CRITERIA MANUAL VOLUME 2. ANY DEVIATIONS FROM REGULATIONS AND STANDARDS MUST BE REQUESTED, AND APPROVED, IN WRITING. ANY MODIFICATIONS NECESSARY TO MEET CRITERIA AFTER-THE-FACT WILL BE ENTIRELY THE DEVELOPER'S RESPONSIBILITY TO RECTIFY.
5. IT IS THE DESIGN ENGINEER'S RESPONSIBILITY TO ACCURATELY SHOW EXISTING CONDITIONS, BOTH ON-SITE AND OFF-SITE, ON THE CONSTRUCTION PLANS. ANY MODIFICATIONS NECESSARY DUE TO CONFLICTS, OMISSIONS, OR CHANGED CONDITIONS WILL BE ENTIRELY THE DEVELOPER'S RESPONSIBILITY TO RECTIFY.
6. CONTRACTOR SHALL SCHEDULE A PRE-CONSTRUCTION MEETING WITH EL PASO COUNTY DEVELOPMENT SERVICES DEPARTMENT (DSD) - INSPECTIONS, PRIOR TO STARTING CONSTRUCTION.
7. IT IS THE CONTRACTOR'S RESPONSIBILITY TO UNDERSTAND THE REQUIREMENTS OF ALL JURISDICTIONAL AGENCIES AND TO OBTAIN ALL REQUIRED PERMITS, INCLUDING BUT NOT LIMITED TO EL PASO COUNTY EROSION AND STORMWATER QUALITY CONTROL PERMIT (ESQCP), REGIONAL BUILDING FLOODPLAIN DEVELOPMENT PERMIT, U.S. ARMY CORPS OF ENGINEERS-ISSUED 401 AND/OR 404 PERMITS, AND COUNTY AND STATE FUGITIVE DUST PERMITS.
8. CONTRACTOR SHALL NOT DEVIATE FROM THE PLANS WITHOUT FIRST OBTAINING WRITTEN APPROVAL FROM THE DESIGN ENGINEER AND DSD. CONTRACTOR SHALL NOTIFY THE DESIGN ENGINEER IMMEDIATELY UPON DISCOVERY OF ANY ERRORS OR INCONSISTENCIES.
9. ALL STORM DRAIN PIPE SHALL BE CLASS III RCP UNLESS OTHERWISE NOTED AND APPROVED BY DSD.
10. CONTRACTOR SHALL COORDINATE GEOTECHNICAL TESTING PER ECM STANDARDS. PAVEMENT DESIGN SHALL BE APPROVED BY EL PASO COUNTY DSD PRIOR TO PLACEMENT OF CURB AND GUTTER AND PAVEMENT.
11. ALL CONSTRUCTION TRAFFIC MUST ENTER/EXIT THE SITE AT APPROVED CONSTRUCTION ACCESS POINTS.
12. SIGHT VISIBILITY TRIANGLES AS IDENTIFIED IN THE PLANS SHALL BE PROVIDED AT ALL INTERSECTIONS. OBSTRUCTIONS GREATER THAN 18 INCHES ABOVE FLOWLINE ARE NOT ALLOWED WITHIN SIGHT TRIANGLES.
13. SIGNING AND STRIPING SHALL COMPLY WITH EL PASO COUNTY DOT AND MUTCD CRITERIA. [IF APPLICABLE, ADDITIONAL SIGNING AND STRIPING NOTES WILL BE PROVIDED.]
14. CONTRACTOR SHALL OBTAIN ANY PERMITS REQUIRED BY EL PASO COUNTY DOT, INCLUDING WORK WITHIN THE RIGHT-OF-WAY AND SPECIAL TRANSPORT PERMITS.
15. THE LIMITS OF CONSTRUCTION SHALL REMAIN WITHIN THE PROPERTY LINE UNLESS OTHERWISE NOTED. THE OWNER/DEVELOPER SHALL OBTAIN WRITTEN PERMISSION AND EASEMENTS, WHERE REQUIRED, FROM ADJOINING PROPERTY OWNER(S) PRIOR TO ANY OFF-SITE DISTURBANCE, GRADING, OR CONSTRUCTION.

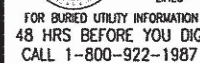
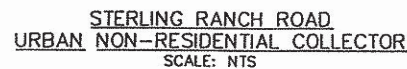

Appendix D

Sterling Ranch 404 Permit



REPLY TO
ATTENTION OF

DEPARTMENT OF THE ARMY
ALBUQUERQUE DISTRICT, CORPS OF ENGINEERS
200 SOUTH SANTA FE AVENUE, SUITE 301
PUEBLO, COLORADO 81003-4270

NOT SIGNED
ce-24-16

February 18, 2016

Regulatory Division

SUBJECT: Action No. SPA-2015-00428-SCO, Sterling Ranch Residential Development Project, El Paso County, Colorado

Jim Morley
SR Land, LLC
20 Boulder Crescent Suite 201
Colorado Springs, CO 80903

Mr. Morley:

Enclosed for your review and signature are two copies of the draft permit for Action No. SPA-2015-00428-SCO discharge dredged and fill material into waters of the United States.

You may either sign the permit or object to the permit and request the permit to be modified in accordance with the enclosed Notification of Administrative Appeal Options and Process and Request For Appeal (NAAOP-RFA). If you elect to object to this permit, you must complete Section II (Request for Appeal or Objections to an Initial Proffered Permit) of the enclosure and return to: U.S. Army Corps of Engineers, Attn: Mr. Tom Cavanaugh, Administrative Appeal Review Officer, 1455 Market Street, Room 1760, San Francisco, CA 94103-1399, within 60 days of the date of this letter.

If you elect to sign the permit, please ensure that both copies are signed and dated and return them to the attention of the Regulatory Division at the address above. Your signature on the permit indicates that you accept the permit in its entirety and forfeit all rights to appeal the permit or its terms and conditions, and denotes your assurance that the work will be conducted in accordance with the plans, description, and all terms and conditions of the permit.

A fee in the amount of \$100.00 for commercial project must be paid before the permit can be issued. Your check should be made payable to the "Finance and Accounting Officer, UFC, Albuquerque", and mailed to the attention of the Regulatory Division at the above address.

Within ten days, both signed copies of the accepted permit should be returned to us. One copy of the signed permit will be returned to you. The permit is not valid until signed by the U.S. Army Corps of Engineers. If you have any questions concerning this

-2-

permit, please contact me at 719-543-6915 or by e-mail at van.a.truan@usace.army.mil.

Sincerely,

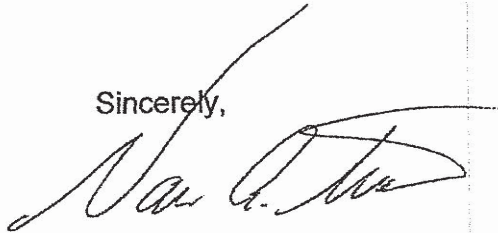
A handwritten signature in black ink, appearing to read "Van A. Truan", with a large, sweeping flourish extending from the end of the signature.

Van Truan
Chief, Southern Colorado
Regulatory Branch

Enclosures



REPLY TO
ATTENTION OF

DEPARTMENT OF THE ARMY
ALBUQUERQUE DISTRICT, CORPS OF ENGINEERS
200 SOUTH SANTA FE AVENUE, SUITE 301
PUEBLO, COLORADO 81003-4270

SIGNED

February 29, 2016

Regulatory Division

SUBJECT: Action No. SPA-2015-00428-SCO, Sterling Ranch Residential Development
Project, El Paso County, Colorado

Jim Morley
SR Land, LLC
20 Boulder Crescent Suite 201
Colorado Springs, CO 80903

Mr. Morley:

You are hereby authorized under Section 404 of the Clean Water Act to discharge dredged and fill material into waters of the United States to conduct work in associated with construction of the Sterling Ranch Residential Development in accordance with Action Number SPA-2015-00428-SCO. A copy of the permit is enclosed.

To use this permit, you must ensure that the work is conducted in accordance with the terms and conditions of the permit. You must submit revised drawings to us for approval prior to construction should any changes be found necessary in either the location or plans for the work. Approval of revised plans may be granted if they are found not contrary to the public interest.

This permit is not an approval of the project design features, nor does it imply that the construction is adequate for its intended purpose. This permit does not authorize any injury to property or invasion of rights or any infringement of Federal, state or local laws or regulations. You must possess the authority, including property rights, to undertake the proposed work.

Enclosed is a compliance certification form. Upon completion of the project, please sign and date the form and return it to this office.

If you have any questions concerning our regulatory program, please contact me at 719-543-6915 or by e-mail at van.a.truan@usace.army.mil. At your convenience,

please complete a Customer Service Survey at
<http://per2.nwp.usace.army.mil/survey.html>.

Sincerely,

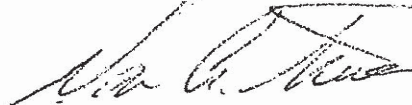
A handwritten signature in dark ink, appearing to read "Van Truan", with a long horizontal flourish extending to the right.

Van Truan
Chief, Southern Colorado
Regulatory Branch

Enclosure(s)

**Certification of Compliance
with Department of the Army Permit**

Action Number: SPA-2015-00428-SCO

Name of Permittee: SR Land, LLC

Upon completion of the activity authorized by this permit and any mitigation required by the permit, sign this certification and return it to the following address:

Van Truan
Albuquerque District, U.S. Army Corps of Engineers
200 South Santa Fe Avenue, Suite 301
Pueblo, Colorado 81003-4270

Please note that your permitted activity is subject to a compliance inspection by an U.S. Army Corps of Engineers representative. If you fail to comply with this permit, you are subject to permit suspension, modification, or revocation.

Please enclose photographs showing the completed project (if available).

I hereby certify that the work authorized by the above referenced permit has been completed in accordance with the terms and conditions of the said permit, and required mitigation was completed in accordance with the permit conditions.

Date Work Started _____

Date Work Completed _____

Date

Signature of Permittee

DEPARTMENT OF THE ARMY PERMIT

Permittee Jim Morley

Permit No. SPA-2015-00428-SCO

Issuing Office Albuquerque District, U.S. Army Corps of Engineers

NOTE: The term "you" and its derivatives, as used in this permit, means the permittee or any future transferee. The term "this office" refers to the appropriate district or division office of the Corps of Engineers having jurisdiction over the permitted activity or the appropriate official of that office acting under the authority of the commanding officer.

You are authorized to perform work in accordance with the terms and conditions specified below.

Project Description: The Sterling Ranch Residential Development Project includes installation of attendant utilities, channel improvements to the main stem of Sand Creek, three off-line stormwater detention ponds, development of two permanent residential access roads and associated culverts, and development of residential units. Permanent impacts to waters of the US will result from construction of the residential access roads and associated culverts, and construction of residential units in the unnamed western tributary to Sand Creek. Total cumulative permanent impacts from the discharge of fill material into waters/wetlands of the US from the proposed project will total 4.21 acres and 5,048 linear feet within the main channel of Sand Creek and its western tributary. The project will be constructed in accordance with the attached drawings, entitled, "Sterling Ranch Wetland Impact Location Map, Sterling Ranch Sketch Plan figure number 8, and Sterling Ranch Channel Improvements & Mitigation Plan sheets 1 through 3 dated October 13, 2015, in Sand Creek, El Paso County, Colorado, Application by Jim Morley, Application No. SPA-2015-00428-SCO".

Project Location: The project is located on 1,443.7 acres northeast of the intersection of Black Forest Road and Woodmen Road in unincorporated El Paso County, Colorado. The property is on the United States Geological Survey (USGS) Falcon Quadrangle on portions of Sections 27, 28, 32, 33, and 34 in Township 12 South, Range 65 West and the northwest portion of Section 4, Township 13 South, Range 65 West. The approximate coordinates of the project center are 39.964483 latitude and -104.664944 longitude (WGS 84 datum).

Permit Conditions: In accordance with the attached Colorado Department of Public Health and Environment Section 401 Water Quality Certification pages 1 through 6 of 6, dated February 4, 2016.

General Conditions:

1. The time limit for completing the work authorized ends on March 1, 2021. If you find that you need more time to complete the authorized activity, submit your request for a time extension to this office for consideration at least one month before the above date is reached.

2. You must maintain the activity authorized by this permit in good condition and in conformance with the terms and conditions of this permit. You are not relieved of this requirement if you abandon the permitted activity,

although you may make a good faith transfer to a third party in compliance with General Condition 4 below. Should you wish to cease to maintain the authorized activity or should you desire to abandon it without a good faith transfer, you must obtain a modification of this permit from this office, which may require restoration of the area.

3. If you discover any previously unknown historic or archeological remains while accomplishing the activity authorized by this permit, you must immediately notify this office of what you have found. We will initiate the Federal and state coordination required to determine if the remains warrant a recovery effort or if the site is eligible for listing in the National Register of Historic Places.

4. If you sell the property associated with this permit, you must obtain the signature of the new owner in the space provided and forward a copy of the permit to this office to validate the transfer of this authorization.

5. If a conditioned water quality certification has been issued for your project, you must comply with the conditions specified in the certification as special conditions to this permit. For your convenience, a copy of the certification is attached if it contains such conditions.

6. You must allow representatives from this office to inspect the authorized activity at any time deemed necessary to ensure that it is being or has been accomplished in accordance with the terms and conditions of your permit.

Special Conditions:

1. The permittee shall implement and abide by the compensatory mitigation plan titled Conceptual Mitigation Plan for Sterling Ranch Residential Development, prepared by CORE Consultants, Inc. on October 29, 2015 except where changes are necessary to comply with special conditions listed below. The permittee shall implement the mitigation plan concurrently with the construction of the project and complete the initial construction and plantings associated with the mitigation work prior to EITHER the initiation of operation OR completion of construction of the project. Completion of all elements of this mitigation plan is a requirement of this permit.

2. The permittee shall submit annual compensatory mitigation site monitoring reports to the Corps Albuquerque District Office by December 31st of each year, beginning in 2016, for a minimum of 3 years or until the Corps has determined that the mitigation performance standards and success criteria have been met. The monitoring reports shall be prepared in accordance with Corps Regulatory Guidance Letter 08-03 (Minimum Monitoring Requirements for Compensatory Mitigation Projects Involving the Restoration, Establishment, and/or Enhancement of Aquatic Resources) and current Corps Albuquerque District Mitigation Monitoring Guidelines available at <http://www.spa.usace.army.mil/Missions/RegulatoryProgramandPermits/Mitigation.aspx>. The mitigation monitoring reports shall at a minimum include the following:

a. Comparison of pre-construction site conditions to an as-built survey as submitted in accordance with Special Condition 4.

b. A map showing the wetland AND/OR Ordinary High Water Mark (OHWM) delineation, and aerial photos marked to show the wetland AND/OR OHWM boundary.

c. Photographs (minimum 5) from fixed photographic monitoring points with a location reference map and indicating camera orientation.

d. All data collected to document whether the mitigation site is achieving performance standards described in the mitigation plan and a narrative discussion of progress made toward meeting performance standards.

e. Fish and wildlife observations at the mitigation site.

f. Summary statement regarding the perceived success of the mitigation project and any potential problem areas. Suggestions and a timetable for corrections should be included if it is anticipated that project goals may not be met.

g. Date(s) of field inspection(s).

3. In order to assist the Corps in scheduling compliance inspections, the permittee shall notify the Corps Albuquerque District Office, in writing, at least 7 calendar days in advance of the initiation of mitigation construction AND no later than 15 calendar days following completion of construction activities.

4. Within 60 days after completion of construction of the mitigation project, the permittee shall submit as-built drawings and a description of the work conducted to the Corps Albuquerque District Office. The drawings shall include the following:

a. The Department of the Army Action Number.

b. A plan view drawing of the location of the authorized work footprint (as shown in permit drawings) with an overlay of the work as constructed in the same scale. The drawing should show all "earth disturbance," wetland impacts, structures, and the boundaries of any on-site and/or off-site mitigation or avoidance areas. The drawings shall contain, at a minimum, 1-foot OR greater topographic contours of the entire site.

c. Ground photographs of the completed work. The camera positions and view-angles of the ground photographs shall be identified on a map, aerial photograph, or project drawing.

d. A description of all deviations between the work as authorized by the permit and the work as constructed. Clearly indicate on the as-built drawings the location of any deviations.

5. Your responsibility to complete the required compensatory mitigation as set forth in Special Condition No. 1 will not be considered fulfilled until you have demonstrated mitigation success and have received written verification from the U.S. Army Corps of Engineers.

Further Information:

1. Congressional Authorities: You have been authorized to undertake the activity described above pursuant to:

() Section 10 of the Rivers and Harbors Act of 1899 (33 U.S.C. 403).

(X) Section 404 of the Clean Water Act (33 U.S.C. 1344).

() Section 103 of the Marine Protection, Research and Sanctuaries Act of 1972 (33 U.S.C. 1413).

2. Limits of this authorization.

a. This permit does not obviate the need to obtain other Federal, state, or local authorizations required by law.

b. This permit does not grant any property rights or exclusive privileges.

c. This permit does not authorize any injury to the property or rights of others.

d. This permit does not authorize interference with any existing or proposed Federal project.

3. Limits of Federal Liability. In issuing this permit, the Federal Government does not assume any liability for the following:

a. Damages to the permitted project or uses thereof as a result of other permitted or unpermitted activities or from natural causes.

b. Damages to the permitted project or uses thereof as a result of current or future activities undertaken by or on behalf of the United States in the public interest.

c. Damages to persons, property, or to other permitted or unpermitted activities or structures caused by the activity authorized by this permit.

d. Design or construction deficiencies associated with the permitted work.

e. Damage claims associated with any future modification, suspension, or revocation of this permit.

4. Reliance on Applicant's Data: The determination of this office that issuance of this permit is not contrary to the public interest was made in reliance on the information you provided.

5. Reevaluation of Permit Decision. This office may reevaluate its decision on this permit at any time the circumstances warrant. Circumstances that could require a reevaluation include, but are not limited to, the following:

a. You fail to comply with the terms and conditions of this permit.

b. The information provided by you in support of your permit application proves to have been false, incomplete, or inaccurate (See 4 above).

c. Significant new information surfaces which this office did not consider in reaching the original public interest decision.

Such a reevaluation may result in a determination that it is appropriate to use the suspension, modification, and revocation procedures contained in 33 CFR 325.7 or enforcement procedures such as those contained in 33 CFR 326.4 and 326.5. The referenced enforcement procedures provide for the issuance of an administrative order requiring you to comply with the terms and conditions of your permit and for the initiation of legal action where appropriate. You will be required to pay for any corrective measures ordered by this office, and if you fail to comply with such directive, this office may in certain situations (such as those specified in 33 CFR 209.170) accomplish the corrective measures by contract or otherwise and bill you for the cost.

6. Extensions. General condition 1 establishes a time limit for the completion of the activity authorized by this

permit. Unless there are circumstances requiring either a prompt completion of the authorized activity or a reevaluation of the public interest decision, the Corps will normally give favorable consideration to a request for an extension of this time limit.

Your signature below, as permittee, indicates that you accept and agree to comply with the terms and conditions of this permit.

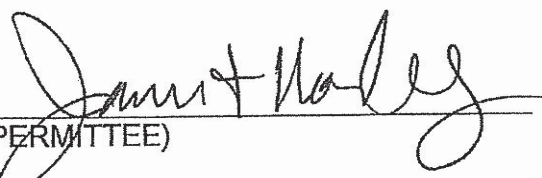
(PERMITTEE)

2/23/2016
(DATE)

This permit becomes effective when the Federal official, designated to act for the Secretary of the Army, has signed below.

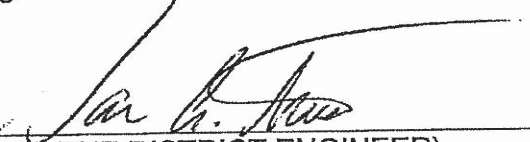
(FOR THE DISTRICT ENGINEER)

29 Feb 2016
(DATE)

Patrick J. Dagon
Lieutenant Colonel, U.S. Army
District Commander

When the structures or work authorized by this permit are still in existence at the time the property is transferred, the terms and conditions of this permit will continue to be binding on the new owner(s) of the property. To validate the transfer of this permit and the associated liabilities associated with compliance with its terms and conditions, have the transferee sign and date below.

(TRANSFEREE)

(DATE)

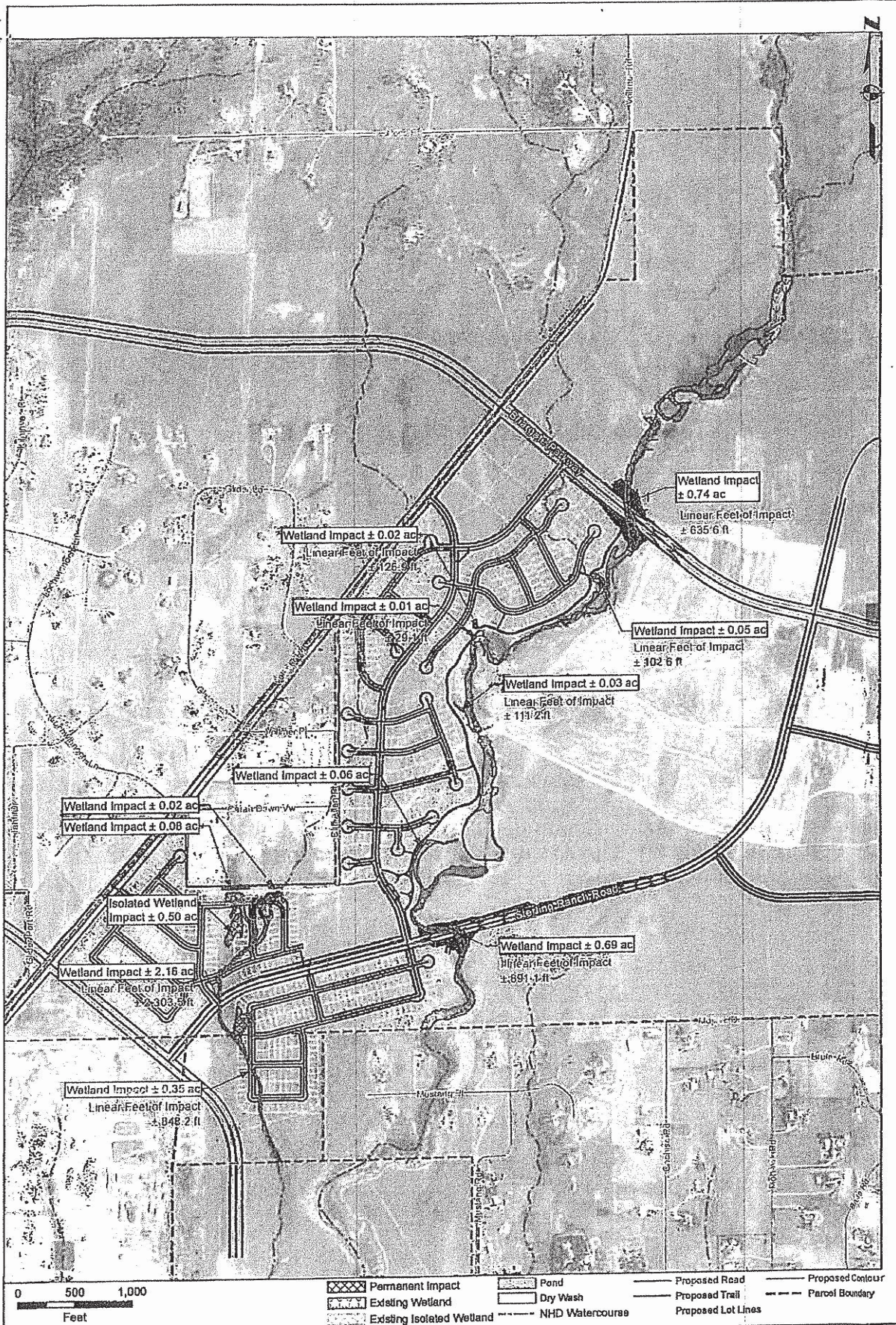

CORE
CONSULTANTS

CIVIL ENGINEERING
DEVELOPMENT CONSULTING
LAND SURVEYING
303.703.4444
1950 W. 6th Street, Ste. 102
Littleton, CO 80120

Sterling Ranch

Wetland Impact Location Map

El Paso County, Colorado

Date: 10/13/2015
Project #: 15-001

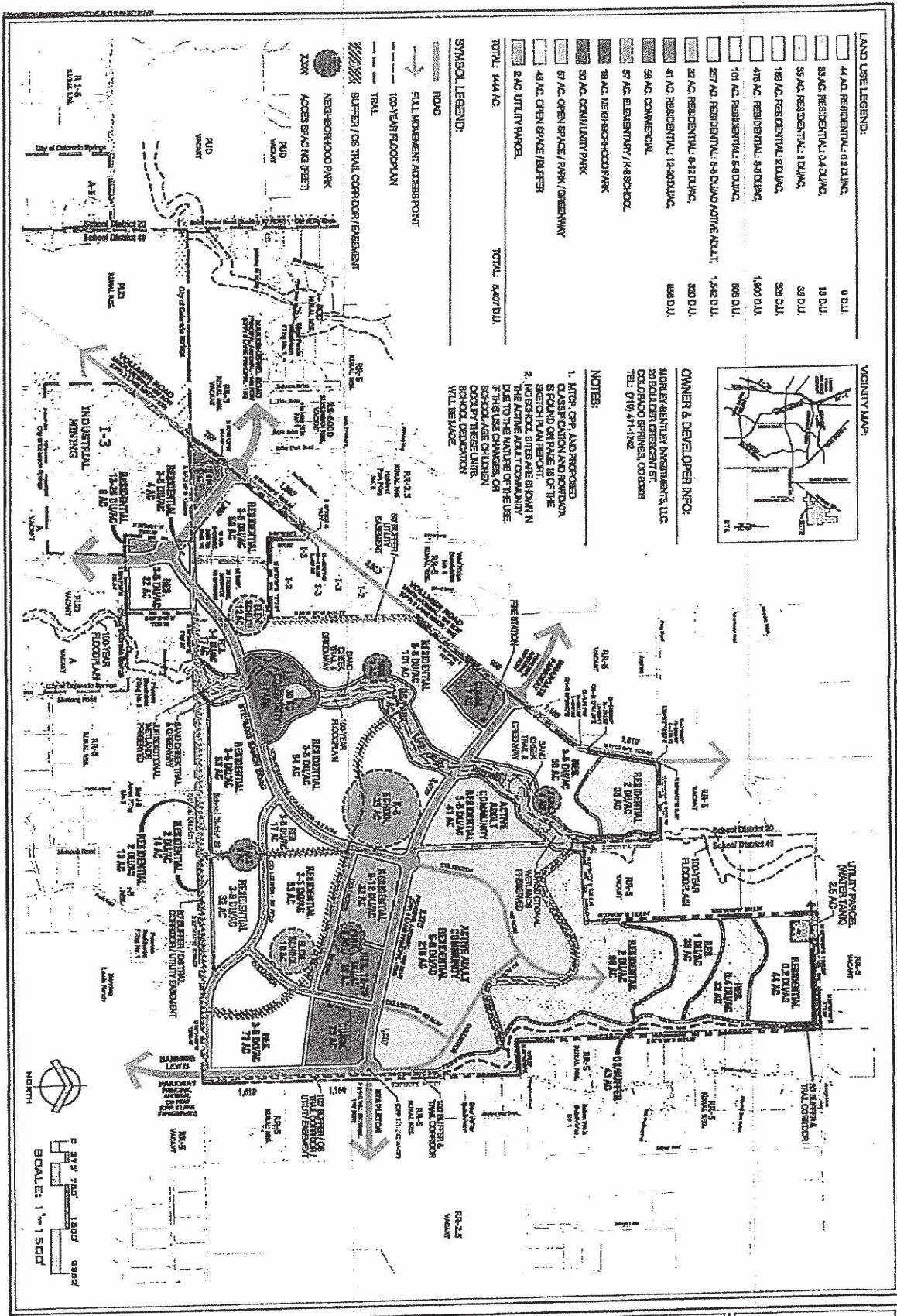

LAND USE LEGEND:

44 AC. RESIDENTIAL 0.2 D.U./AC.	0 D.U.
55 AC. RESIDENTIAL 0.4 D.U./AC.	18 D.U.
55 AC. RESIDENTIAL 1 D.U./AC.	55 D.U.
168 AC. RESIDENTIAL 2 D.U./AC.	336 D.U.
476 AC. RESIDENTIAL 3.6 D.U./AC.	1,713 D.U.
101 AC. RESIDENTIAL 6.0 D.U./AC.	606 D.U.
257 AC. RESIDENTIAL 6.4 D.U./AC. ACTIVE ADULT	1,645 D.U.
24 AC. RESIDENTIAL 9-12 D.U./AC.	240 D.U.
41 AC. RESIDENTIAL 12-20 D.U./AC.	492 D.U.
52 AC. COMMERCIAL	52 D.U.
57 AC. ELEMENTARY / K-8 SCHOOL	57 D.U.
18 AC. NEIGHBORHOOD PARK	18 D.U.
35 AC. COMMUNITY PARK	35 D.U.
57 AC. OPEN SPACE / PARK / GREENWAY	57 D.U.
4 AC. OPEN SPACE / BUFFER	4 D.U.
2 AC. UTILITY PACE	2 D.U.
TOTAL: 1444 AC.	TOTAL: 3,427 D.U.

SYMBOL LEGEND:

- ROAD
- FULL MOVEMENT ACCESS POINT
- 100-YEAR FLOODPLAIN
- TRAIL
- BUFFER / OS TRAIL CORRIDOR / EASEMENT
- NEIGHBORHOOD PARK
- ACCESS SPACING (FEET)
- PUD
- VACANT
- FLD
- WATER

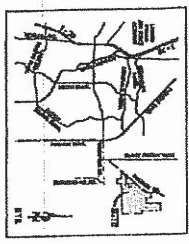

OWNER & DEVELOPER INFO:

MORLEY-BENTLEY INVESTMENTS, LLC
20 BOLLARD CREEK DRIVE
COLORADO SPRINGS, CO 80903
TEL: (719) 471-1762

NOTES:

1. LOTS 509 AND PROPOSED 100-YEAR FLOODPLAIN AND FLOODPLAIN ZONING ARE SHOWN ON PAGE 10 OF THE SKETCH PLAN REPORT.
2. NO SCHOOL SITES ARE SHOWN IN DUE TO THE NATURE OF THE USE, OCCUPANCY OF CHILDREN, SCHOOL ZONING, SCHOOL ZONING WILL BE MADE.

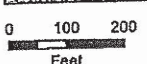
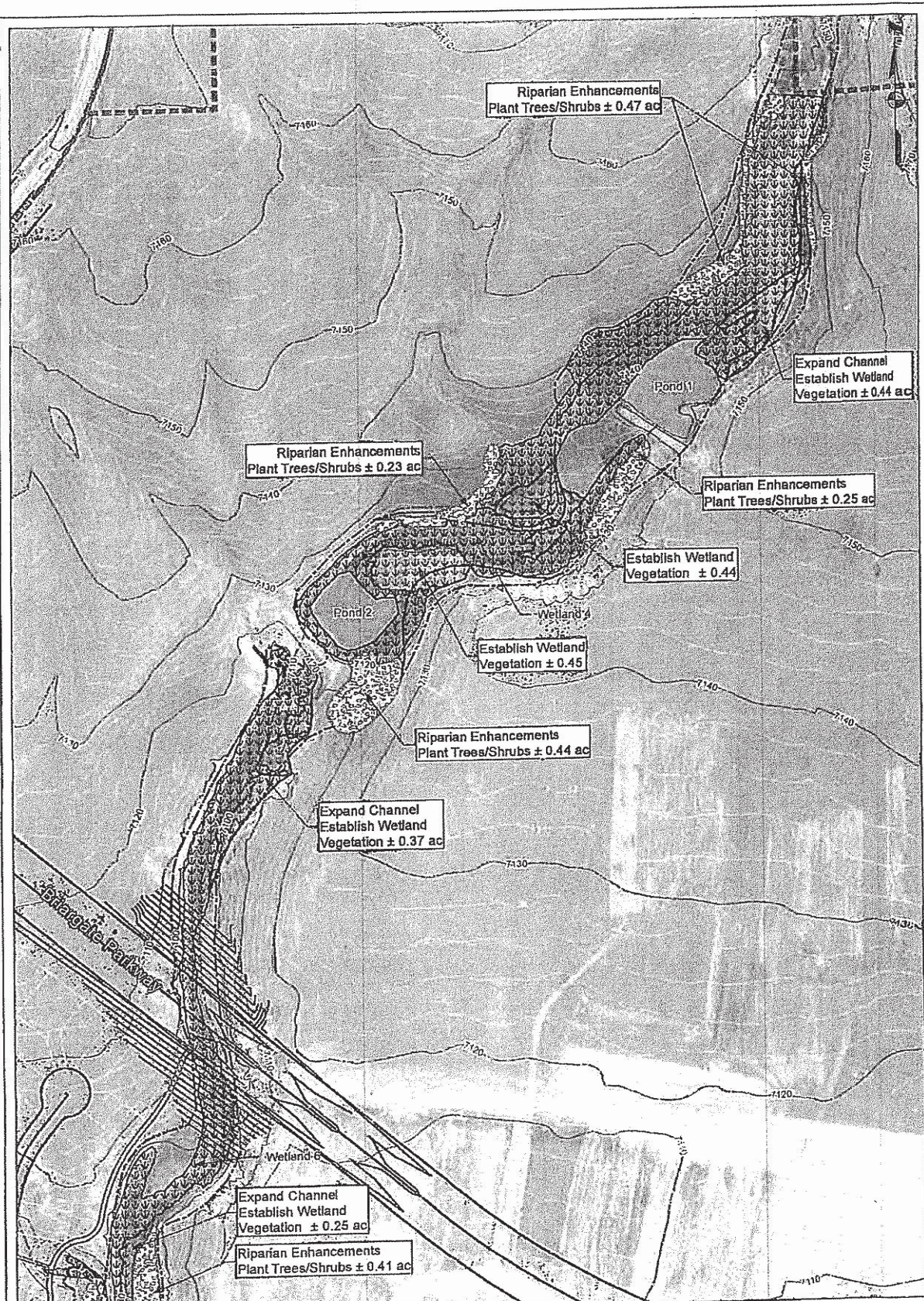

- | | | | | |
|---|---|---|---|--|
| <ul style="list-style-type: none"> Potential Riparian Enhancement Potential Wetland Mitigation Area Existing Wetland | <ul style="list-style-type: none"> Pond Dry Wash Existing Isolated Wetland | <ul style="list-style-type: none"> NHD Watercourse 100-year Floodplain 500-year Floodplain | <ul style="list-style-type: none"> Proposed Road Proposed Trail Proposed Lot Lines Proposed Contour | <ul style="list-style-type: none"> Index Contour Intermediate Contour Parcel Boundary |
|---|---|---|---|--|



CIVIL ENGINEERING
DEVELOPMENT CONSULTING
LAND SURVEYING
801.701.4444
1950 W. Lullwater Blvd., Ste. 105
Littleton, CO 80120

Sterling Ranch

Channel Improvements & Mitigation Plan

Sheet 1

El Paso County, Colorado

Date: 10/13/2015
Project #: 15-001

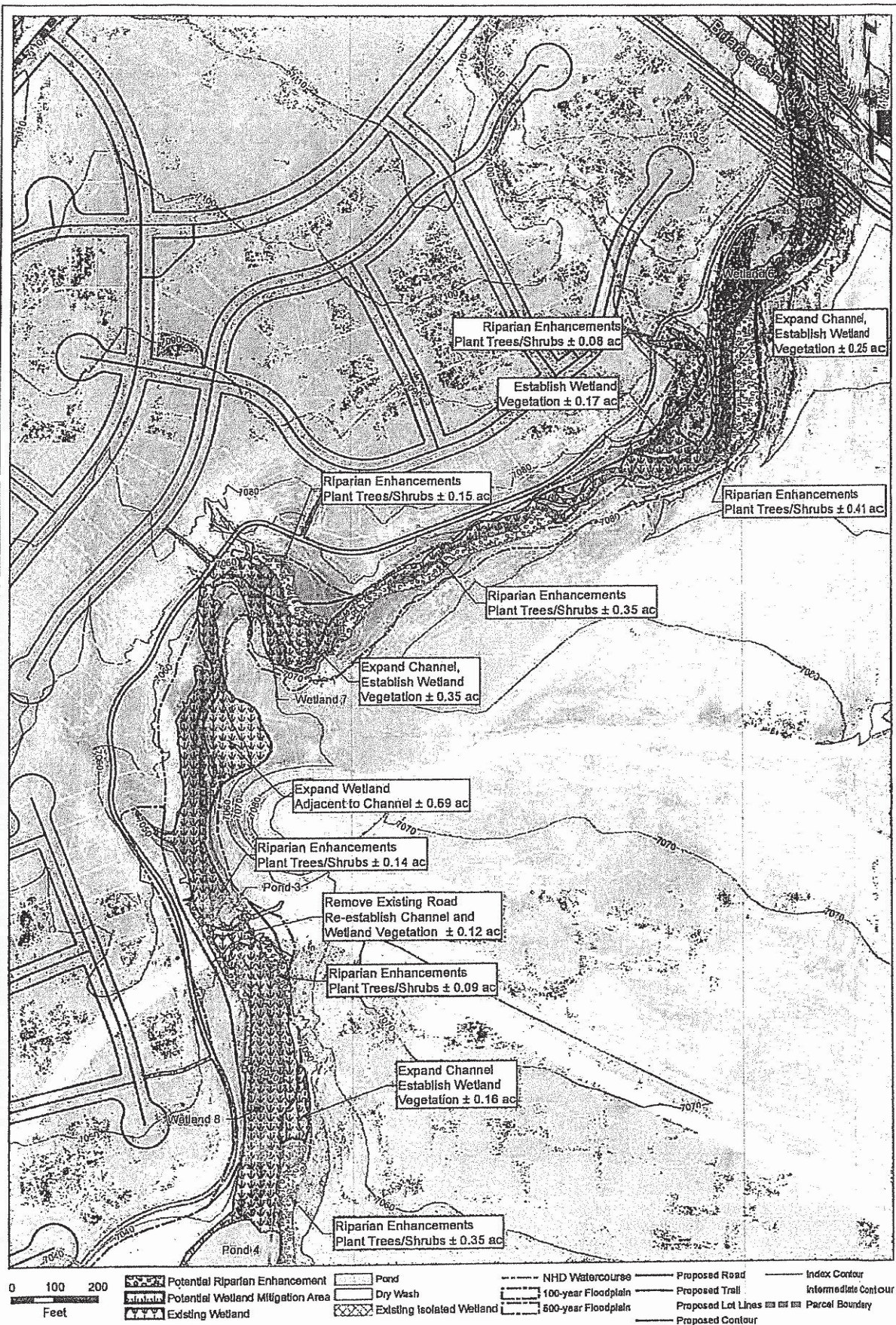

CORE
CONSULTANTS

CIVIL ENGINEERING
DEVELOPMENT CONSULTING
LAND SURVEYING
503.763.4444
1930 W. Littleton Blvd., Ste. 109
Littleton, CO 80120

Sterling Ranch

Channel Improvements & Mitigation Plan

Sheet 2

El Paso County, Colorado

Date: 10/3/2015
Project #: 15-001

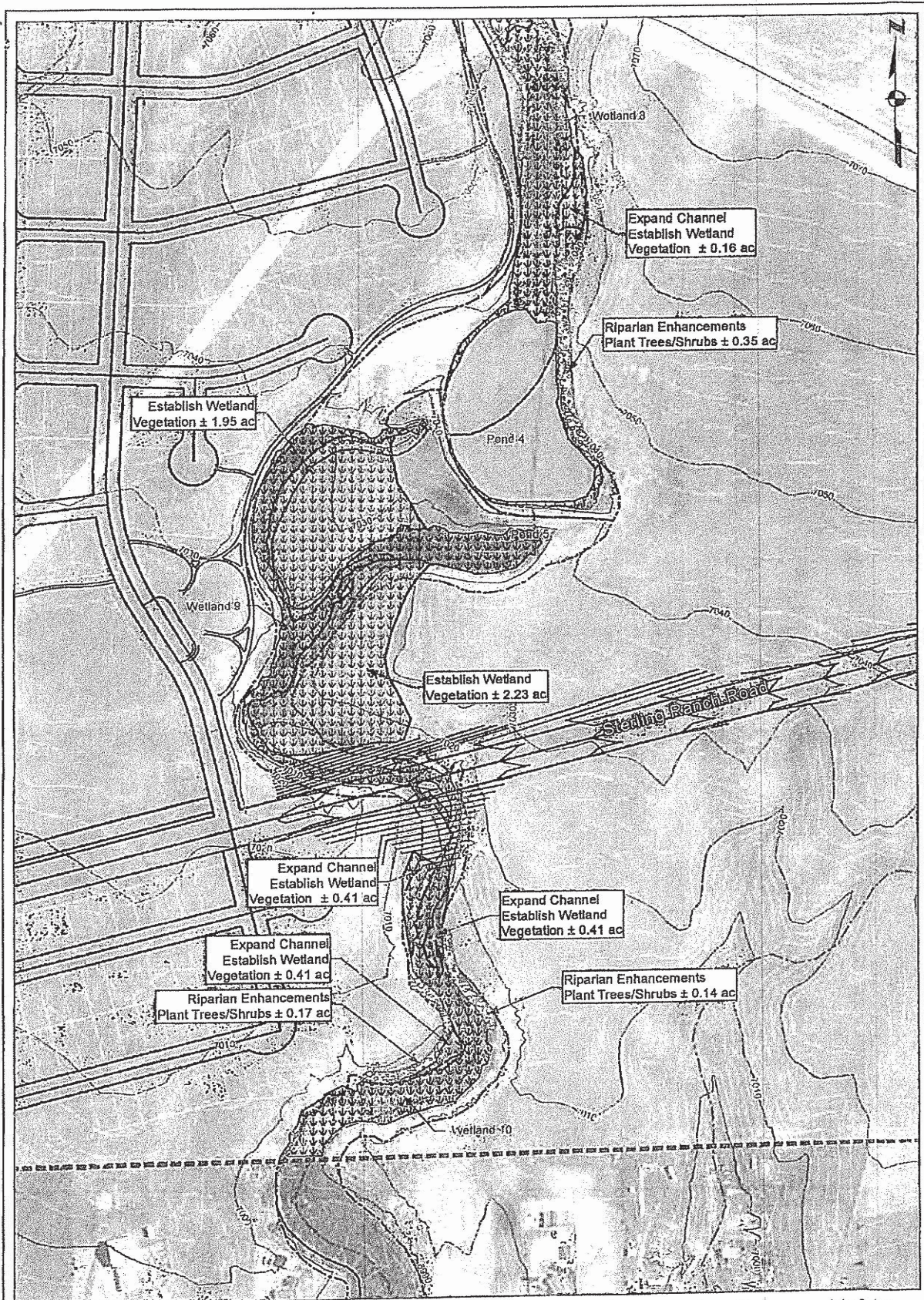

CIVIL ENGINEERING
DEVELOPMENT CONSULTING
LAND SURVEYING
303.703.4444
1950 W. Lindsay Blvd, Ste 109
Littleton, CO 80120

Sterling Ranch

Channel Improvements & Mitigation Plan

Sheet 3

El Paso County, Colorado

Date: 10/13/2015
Project: 15-001



**US Army Corps
of Engineers®**
Albuquerque District
Project

PUBLIC NOTICE

Permit Application No.: SPA-2015-00428-SCO
Project Name: Sterling Ranch Residential
Development Project
Applicant: SR Land, LLC
Waterway: Sand Creek
Public Notice Date: December 9, 2015
Comment Due Date: January 9, 2016
USACE Contact Phone: (719) 543-8102

Reply To:

Southern Colorado Regulatory Office
US Army Corps of Engineers, Albuquerque District
200 South Santa Fe Avenue, Suite 301
Pueblo, Colorado 81003-4270

PERMIT APPLICATION UNDER SECTION 404 OF THE CLEAN WATER ACT (33 USC 1344)

Summary of Proposed Project: We are requesting public comment on the following project before the above comment due date. The application is for a permit to place dredged/fill material into waters of the US associated with the construction of a residential development in Sand Creek and one tributary located near Falcon, El Paso County, Colorado. Details of the proposed project are provided below.

Name of Applicant: SR Land, LLC, 20 Boulder Crescent, Suite 201, Colorado Springs, CO 80903.

Location: The project is located on 1,443.7 acres northeast of the intersection of Black Forest Road and Woodmen Road in unincorporated El Paso County, Colorado. The property is on the United States Geological Survey (USGS) Falcon Quadrangle on portions of Sections 27, 28, 32, 33, and 34 in Township 12 South, Range 65 West and the northwest portion of Section 4, Township 13 South, Range 65 West. The approximate coordinates of the project center are 39.964483 latitude and -104.664944 longitude (WGS 84 datum).

Description of Work: The Sterling Ranch Residential Development Project includes installation of attendant utilities, channel improvements to the main stem of Sand Creek, three off-line stormwater detention ponds, development of two permanent residential access roads and associated culverts, and development of residential units. Permanent impacts to waters of the US will result from construction of the residential access roads and associated culverts, and construction of residential units in the unnamed western

NEWS RELEASE

CESPA-RD-SC
SPA-2015-00428-SCO

tributary to Sand Creek. Total cumulative permanent impacts to waters of the US from the proposed project will total 4.21 acres and 5,048 linear feet within the main channel of Sand Creek and its western tributary.

Purpose and Need: The project purpose is twofold: (1) the development of a medium sized single-family residential development and associated facilities and infrastructure on multiple parcels of land which will be incorporated in the City of Colorado Springs; and (2) creek channel improvements for hydrology and stormwater capability through control of flood water conveyance, establishing improved grade control, and facilitating improved water quality.

Likewise, the project need is twofold: (1) to satisfy market demand for additional housing in the City of Colorado Springs, El Paso County, based on recent County and City economic development reports; and (2) to address a County-wide high-priority stormwater management project while simultaneously managing an increase in stormwater runoff to Sand Creek via channel improvements.

Mitigation: Mitigation for impacts to wetlands and waters of the US on the Sterling Ranch project site is proposed within the Middle Fountain Creek watershed and includes creation of 4.21 acres of emergent wetlands located within and adjacent to the main channel of Sand Creek, with improvements throughout to allow for construction and reestablishment of wetlands.

Plans and Data: Drawings showing the location of the work site and other data are enclosed with this notice. If additional information is desired, it may be obtained from the applicant, or from:

Christopher M. Grosso
U.S. Army Corps of Engineers
Southern Colorado Regulatory Office
200 South Santa Fe Avenue, Suite 301
Pueblo, Colorado 81003-4270
(719) 543-8102
Fax No. (719) 543-9475
E-mail: Christopher.M.Grosso@usace.army.mil

Statement of Findings: The Corps consulted district files and records, the latest version of the National Register of Historic Places (NRHP), and state records of NRHP-eligible and potentially eligible historic properties to determine if there are any historic properties that may be affected by the proposed undertaking. Based on this initial information, the Corps has made a preliminary determination that the proposed project will not affect any historic properties that meet the criteria for inclusion in the NRHP.

The Corps has reviewed the U.S. Fish and Wildlife Service's latest published version of Federally-listed endangered and threatened species located in El Paso County, Colorado to determine if any listed species or their critical habitat may occur in the proposed project area. The Corps has made a preliminary determination that the

NEWS RELEASE

CESPA-RD-SC
SPA-2015-00428-SCO

proposed project will not affect any Federally-listed endangered or threatened species or their critical habitat that are protected by the Endangered Species Act.

The applicant is required to obtain water quality certification, under Section 401 of the Clean Water Act, from the Colorado Department of Public Health and Environment. Section 401 requires that any applicant for an individual Section 404 permit provide proof of water quality certification to the Corps of Engineers prior to permit issuance.

In accordance with environmental procedures and documentation required by the National Environmental Policy Act of 1969, an environmental assessment will be prepared for this project. Upon completion, the assessment may be seen at the U.S. Army Corps of Engineers, Albuquerque District Office, at the address given above.

Comments: Any comments concerning this project should be received by the District Engineer no later than January 9, 2016. Comments received after the end of the Public Notice comment period will not be considered. However, more time may be given if a request, with a valid reason, is received prior to the suspense date. The Corps of Engineers is soliciting comments from the public; federal, state, and local agencies and officials; Indian tribes; and other interested parties in order to consider and evaluate the impacts of this proposed activity. Any comments received will be considered by the Corps of Engineers to determine whether to issue, modify, condition, or deny a permit for this proposal. To make this decision, comments are used to assess impacts on endangered species, historic properties, water quality, general environmental effects, and the other public interest factors listed below. Comments are used in the preparation of an Environmental Assessment and/or an Environmental Impact Statement pursuant to the National Environmental Policy Act. Comments are also used to determine the need for a public hearing and to determine the overall public interest of the proposed activity.

The decision whether to issue a permit will be based on an evaluation of the probable impact, including cumulative impacts, of the proposed activity on the public interest. That decision will reflect the national concern for both protection and utilization of important resources. The benefit which reasonably may be expected to accrue from the proposal must be balanced against its reasonably foreseeable detriments. The evaluation of the impact of this activity will include application of the guidelines promulgated by the Administrator, EPA, under authority of Section 404(b) of the Clean Water Act. All factors relevant to the proposal and the cumulative effects will be considered; among these are conservation, economics, aesthetics, general environmental concerns, wetlands, historic properties, fish and wildlife values, flood hazards, floodplain values, land use, navigation, shore erosion and accretion, recreation, water supply and conservation, water quality, energy needs, safety, food and fiber production, mineral needs, considerations of property ownership, and, in general, the needs and welfare of the people.

If the District Engineer determines that the project complies with the 404(b) (1) guidelines, he will grant the permit unless issuance would be contrary to the public interest.

NEWS RELEASE

CESPA-RD-SC
SPA-2015-00428-SCO

Any person may request a public hearing. The request must be submitted, in writing, to the District Engineer within 21 days of the date of this notice and must clearly set forth the reasons for holding a public hearing.

Patrick J. Dagon
Lieutenant Colonel, U.S. Army
District Commander

Enclosures:

Sheet 1 of 2 – Wetland Location Map

Sheet 2 of 2 – Wetland Impact Location Map

NEWS RELEASE

CESPA-RD-SC
SPA-2015-00428-SCO



COLORADO

Department of Public
Health & Environment

Dedicated to protecting and improving the health and environment of the people of Colorado

February 4, 2016

SR Land, LLC
Attn: Jim Morley
20 Boulder Crescent, Ste. 201
Colorado Springs, CO 80903

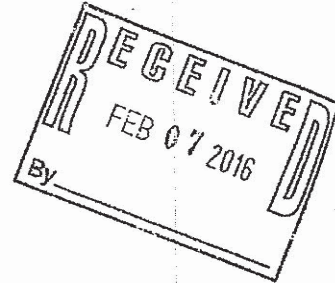

Re: Section 401 Water Quality Certification
Colorado 401 Certification No.: 4378
US Corps of Engineers 404 Permit No.: SPA-2015-00428-SCO
Description: Construction of a residential development
Location: Latitude: 38.962389, Longitude -104.675084 in El Paso County,
Colorado
Watercourse: Sand Creek and tributaries, Arkansas River Basin, Segment
COARFO04 of Fountain Creek Sub-basin
Designation: Use Protected

Dear Mr. Morley:

The Colorado Department of Public Health and Environment (CDPHE), Water Quality Control Division (Division) has completed its review of the subject Clean Water Act (CWA) Section 404 Permit Application, and our preliminary determination with the issuance of the State of Colorado 401 Certification Public Notice (5 CCR 1002-82.5(B)). This segment is designated "Use Protected" thus no antidegradation review is required (5 CCR 1002-31.8(2)).

This letter shall serve as official notification that the Division is issuing "Regular Certification" in accordance with 5 CCR 1002-82.5(A)(2).

The 401 Certification issued by the Division pursuant to 5 CCR 1002-82.3(C) shall apply to both the construction and operation of the project for which a federal license or permit is required, and shall apply to the water quality impacts associated with the project. This certification does not constitute a relinquishment of the Division's authority as defined in the Colorado Water Quality Control Act, nor does it fulfill or waive any other local, state, or federal regulations.



February 4, 2016
SR Land, LLC
Page 2

If you have any questions or need additional information, please contact me at
(303) 692-3586.

Sincerely,

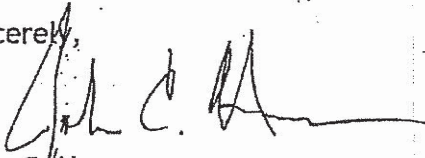

John C. Hranac
Water Quality Assessor
Environmental Data Unit
Water Quality Control Division

Attachment

cc: US Army Corps of Engineers, Southern Colorado Regulatory Office
Applicant's Agent, Mr. Chris Haas - CORE Consultants, Inc.
File

Certification Requirements:

(A) The following requirements shall apply to all certifications:

- (1) Authorized representatives from the Division shall be permitted to enter upon the site where the construction activity or operation of the project is taking place for purposes of inspection of compliance with BMPs and certification conditions.
- (2) In the event of any changes in control or ownership of facilities where the construction activity or operation of the project is taking place, the successor shall be notified in writing by his predecessor of the existence of the BMPs and certification conditions. A copy of such notification shall be provided to the Division.
- (3) If the permittee discovers that certification conditions are not being implemented as designed, or if there is an exceedance of water quality standards despite compliance with the certification conditions and there is reason to believe that the exceedance is caused, in whole or in part, by the project, the permittee shall verbally notify the Division of such failure or exceedance within two (2) working days of becoming aware of the same. Within ten (10) working days of such notification, the permittee shall provide to the Division, in writing, the following:
 - (a) In the case of the failure to comply with the certification conditions, a description of (i) the nature of such failure, (ii) any reasons for such failure, (iii) the period of non-compliance, and (iv) the measures to be taken to correct such failure to comply; and
 - (b) In the case of the exceedance of a water quality standard, (i) an explanation, to the extent known after reasonable investigation, of the relationship between the project and the exceedance, (ii) the identity of any other known contributions to the exceedance, and (iii) a proposal to modify the certification conditions so as to remedy the contribution of the project to the exceedance.
- (4) Any anticipated change in discharge location and/or quantities associated with the project which may result in water quality impacts not considered in the original certification must be reported to the Division by submission of a written notice by the permittee prior to the change. If the change is determined to be significant, the permittee will be notified within ten days, and the change will be acknowledged and approved or disapproved.
- (5) Any diversion from or bypass of facilities necessary to maintain compliance with the terms and conditions herein is prohibited, except (i) where unavoidable to prevent loss of life or severe property damage, or (ii) where excessive storm drainage or runoff would damage any facilities necessary for compliance with limitations and prohibitions herein. The Division shall be notified immediately in writing of each such diversion or bypass.

- (6) At least fifteen days prior to commencement of a project in a watercourse, which the Division has certified, or conditionally certified, the permittee shall notify the following:

- (a) Applicable local health departments;
- (b) Owners or operators of municipal and domestic water treatment intakes which are located within twenty miles downstream from the site of the project; and
- (c) Owners or operators of other intakes or diversions which are located within five miles downstream from the site of the project.

The permittee shall maintain a list of the persons and entities notified, including the date and form of notification.

- (7) Immediately upon discovery of any spill or other discharge to waters of the state not authorized by the applicable license or permit, the permittee shall notify the following;

- (a) Applicable local health departments;
- (b) Owners or operators of municipal and domestic water treatment intakes which are located within twenty miles downstream from the site of the project; and
- (c) Owners or operators of other intakes or diversions which are located within five miles downstream from the site of the project.

The permittee shall maintain a list of the persons and entities notified, including the date and form of notification.

- (8) Construction operations within watercourses and water bodies shall be restricted to only those project areas specified in the federal license or permit.
- (9) No construction equipment shall be operated below the existing water surface unless specifically authorized by the 401 certification issued by the Division.
- (10) Work should be carried out diligently and completed as soon as practicable. To the maximum extent practicable, discharges of dredged or fill material shall be restricted to those periods when impacts to designated uses are minimal.
- (11) The project shall incorporate provisions for operation, maintenance, and replacement of BMPs to assure compliance with the conditions identified in this section, and any other conditions placed in the permit or certification. All such provisions shall be identified and compiled in an operation and maintenance plan which will be retained by the project owner and available for inspection within a reasonable timeframe upon request by any authorized representative of the Division.

- (12) The use of chemicals during construction and operation shall be in accordance with the manufacturers' specifications. There shall be no excess application and introduction of chemicals into state waters.
 - (13) All solids, sludges, dredged or stockpiled materials and all fuels, lubricants, or other toxic materials shall be controlled in a manner so as to prevent such materials from entering state waters.
 - (14) All seed, mulching material and straw used in the project shall be state-certified weed-free.
 - (15) Discharges of dredged or fill material in excess of that necessary to complete the project are not permitted.
 - (16) Discharges to state waters not identified in the license or permit and not certified in accordance therewith are not allowed, subject to the terms of any 401 certification.
 - (17) Except as otherwise provided pursuant to subsection 82.7(C), no discharge shall be allowed which causes non-attainment of a narrative water quality standard identified in the Basic Standards and Methodologies for Surface Waters, Regulation #31 (5 CCR 1002-31), including, but not limited to discharges of substances in amounts, concentrations or combinations which:
 - (a) Can settle to form bottom deposits detrimental to beneficial uses; or
 - (b) Form floating debris, scum, or other surface materials sufficient to harm existing beneficial uses; or
 - (c) Produce color, odor, or other conditions in such a degree as to create a nuisance or harm existing beneficial uses or impart any undesirable taste to significant edible aquatic species, or to the water; or
 - (d) Are harmful to the beneficial uses or toxic to humans, animals, plants, or aquatic life; or
 - (e) Produce a predominance of undesirable aquatic life; or
 - (f) Cause a film on the surface or produce a deposit on shorelines.
- (B) Best Management Practices:
- (1) Best management practices are required for all projects for which Division certification is issued except for section 402 permits. Project applicants must select BMPs to be employed in their project. A listing and description of best management practices is located in Appendix I of Regulation No. 82: 401 Certification Regulation 5 CCR 1002-82.
 - (2) All requests for certifications which require BMPs shall include a map of project location, a site plan, and a listing of the selected BMPs chosen for the project. At a minimum, each project must provide for the following:

- (a) Permanent erosion and sediment control measures that shall be installed at the earliest practicable time consistent with good construction practices and that shall be maintained and replaced as necessary throughout the life of the project.
- (b) Temporary erosion and sediment control measures that shall be coordinated with permanent measures to assure economical, effective, and continuous control throughout the construction phase and during the operation of the project.