

V3_Final Plat Drawings.pdf Markup Summary

1 (10)

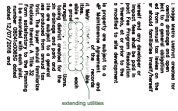

Subject: Planner
Page Label: 1
Author: Kylie Bagley
Date: 1/23/2026 8:34:10 AM
Status:
Color: ■
Layer:
Space:

extending utilities

Corrected Spelling



Subject: Planner
Page Label: 1
Author: Kylie Bagley
Date: 1/23/2026 8:34:32 AM
Status:
Color: ■
Layer:
Space:

Insert providers name

added
MVEA



Subject: Planner
Page Label: 1
Author: Kylie Bagley
Date: 1/23/2026 8:35:26 AM
Status:
Color: ■
Layer:
Space:

fema?

FEMA is the regulatory agency and their maps are FIRM maps, identification has been changed

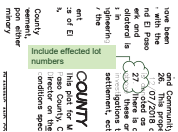

Subject: Planner
Page Label: 1
Author: Kylie Bagley
Date: 1/23/2026 8:36:30 AM
Status:
Color: ■
Layer:
Space:

Include effected lot numbers

added lot
numbers

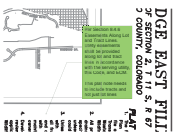

Subject: Planner
Page Label: 1
Author: Kylie Bagley
Date: 1/23/2026 1:36:29 PM
Status:
Color: ■
Layer:
Space:

and tract lines in accordance with the serving utility, this Code, and ECM.

added PUE to tracts along Misty Acres

This plat note needs to include tracts and not just lot lines



Subject: Planner
Page Label: 1
Author: Kylie Bagley
Date: 1/23/2026 1:41:32 PM
Status:
Color: ■
Layer:
Space:

Per 7.2.5 Tracts that are common open space for the subdivision shall be labeled "Common Area Tract" followed by a consecutive letter designation beginning with "A"

Modified tract table heading to state common area tract

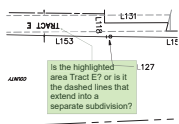

Subject: Planner
Page Label: 2
Author: Kylie Bagley
Date: 1/23/2026 1:09:56 PM
Status:
Color: ■
Layer:
Space:

Is the highlighted area Tract E? or is it the dashed lines that extend into a separate subdivision?

added linetype legend to help clarify this is part of tract E

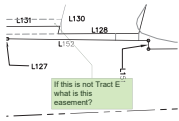

Subject: Planner
Page Label: 2
Author: Kylie Bagley
Date: 1/23/2026 1:10:07 PM
Status:
Color: ■
Layer:
Space:

If this is not Tract E, what is this easement?

added linetype legend to help clarify this is part of tract E

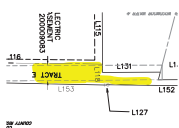

Subject: Highlight
Page Label: 2
Author: Kylie Bagley
Date: 1/23/2026 1:10:26 PM
Status:
Color: ■
Layer:
Space:

dashed line indicates existing MVEA easement

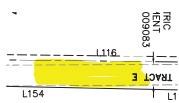

Subject: Highlight
Page Label: 2
Author: Kylie Bagley
Date: 1/23/2026 1:10:33 PM
Status:
Color: ■
Layer:
Space:

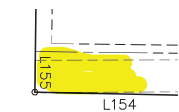

Subject: Highlight
Page Label: 2
Author: Kylie Bagley
Date: 1/23/2026 1:10:41 PM
Status:
Color: ■
Layer:
Space:

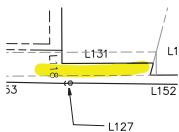

Subject: Highlight
Page Label: 2
Author: Kylie Bagley
Date: 1/23/2026 1:11:04 PM
Status:
Color: ■
Layer:
Space:

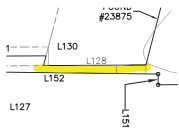

Subject: Highlight
Page Label: 2
Author: Kylie Bagley
Date: 1/23/2026 1:11:14 PM
Status:
Color: ■
Layer:
Space:

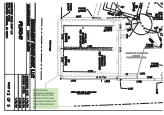

Subject: Planner
Page Label: 2
Author: Kylie Bagley
Date: 1/23/2026 1:11:33 PM
Status:
Color: ■
Layer:
Space:

Show access easement between lots 36 and 37 and how the 30' access easement comes off Tract O and into lot 36

access easement across tract o (now tract K) is in benefit of woodmoor to access the utility facilities

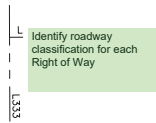

Subject: Plan
Page Label: 2
Author: Kylie Bagley
Date: 1/23/2026 2:00:04 PM
Status:
Color: ■
Layer:
Space:

Identify roadway classification for each Right of Way

add note 19 for roadway classifications



Subject: Planner
Page Label: 2
Author: Kylie Bagley
Date: 1/23/2026 2:05:15 PM
Status:
Color: ■
Layer:
Space:

Include a legend of the line work

added a legend of monuments and linetypes

3 (4)

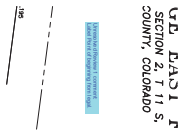

Subject: Text Box
Page Label: 3
Author: CDurham
Date: 1/27/2026 9:49:37 AM
Status:
Color: ■
Layer:
Space:

Unresolved Review 1 comment:
 Label Point of beginning from legal.

changed the label POB to Point of Beginning

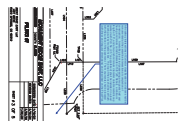

Subject: Callout
Page Label: 3
Author: CDurham
Date: 1/27/2026 9:50:15 AM
Status:
Color: ■
Layer:
Space:

All roadway intersections of Collector classification and above shall be monumented at the centerline intersection at completion of construction. A metallic pipe or rod possessing a magnetic field and having a minimum outside diameter of 5/8" (#5 Rebar), a minimum length of 18", and a two-inch minimum diameter durable metallic cap marked with PLS No. (2.5" cap preferred) shall be installed in a load bearing survey monument box. The top of the box shall be set flush with the surface of the pavement. The monuments shall be located (with linear and angular dimensions) and described on the Final Plat.

added monument symbol to the legend and shown on Misty acres

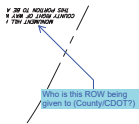

Subject: Callout
Page Label: 3
Author: CDurham
Date: 1/27/2026 1:15:38 PM
Status:
Color: ■
Layer:
Space:

Who is this ROW being given to (County/CDOT?)

right of way abandonment shall be owned and maintained by Monument Ridge metro district

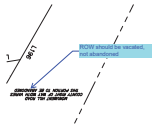

Subject: Callout
Page Label: 3
Author: CDurham
Date: 1/27/2026 1:15:49 PM
Status:
Color: ■
Layer:
Space:

ROW should be vacated, not abandoned

4 (2)



Subject: Planner
Page Label: 4
Author: Kylie Bagley
Date: 1/23/2026 1:50:13 PM
Status:
Color: ■
Layer:
Space:

There is already a tract 2

tract 2 label has been removed

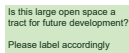

Subject: Planner
Page Label: 4
Author: Kylie Bagley
Date: 1/23/2026 1:50:48 PM
Status:
Color: ■
Layer:
Space:

Is this large open space a tract for future development?

Please label accordingly

added tract 2 label

5 (2)

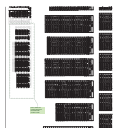

Subject: Planner
Page Label: 5
Author: Kylie Bagley
Date: 1/23/2026 8:48:30 AM
Status:
Color: ■
Layer:
Space:

Lots 7 and 8 are missing. Revise to show accurate number of lots

lots have been renumbered

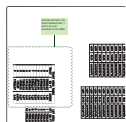

Subject: Planner
Page Label: 5
Author: Kylie Bagley
Date: 1/23/2026 1:49:25 PM
Status:
Color: ■
Layer:
Space:

Include all tracts, the tracts labeled tract 1 and 2 are not included in this table

added tracts 1 & 2 to table