

EL PASO COUNTY

PLANNING AND COMMUNITY DEVELOPMENT DEPARTMENT
2880 INTERNATIONAL CIRCLE, SUITE 110
COLORADO SPRINGS, CO 80910



FUJIKAWA JOJIE B
5435 STANDARD DR
COLORADO SPRINGS CO 80922-2377

NIXIE 808 FE 1 8811/1

RETURN TO SENDER
ATTEMPTED - NOT KNOWN
UNABLE TO FORWARD

9325000063543486

ANK

BC: 80910314835 *0520-02852-

80910>3148
8092232377 C



EL PASO COUNTY
COLORADO

COMMISSIONERS:
MARK WALLER (CHAIR)
LONGINOS GONZALEZ, JR. (VICE-CHAIR)

HOLLY WILLIAMS
STAN VANDERWERF
CAMI BREMER

PLANNING AND COMMUNITY DEVELOPMENT DEPARTMENT
CRAIG DOSSEY, EXECUTIVE DIRECTOR

11/5/2020

RE: 1095 Western Dr – Administrative Relief

File: ADR-20-015
Parcel ID No.: 5408003013

To Whom It May Concern:

This letter is to inform property owners adjacent to The Springs Mobile Home Park that the applicant, The Springs Community, has requested approval of an application for administrative relief to allow a building separation of 16 feet where 20 feet is required for two (2) spaces in the MHP zoning district.

The Planning and Community Development Director may make a formal decision regarding the administrative relief application on 11/19/2020. Any comments or questions may be forwarded to me prior to that decision. Administrative approval by the Planning and Community Development Director is subject to the appeal provisions of the Land Development Code.

You may view the application documents online at www.epcdevplanreview.com. Please feel free to contact me with any questions, comments, or concerns you may have prior to the decision.

Respectfully,

Ryan Howser, AICP, Planner I
El Paso County Planning and Community Development
719-520-6049
ryanhowser@elpasoco.com

2880 INTERNATIONAL CIRCLE, SUITE 110
PHONE: (719) 520-6300



COLORADO SPRINGS, CO 80910-3127
FAX: (719) 520-6695

WWW.ELPASOCO.COM

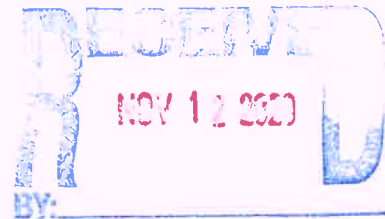

El Paso County - Colorado
1095 WESTERN DR

Market Value
\$5,750,000

No Photo Available



5408003013
SPRINGS
MOBILE
HOME
PARK
LLC

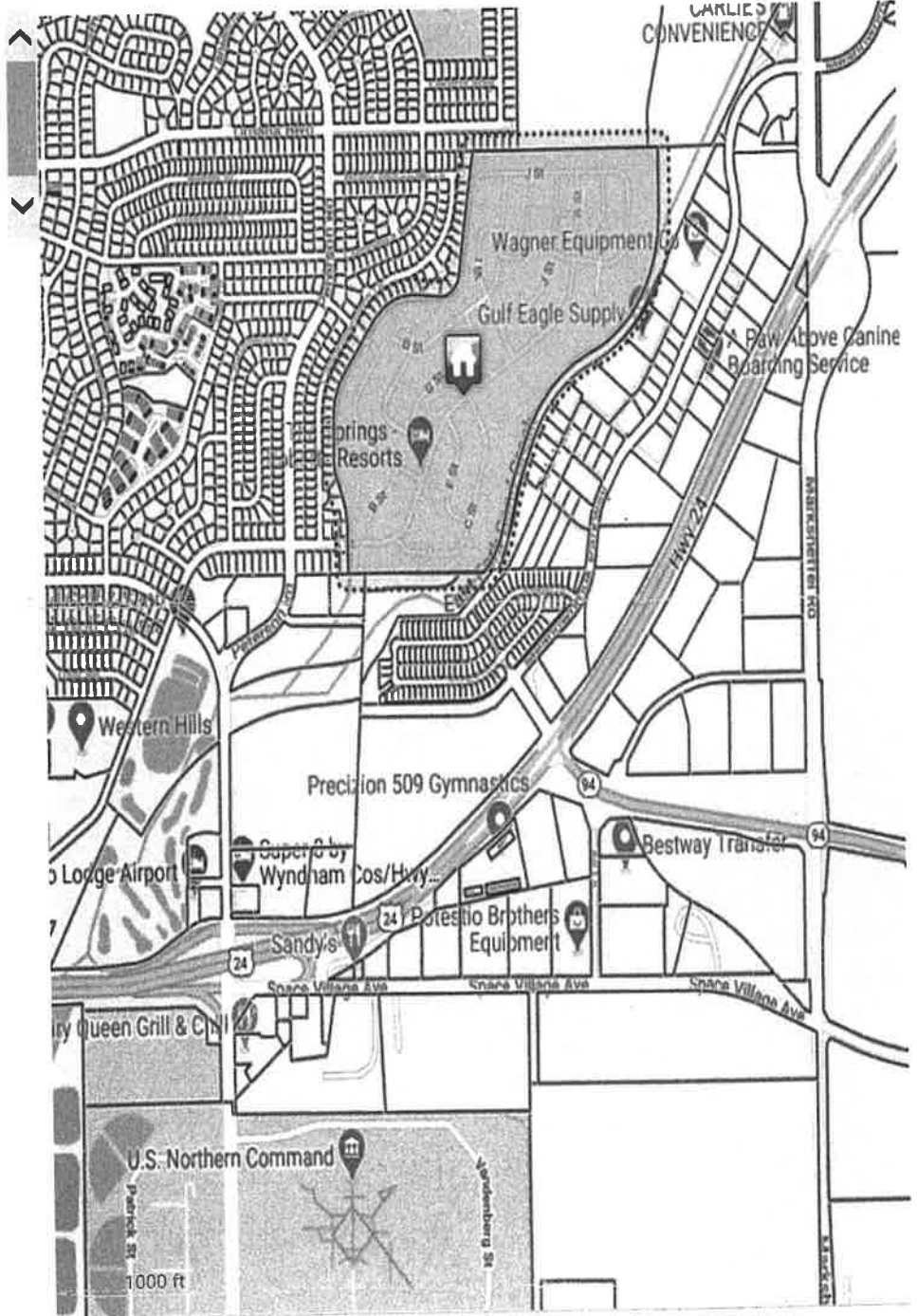

Disclaimer

We have made a good-faith effort to provide you with the most recent and most accurate information available. However, if you need to use this information in any legal or official venue, you will need to obtain official copies from the Assessor's Office. Do be aware that this data is subject to change on a daily basis. If you believe that any of this information is incorrect, please call us at (719) 520-6600.