

NOTICE OF PUBLIC HEARING(S) *COPY/MATERIAL 8/14/21*

This notice provides options to access to the Planning Commission and Board of County Commissioners' hearings on the following Quasi-Judicial land use matter. **The item is scheduled for the Thursday, August 19, 2021 Planning Commission beginning at 1:00 p.m. and the Tuesday, September 14, 2021 Board of County Commissioners' hearing beginning at 9:00 a.m. located in the Centennial Hall Hearing Room located at 200 S. Cascade Avenue, Colorado Springs.**

P-21-003

RIVAS

**MAP AMENDMENT (REZONE)
SECLUSION**

A request by Norwood Foundation for approval of a map amendment (rezoning) of 313.774 acres from PUD (Planned Unit Development District) to RR-5 (Residential Rural District). The two (2) parcels are located west of Goodson Road and 1.1 miles northwest of the Meridian Road and Ayer Road intersection and are within Sections 11 and 14, Township 12 South, Range 65 West of the 6th P.M. The property is located within the Black Forest Comprehensive Plan. (Parcel Nos. 52110-00-002 and 52140-00-011) (Commissioner District Nos. 1 and 2)

Type of Hearing: Quasi-Judicial

Planner: Mercedes Rivas (MercedesRivas@elpasoco.com)

El Paso County is committed to full access and transparency while the community works through the COVID-19 crisis. That also means balancing public safety and keeping essential parts of County government open for business. Here are the ways you can participate in quasi-judicial land-use items coming up before the Planning Commission and the Board of County Commissioners:

Watch the Live Hearings Remotely

If you are interested in watching the Planning Commission or Board of County Commissioners' hearing live, please go to <https://cloud.castus.tv/vod/elpasoco/video> at the scheduled time of the hearing. Staff will be monitoring the County's Live feed, so please feel free to ask questions or provide any comments you might have; however, any testimony you wish to provide must be done by following the "Participate Remotely" procedures listed below.

Participate Remotely

If you would like to provide testimony on an item being heard by the Planning Commission or the Board of County Commissioners, please email Elena Krebs at ElenaKrebs@elpasoco.com with your name and the best phone number to be reached at and include any documents you would like provided to the hearing body as part of the official record. **NOTE: New exhibits are not permitted via email the day of hearing. All exhibits must be emailed to Ms. Krebs no later than one day prior to each of the above listed hearings.**

A list of individuals wishing to testify will be provided to the Chair in advance of the meeting. When it's time for public testimony on the item you'd like to testify on, you will receive a phone call at the number you provided and will be brought into the meeting remotely so you can address the hearing body.

El Paso County Parcel Information

PARCEL	NAME
5211000002	NORWOOD FOUNDATION
5214000011	NORWOOD FOUNDATION

File Name: P-21-003

Zone Map No. --

Date: August 4, 2021

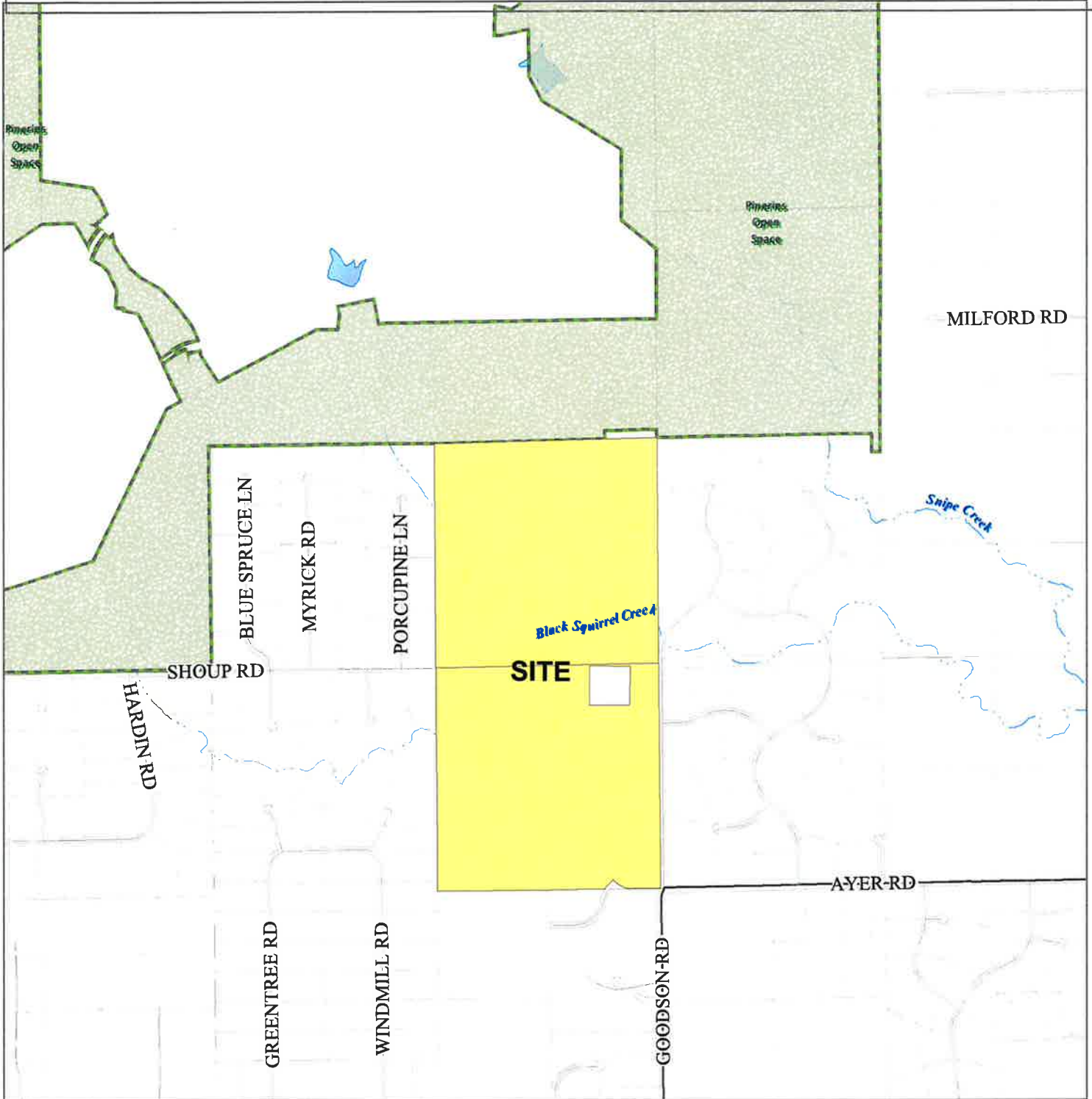

Please report any parcel discrepancies to:
 El Paso County Assessor
 1675 W. Garden of the Gods Rd.
 Colorado Springs, CO 80907
 (719) 520-6600



COPYRIGHT 2018 by the Board of County Commissioners, El Paso County, Colorado. All rights reserved. No part of this document or data contained hereon may be reproduced, used to prepare derivative products, or distributed without the specific written approval of the Board of County Commissioners, El Paso County, Colorado. This document was prepared from the best data available at the time of printing. El Paso County, Colorado, makes no claim as to the completeness or accuracy of the data contained hereon.

5212002006
APODACA STEPHANIE L
12872 GOODSON RD
COLORADO SPRINGS, CO 80908

5212003004
APPLEYARD JAMES H JR
1101 GREEN WOOD GLEN
EDMOND, OK 73025

5214001001
BRODSKY FRANKLIN
10265 SHOUP RD
COLORADO SPRINGS, CO 80908

5212002005
COLEMAN JOHN E
12812 GOODSON RD
COLORADO SPRINGS, CO 80908

5211002001
COLMENARES GUSTAVO
12585 PORCUPINE LN
COLORADO SPRINGS, CO 80908

5212002004
CRIST DONALD H
12752 GOODSON RD
COLORADO SPRINGS, CO 80908

5212002001
DAVIDSON REVOCABLE TRUST
12512 GOODSON RD
COLORADO SPRINGS, CO 80908

5214000012
DEVELOPMENT MANAGEMENT CO INC
111 S TEJON ST STE 222
COLORADO SPRINGS, CO 80903

5214000004
DUBOIS FAMILY TRUST
11985 WINDMILL RD
COLORADO SPRINGS, CO 80908

5213002001
GIFFORD TYLER
10810 YOEMANS PARK DR
COLORADO SPRINGS, CO 80908

5214001026
GOODRICH OLETA M
11915 WINDMILL RD
COLORADO SPRINGS, CO 80908

5213004001
GREELEY MARK J LIVING TRUST
10805 YOEMANS PARK DR
COLORADO SPRINGS, CO 80908

5211002003
GREENLEE ANNE D
12725 PORCUPINE LN
COLORADO SPRINGS, CO 80908

5213004008
HARRIS THOMAS M
10805 HAT CREEK PL
COLORADO SPRINGS, CO 80908

5213000003
HOLT LAUREN E
4989 CHERRY SPRINGS DR
COLORADO SPRINGS, CO 80923

5214001023
KIRK ROBERT J
12125 WINDMILL LN
COLORADO SPRINGS, CO 80908

5214001022
MCMULLEN STEPHANIE
3819 TOP SAIL DR
COLORADO SPRINGS, CO 80918

5214000006
MOUNTAIN VIEW ELECTRIC ASSOC INC
11140 E WOODMEN RD
PEYTON, CO 80831

5214000011
NORWOOD FOUNDATION
111 S TEJON #222
COLORADO SPRINGS, CO 80903

5212002002
REESER JASON CHARLES
12572 GOODSON RD
COLORADO SPRINGS, CO 80908

5214003001
RUSSELL MATTHEW T
11810 GOODSON RD
COLORADO SPRINGS, CO 80908

5200000370
SAN MIGUEL VALLEY CORP
7800 E DORADO PLACE STE 250
ENGLEWOOD, CO 80111

5213004002
SINTAS ARTHUR B
10875 YOEMANS PARK DR
COLORADO SPRINGS, CO 80908

5214001024
SMITH GAVIN E
12035 WINDMILL RD
COLORADO SPRINGS, CO 80908

5212002003
SYLVESTER JAMES R
16555 REMINGTON RD
COLORADO SPRINGS, CO 80908

5213004007
TAYLOR DONALD R
10810 HAT CREEK PL
COLORADO SPRINGS, CO 80908

5213004005
TRUDELL MARK
10880 HAT CREEK PL
COLORADO SPRINGS, CO 80908

5211002004
VAN SLYKE ANGELA K
12815 PORCUPINE LN
COLORADO SPRINGS, CO 80908

5211002002
WESTBROOK BRYAN J
12615 PORCUPINE LN
COLORADO SPRINGS, CO 80908

5214001012
WILKINS STEPHEN G
12185 WINDMILL LN
COLORADO SPRINGS, CO 80908