

ELECTRICAL SITE PLAN

1/16" = 1'-0"



KEYED NOTES

- LOCATION OF UTILITY METER DISCONNECT SWITCH AND CT CABINET. REFER TO "RISER DIAGRAM" ON SHEET E3.01.
- PROVIDE 120V ELECTRICAL CONNECTION WITH (2) #8 & (1) #8G. IN 2" PVC ROUTED BELOW GRADE FOR DRIVE-THRU BACKLIT MENU BOARD PER MANUFACTURER'S INSTRUCTIONS. CONDUIT SHALL COME UP IN CENTER OF POST. SIGN COMPANY REPRESENTATIVE TO GIVE EXACT LOCATIONS/DIMENSIONS FOR GC TO MATCH. CONTRACTOR SHALL REPAIR EXISTING PARKING SURFACES FROM TRENCHING TO MATCH PREVIOUS CONDITIONS.
- PROVIDE 120V ELECTRICAL CONNECTION WITH (2) #8 & (1) #8G. IN 2" PVC ROUTED BELOW GRADE FOR NEW MONUMENT SIGN PER REPRESENTATIVE PRIOR TO ROUGH-IN. CONTRACTOR SHALL REPAIR EXISTING PARKING SURFACES FROM TRENCHING TO MATCH PREVIOUS CONDITIONS.
- NOT USED.
- LOCATION OF CABLE INTERNET DEMARC
- PROVIDE 2" CONDUIT W/ PULL STRING 24" BEHIND MENU BOARD TO CHRISTY BOX FOR FUTURE DIGITAL MENU BOARD UPGRADE. COORDINATE W/ SIGN MANUFACTURER.
- PROVIDE 2" CONDUIT W/ PULL STRING TO CHRISTY BOX BETWEEN "CHOOSE LANE" DIRECTIONAL SIGNAGE AND CLEARANCE BAR FOR FUTURE DRIVE THRU SENSORS.

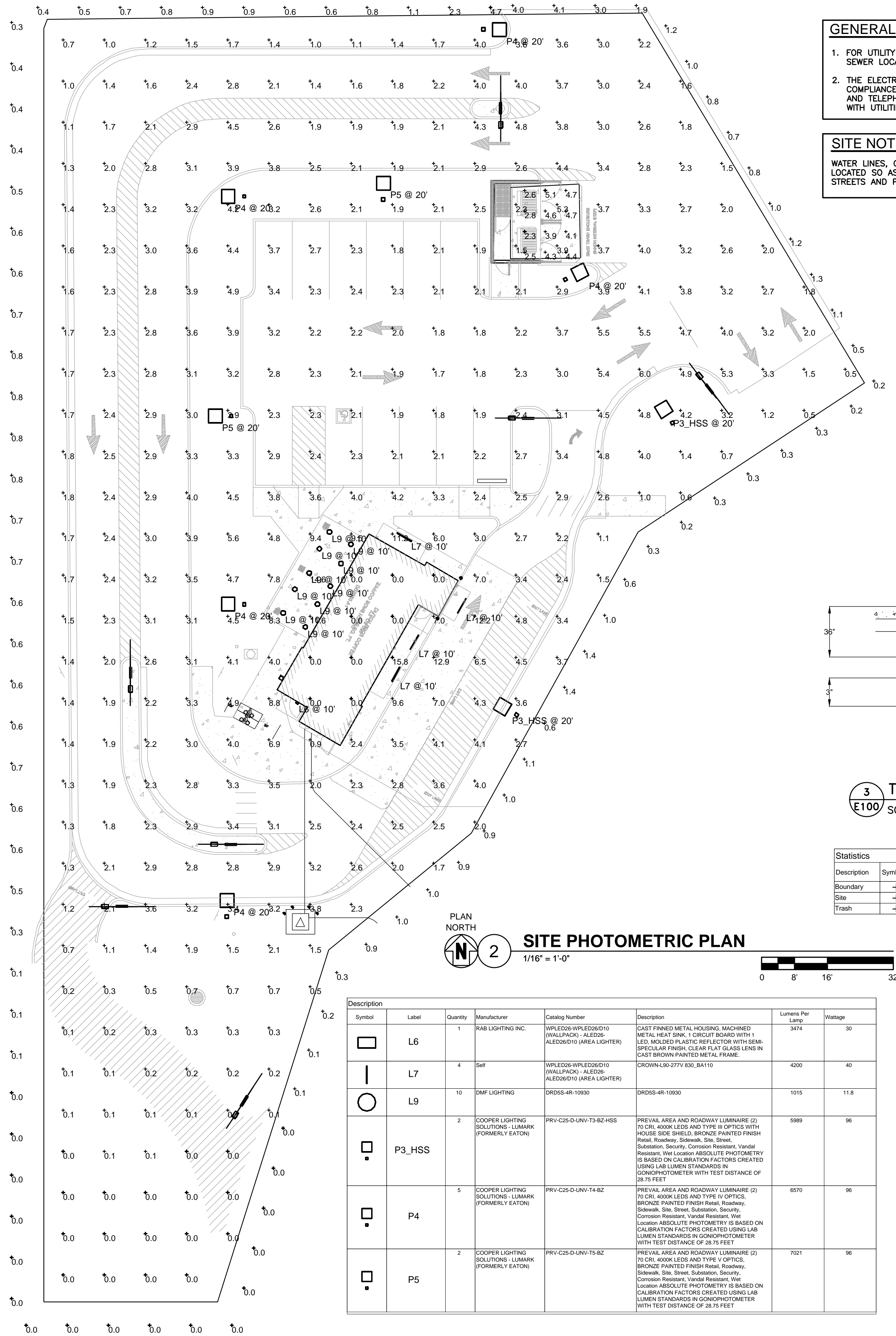

GENERAL NOTES

- FOR UTILITY TRANSFORMER, TELEPHONE SERVICE, GAS, WATER, AND SANITARY SEWER LOCATIONS; SEE CIVIL SITE PLAN.
- THE ELECTRICAL CONTRACTOR IS RESPONSIBLE FOR COORDINATION AND COMPLIANCE WITH ALL UTILITY COMPANIES REQUIREMENTS. INCOMING POWER AND TELEPHONE SERVICES IS EXISTING TO REMAIN. VERIFY REQUIREMENTS WITH UTILITIES PRIOR TO INSTALLATION.

SITE NOTES

WATER LINES, CONDUITS FOR ELECTRICAL, OR OTHER UTILITIES SHALL BE LOCATED SO AS TO NOT CONFLICT WITH REQUIRED TREE LOCATIONS FOR STREETS AND PARKING LOTS.

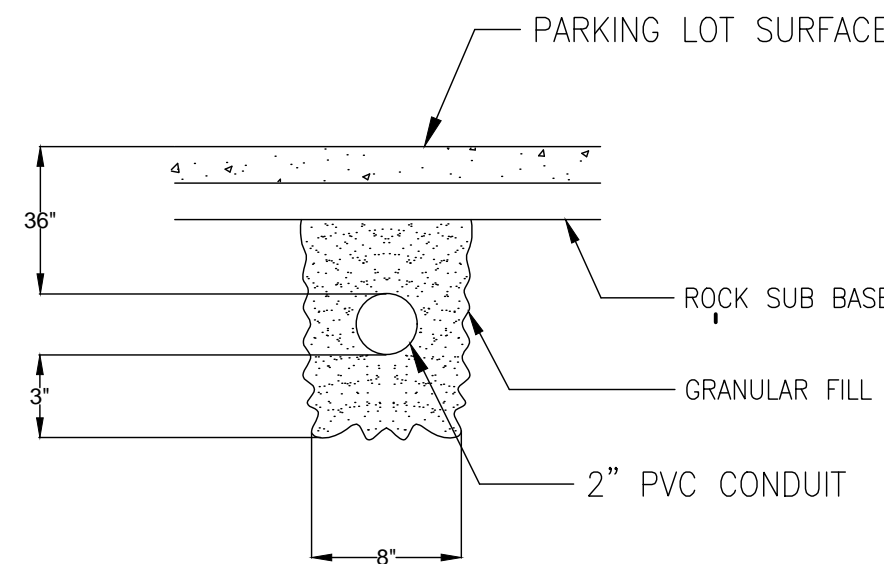

3 TRENCHING DETAIL

E100 SCALE: N.T.S.

Statistics							
Description	Symbol	Avg	Max	Min	Max/Min	Avg/Min	
Boundary	+	0.7 fc	4.7 fc	0.0 fc	N/A	N/A	
Site	+	2.7 fc	15.8 fc	0.0 fc	N/A	N/A	
Trash	+	3.8 fc	5.1 fc	2.3 fc	2.2:1	1.7:1	

CASE
Engineering Inc.

796 Merus Court
St. Louis, MO 63026

T 636.349.1600
F 636.349.1730



1001 SE SANDY BLVD. SUITE 100
PORTLAND, OR 97214
V. 503.552.9079
F. 503.241.7055
WWW.GNICHARCH.COM

01.27.2022



Project No: CO-0707

Dutch Bros Coffee - New Freestanding Store
7510 Falcon Market Place
Peyton, CO 80831
For: Dutch Bros Coffee
110 SW 4th Street
Grants Pass, OR 97526

DB2550-A1

ISSUED FOR PERMIT
REVIEW:
08.20.2021

REV.	DATE	DESCRIPTION
1	12/20/21	OWNER COMMENTS
2	01/27/22	REVISION 02

SHEET NAME:

ELECTRICAL
SITE & PHOTOMETRIC
PLAN

SHEET NUMBER:

E0.01



SLM : LED SLIM PANEL

DESCRIPTION

- Acrylic (PMMA) lightguide for superior performance, UV resistance, anti-yellowing, and lumen maintenance
- Ultra slim modern design with smooth uniform lens
- Edge-lit design provides impressive visual comfort and uniform illumination
- One for one alternative LED solution to fluorescent troffers
- Thin profile is ideal for shallow plenum spaces
- Up to 47% energy savings and up to 2½ times longer life (compared to traditional fluorescent troffers)
- Features integral earthquake clips
- Available in 1'x4', 2'x2' and 2'x4'
- Fits standard T-bar and narrow grid drop ceilings

LISTINGS

- UL Listed for dry/damp locations
- IC Rated for insulation contact
- DesignLights Consortium® Qualified - meets DLC requirements for efficacy and lumen maintenance
- Select versions DesignLights Consortium® Premium Qualified - meets the requirements for the highest DLC qualification for efficacy and lumen maintenance

LED CHARACTERISTICS

- Rated lifetime L70: 50,000 hours
- 3500K, 4000K, 5000K CCT
- CRI: 80+
- 1'x4': 3750lm @ 30W
- 2'x2': 3000-5000lm @ 30/40W
- 2'x4': 4000-6250lm @ 40/50W

ELECTRICAL

- Input voltage: 120-277V
- Dimmable power supply (0-10V)
- Power Factor: >90
- THD: <15%

CONSTRUCTION

- -4°F to 104°F (-20°C to +40°C) operating temperature

WARRANTY

- 5 year limited warranty; see eiko.com for warranty details

project name	type
catalog number	
comments	voltage
approved by	date

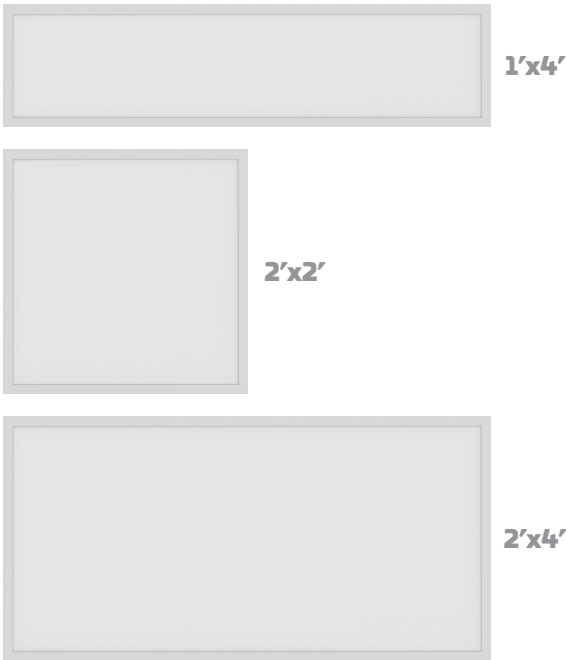

APPLICATIONS

- Conference rooms
- Retail
- Offices
- Hospitality
- Healthcare
- Schools
- Reception areas
- Corridors
- Foyer



ORDERING INFORMATION

EXAMPLE: SLM22-3C-40K-U

Model	Size	Package	CCT	Voltage
SLM : LED Slim Panel	14 - 1'x4' 22 - 2'x2' 24 - 2'x4'	3CB - 30W; 3,000 lm 4CB - 30W; 3,750 lm / 40W; 4,000 lm 5CB - 40W; 5,000 lm 6CB - 50W; 6,250 lm	35K - 3500K 40K - 4000K 50K - 5000K	U - 120-277V

PERFORMANCE SUMMARY

Order Code	Item #	Watts	Lumens	LPW	CCT	CRI	Volts	Dimming	DLC
10015	SLM22-3CB-35K-U	30W	3,000	100	3500K	80+	120-277V	0-10V	✓
10016	SLM22-3CB-40K-U	30W	3,000	100	4000K	80+	120-277V	0-10V	✓
10017	SLM22-3CB-50K-U	30W	3,000	100	5000K	80+	120-277V	0-10V	✓
10018	SLM24-4CB-35K-U	40W	4,000	100	3500K	80+	100-277V	0-10V	✓
10019	SLM24-4CB-40K-U	40W	4,000	100	4000K	80+	100-277V	0-10V	✓
10021	SLM24-4CB-50K-U	40W	4,000	100	5000K	80+	100-277V	0-10V	✓
09760	SLM14-4CB-35K-U	30W	3,750	125	3500K	80+	100-277V	0-10V	✓✓
09761	SLM14-4CB-40K-U	30W	3,750	125	4000K	80+	100-277V	0-10V	✓✓
09762	SLM14-4CB-50K-U	30W	3,750	125	5000K	80+	100-277V	0-10V	✓✓
09763	SLM22-4CB-35K-U	30W	3,750	125	3500K	80+	100-277V	0-10V	✓✓
09764	SLM22-4CB-40K-U	30W	3,750	125	4000K	80+	100-277V	0-10V	✓✓
09765	SLM22-4CB-50K-U	30W	3,750	125	5000K	80+	100-277V	0-10V	✓✓
09754	SLM22-5CB-35K-U	40W	5,000	125	3500K	80+	100-277V	0-10V	✓✓
09755	SLM22-5CB-40K-U	40W	5,000	125	4000K	80+	100-277V	0-10V	✓✓
09756	SLM22-5CB-50K-U	40W	5,000	125	5000K	80+	100-277V	0-10V	✓✓
09766	SLM24-5CB-35K-U	40W	5,000	125	3500K	80+	100-277V	0-10V	✓✓
09767	SLM24-5CB-40K-U	40W	5,000	125	4000K	80+	100-277V	0-10V	✓✓
09768	SLM24-5CB-50K-U	40W	5,000	125	5000K	80+	100-277V	0-10V	✓✓
09757	SLM24-6CB-35K-U	50W	6,250	125	3500K	80+	100-277V	0-10V	✓✓
09758	SLM24-6CB-40K-U	50W	6,250	125	4000K	80+	100-277V	0-10V	✓✓
09759	SLM24-6CB-50K-U	50W	6,250	125	5000K	80+	100-277V	0-10V	✓✓

✓DesignLights Consortium® Qualified

✓✓DesignLights Consortium® Premium Qualified

DIMENSIONS

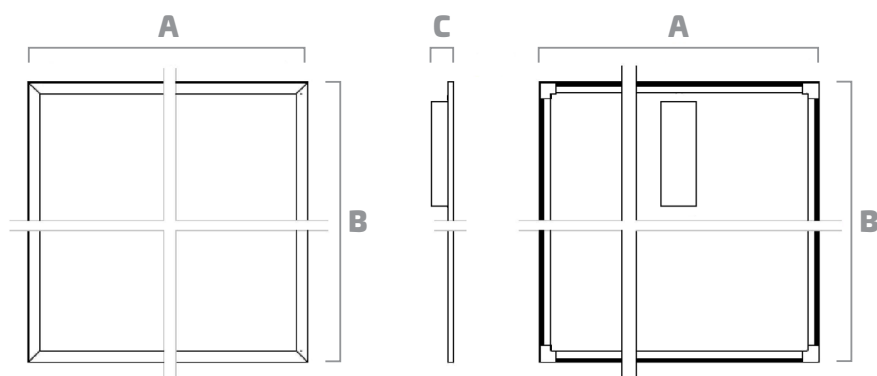

	2'x2'	2'x4'	1'x4' (CB)	2'x2' (CB)	2'x4' (CB)
A	23.87"/ 603.3mm	47.5"/ 1206.5mm	11.85"/ 301mm	23.75"/ 603.3mm	23.75"/ 603.3mm
B	23.87"/ 603.3mm	23.87"/ 603.3mm	4.75"/ 120.65mm	23.75"/ 603.3mm	4.75"/ 120.65mm
C	1.82"/ 46.2mm	1.82"/ 46.2mm	1.82"/ 46.2mm	1.82"/ 46.2mm	1.82"/ 46.2mm

AVAILABLE ACCESSORIES

Order Code	Item #	Description
10051	SLM14-CABLE-CB	1x4 Cable Set, 4 Cables per Set
09692	SLM22-CABLE	2x2 Cable Set, 4 Cables per Set
10050	SLM22-CABLE-CB	2x2 Cable Set for CB, 4 Cables per Set
09693	SLM24-CABLE	2x4 Cable Set, 6 Cables per Set
10052	SLM24-CABLE-CB	2x4 Cable Set for CB, 6 Cables per Set
09905	SLM14-SM	1x4 Surface Mount Kit White
09694	SLM22-SM	2x2 Surface Mount Kit White

Order Code	Item #	Description
09695	SLM24-SM	2x4 Surface Mount Kit White
09849	FHSCP-UNV-5WL	5W Emergency Battery Backup
09851	FHSCP-UNV-7.8WL	7.8W Emergency Battery Backup
09850	FHSCP-UNV-10.7WL	10.7W Emergency Battery Backup
09852	FHSCP-UNV-13.7WL	13.7W Emergency Battery Backup
09854	FHSCP-UNV-17WL	17W Emergency Battery Backup

PHOTOMETRICS

SLM14 - 1'X4'

ZONAL LUMEN SUMMARY		
Zone	Lumens	%Fixture
0-30	989.6	27.1%
0-40	1,623.2	44.4%
0-60	2,866.6	78.5%
60-90	786.0	21.5%
70-100	338.5	9.3%
90-120	0.0	0%
0-90	3,652.6	100%
90-180	0.4	0%
0-180	3,653.0	100%

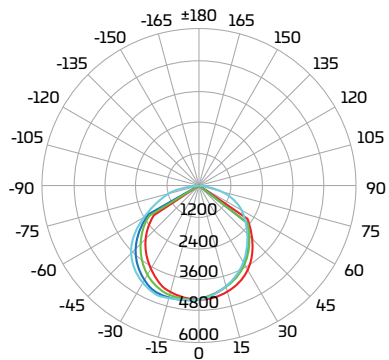

AVERAGE BEAM ANGLE (50%) : 111.9°

UNIT : cd | C0-180, 111.6 C60/240, 112.1
C30/210, 111.7 C90/270, 112.2

SLM22 - 2'X2'

ZONAL LUMEN SUMMARY		
Zone	Lumens	%Fixture
0-30	1,294.4	27%
0-40	2,124.3	44.4%
0-60	3,757.0	78.5%
60-90	1,028.5	21.5%
70-100	439.1	9.2%
90-120	0.4	0%
0-90	4,785.5	100%
90-180	2.0	0%
0-180	4,787.5	100%

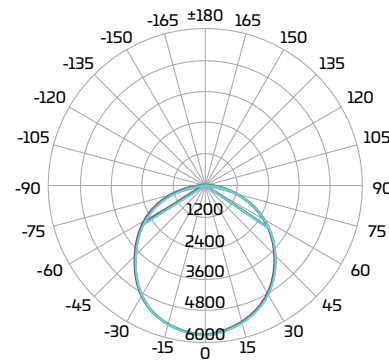

AVERAGE BEAM ANGLE (50%) : 112.4°

UNIT : cd | C0-180, 112.1 C60/240, 112.6
C30/210, 112.3 C90/270, 112.4

SLM24 - 2'X4'

ZONAL LUMEN SUMMARY		
Zone	Lumens	%Fixture
0-30	1,668.9	27%
0-40	2,741.5	44.3%
0-60	4,849.7	78.4%
60-90	1,333.8	21.6%
70-100	574.6	9.3%
90-120	0.5	0%
0-90	6,183.5	100%
90-180	0.6	0%
0-180	6,184.1	100%

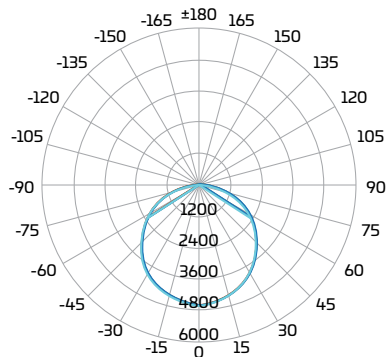

AVERAGE BEAM ANGLE (50%) : 112.9°

UNIT : cd | C0-180, 113.1 C60/240, 112.8
C30/210, 113.0 C90/270, 112.6

The Vex Outdoor LED Wall Sconce is a minimalist profile featuring up and down lighting and delivers a wide range of optical control and illumination options. Independently controlled beam angles range from 10° - 120° achieved with a simple tool-free adjustment. Beams are lockable and can be set symmetric or asymmetric in both directions. Angle markers ensure consistency and precision from fixture to fixture. Vex is ideal for indoor or outdoor accent lighting, ambient lighting and wayfinding where beam angle is critical.

Key features

- Tool-free, independent, up/down beam angle adjustment 10° - 120°
- Asymmetric or Symmetric Beam Shaping
- Lockable
- Angle markers for consistent and precise aiming

SPECIFICATIONS

DELIVERED LUMENS	554.3
WATTS	18.7
VOLTAGE	Universal 120V - 277V
DIMMING	0-10V, ELV, TRAC, CL
LIGHT DISTRIBUTION	Symmetric or Asymmetric depending on barn doors position
MOUNTING OPTIONS	Wall
OPTICS	Adjustable beam spread
CCT	2700K, 3000K or 4000K
CRI	90+
COLOR BINNING	3-Step
BUG RATING	B0-U3-G0
DARK SKY	Non-Compliant
WET LISTED	IP65
GENERAL LISTING	ETL, ADA
CALIFORNIA TITLE 24	Can be used to comply with CEC 2019 Title 24 Part 6 for outdoor use. Registration with CEC Appliance Database not required.
START TEMP	-30°C
FIELD SERVICEABLE LED	Yes
CONSTRUCTION	Aluminum
HARDWARE	Stainless Steel
FINISH	Powder Coat
LED LIFETIME	L70; >60,000 Hours
WARRANTY*	5 years
WEIGHT	2.4 lbs.

*Visit techlighting.com for specific warranty limitations and details.
Ships with optional acrylic cover for protection against outdoor debris.



VEX
shown in black



VEX
shown in bronze



VEX
shown in charcoal



VEX
shown in white

ORDERING INFORMATION

PRODUCT	CRI/CCT	LENGTH	FINISH	FUNCTION	INPUT VOLTAGE
7000WVEX	927 90 CRI, 2700K	4 4"	H CHARCOAL	UPLIGHT AND DOWNLIGHT	UNV UNV 120V-277V
	930 90 CRI, 3000K		Z BRONZE	DO DOWNLIGHT ONLY	
	940 90 CRI, 4000K		W WHITE		
			B BLACK		

SHIPS WITH OPTIONAL ACRYLIC COVER FOR PROTECTION AGAINST OUTDOOR DEBRIS.

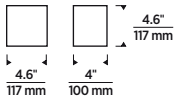

Vex Wall Sconce

PHOTOMETRICS*

*For latest photometrics, please visit www.techlighting.com/OUTDOOR

VEX
 Total Lumen Output: 554.3
 Total Power: 18.7
 Luminaire Efficacy: 29.6
 Color Temp: 3000K
 CRI: 90+
 BUG Rating: B0-U3-G0

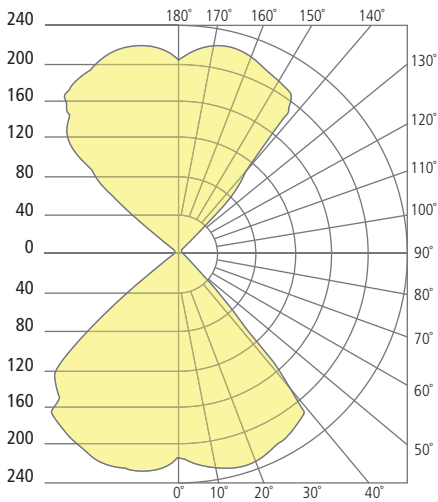

PROJECT INFO

FIXTURE TYPE & QUANTITY	JOB NAME & INFO	NOTES



Color: Bronze

Weight: 7.2 lbs

Project:	Type:
Prepared By:	Date:

Driver Info		LED Info	
Type	Constant Current	Watts	26W
120V	0.22A	Color Temp	5000K (Cool)
208V	0.13A	Color Accuracy	70 CRI
240V	0.11A	L70 Lifespan	100,000 Hours
277V	0.10A	Lumens	3,851
Input Watts	28.7W	Efficacy	134.2 lm/W

Technical Specifications

Compliance

UL Listed:

Suitable for wet locations. Suitable for mounting within 1.2m (4ft) of the ground.

DLC Listed:

This product is listed by Design Lights Consortium (DLC) as an ultra-efficient premium product that qualifies for the highest tier of rebates from DLC Member Utilities. Designed to meet DLC 5.1 requirements.
DLC Product Code: P0000170I

Performance

Lifespan:

100,000-Hour LED lifespan based on IES LM-80 results and TM-21 calculations

Construction

IP Rating:

Ingress protection rating of IP66 for dust and water

Finish:

Formulated for high durability and long-lasting color

Ambient Temperature:

Suitable for use in up to 40°C (104°F)

Cold Weather Starting:

Minimum starting temperature is -40°C (-40°F)

Green Technology:

Mercury and UV free. RoHS-compliant components.

Electrical

Driver:

Constant Current, Class 2, 120-277V, 50/60Hz, 120V: 0.22A, 208V: 0.13A, 240V: 0.11A, 277V 0.10A

Dimming Driver:

Driver includes dimming control wiring for 0-10V dimming systems. Requires separate 0-10V DC dimming circuit. Dims down to 10%.

THD:

10.68% at 120V, 10.68% at 277V

Power Factor:

95.4% at 120V, 95.4% at 277V

LED Characteristics

Color Consistency:

7-step MacAdam Ellipse binning to achieve consistent fixture-to-fixture color

Color Stability:

LED color temperature is warrantied to shift no more than 200K in color temperature over a 5-year period

Technical Specifications (continued)

LED Characteristics

Color Uniformity:

RAB's range of Correlated Color Temperature follows the guidelines of the American National Standard for Specifications for the Chromaticity of Solid State Lighting (SSL) Products, ANSI C78.377-2017.

Other

Patents:

The WPLED design is protected by U.S. Pat. D634878, Canada Pat 134878, China Pat. CN301649064S.

Equivalency:

Equivalent to 150W Metal Halide

Buy American Act Compliance:

RAB values USA manufacturing! Upon request, RAB may be able to manufacture this product to be compliant with the Buy American Act (BAA). Please contact customer service to request a quote for the product to be made BAA compliant.

Optical

BUG Rating:

B1 U0 G0

Dimensions

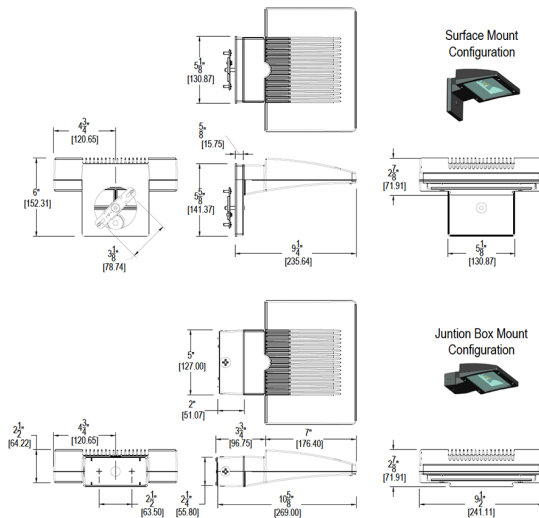

Features

- Maintains 70% of initial lumens at 100,000-hours
- Weatherproof high temperature silicone gaskets
- Superior heat sinking with die cast aluminum housing and external fins
- 100 up to 277 Volts
- 5-Year, No-Compromise Warranty

Outdoor Cove Lighting CROWN



Outdoor Cove Lighting

CROWN



- Quick connection
- Dimmable, 1-10V dimming to 10%-100%
- Linkable, max. linkable length: 72' @120VAC, 156' @277VAC
- Lockable, precision aiming adjustment: $\pm 85^\circ$ vertical rotation
- IP rating: IP66 (for wet locations)
- Lifetime: 50,000hrs ($t_a=95^\circ\text{F}$, 35°C)
- T_a : $-13^\circ\text{F} \sim 122^\circ\text{F}$ ($-25^\circ\text{C} \sim 50^\circ\text{C}$)
- 10W/ft, 1050lm/ft
- Material: Aluminum alloy
- Other color temp available



Dimensions: (inches/mm)



How to order using our catalog numbers
Example: CROWN-1230K110SS

Series	Length	CCT (K)	Beam Angle	Finish	Installation
CROWN	12 - 11.8" (300mm) 47 - 47" (1120mm) 70 - 70" (1778mm)	30K - 3000K 40K - 4000K	110 - 110°	S - Silver	S - Screw Mounting

Specifications

Catalog No.	Model	Rated Input (VAC)	Ra	Power (W)	Luminous flux (TYP@4000K)lm
CROWN-1230K110SS	CROWN-L24-277V	120-277	85	10	1050
CROWN-1240K110SS					
CROWN-4730K110SS	CROWN-L90-277V	120-277	85	40	4200
CROWN-4740K110SS					
CROWN-7030K110SS	CROWN-L144-277V	120-277	85	60	6300
CROWN-7040K110SS					

* Included: 1 pc LED fixture, 2pcs screws, 1pc cable end cap.

Photometrics

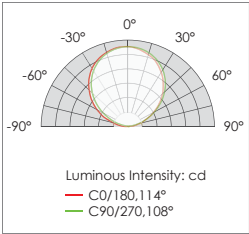



Outdoor Cove Lighting

CROWN/CROWN NARROW

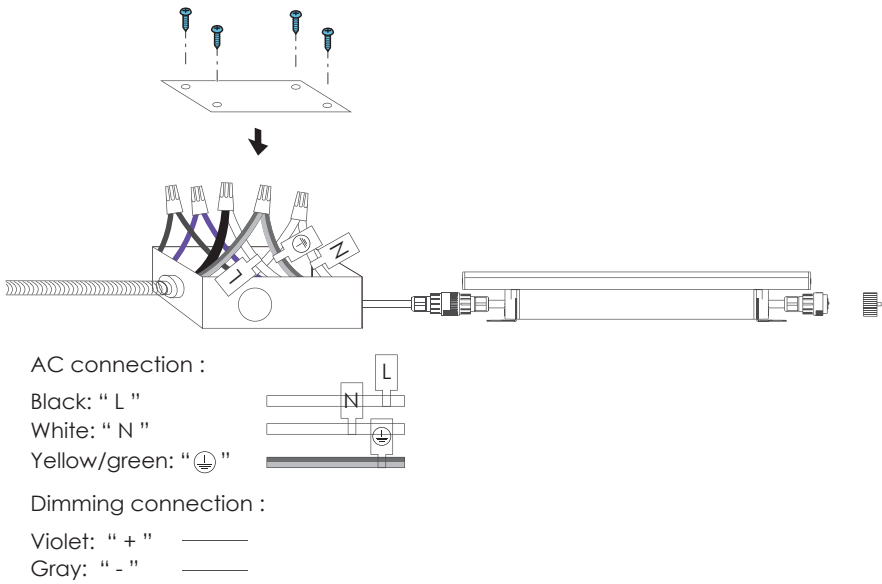
Wiring Diagram

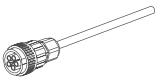

Accessories	Catalog No.	Description	Length (inch)
	IC-CROWN-59	 <p>Input cable</p>	59"
Accessories(optional)	Catalog No.	Description	Length (inch)
	SC-CROWN-12	 <p>Soft connector</p>	12"

Outdoor Cove Lighting

CROWN/CROWN NARROW

Installation

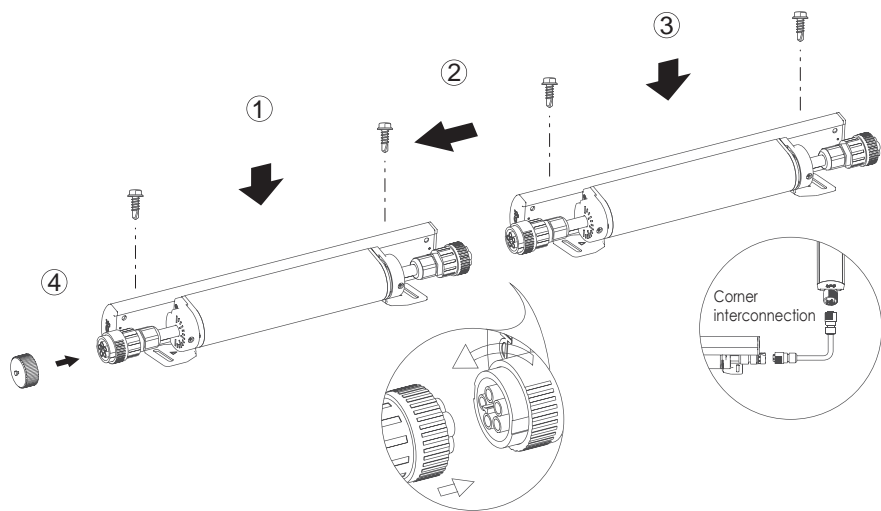

Application

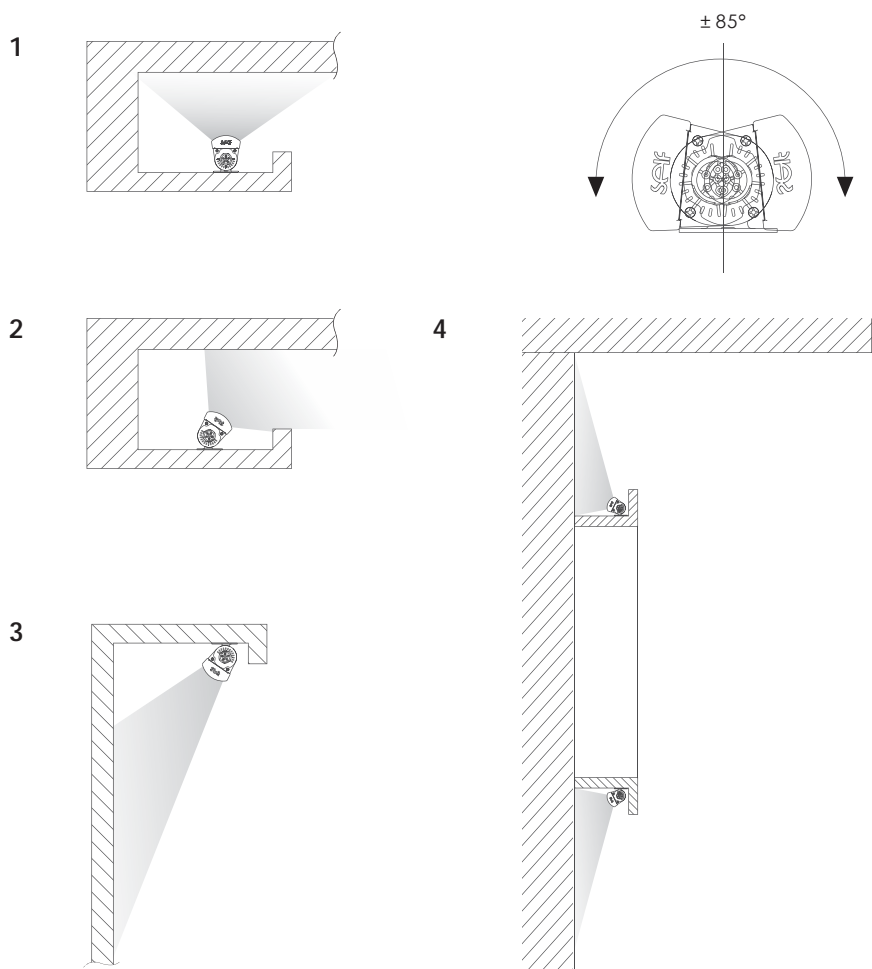

Project Name

Location

Prepared By



NUVO 65-226

LED VAPOR PROOF CEILING MOUNT

Notes

[www] 10-11-2021 02:00:20

General

Status	Active
Fixture Type	Vapor Proof
Finish	Silver
Wattage	20W
Lumen Output	1800L
CCT (Kelvin)	5000
Temperature	Natural Light
IP Rating	IP65
Indoor or Outdoor Fixture	Outdoor

Specifications

Technology	LED
CRI	80
Voltage	100V-277V
Rated Hours	50000
Operating Temperature	-30C (-22F) to a maximum of +50C (+122F)
Dimmable	Non-Dimmable
Lens Material	Glass
Weight (lb.)	3.79
Material	Die Cast Aluminum

Dimensions

Height (in.)	11.09
Width (in.)	5.66

Compliance

Safety Listing	cETLus
Location Rating	Wet
UL Application	Ceiling / Wall
Energy Star	Yes
ES Unique ID	ESID-2335321
California Status	California T24 Compliant
California Prop 65	Lead
RoHS Compliant	Yes
FCC Compliant	Yes

Additional Information

Warranty	5 Year Limited - Fixtures
----------	---------------------------

DRD5S & SurfaceFrame

Surface Mount LED Downlight















New Construction
DRDHNJO Octagonal Junction Box

Project:	Type:
Product Code:	Date:

Spec Sheet V-01.10.22



- Thinnest-in-class DRD5S delivers the pure, smooth light and the elegant look of a high-end recessed downlight
- Features multiple ratings to meet the demands of a wide range of situations
- Ultra-low profile allows it to install in as little as 2" of ceiling space when 5/8" drywall is used

Application New Construction		Aperture 4" Octagonal Junction Box	
Delivered Lumens 750 lm (9.0W), 1000 lm (12.0W)		Color Quality 90+ CRI, < 3-step SDCM	
Color Temperature <div> 2700K</div> <div> 3000K</div> <div> 3500K</div>		Optics  General	
Input Voltage 120V only (TRIAC/ELV), 120/277V (0-10V)	Dimming TRIAC/ELV 5% 0-10V 1%	Emergency Lighting Optional Emergency LED Driver with integrated Test Switch for lighting up to 90 minutes in event of power failure	
Shape Round, Square		Finish White	Module Ratings <div> UL Closet Rating Compliant (750 lm only)</div> <div> UL Listed for Wet Location</div>
Housing Ratings <div><div> Code compliant for use in appropriate fire-rated assemblies up to a maximum of 2-hours</div><div> STC/IIC Sound Rated</div><div> ASTM E283 Certified Air Tight</div><div> IC (Insulation Contact) Rated</div></div>			
Standards <div>  </div>		Guarantee 50,000 hrs 5 years	Additional Options <div> Non-Conductive Dead Front</div>



PRODUCT BUILDER

HOUSING

PRODUCT CODE		APPLICATION		APERTURE		OPTION	
<input type="text"/>		<input type="text"/>		<input type="text"/>		<input type="text"/>	
DRDH	Housing	N	New Construction	JO	SurfaceFrame Octagonal Junction Box	[Blank]	Integrated Driver
						70SEM	EM Driver ¹ , 0-10V, 750 lm
						100SEM	EM Driver ¹ , 0-10V, 1000 lm

LED MODULE

PRODUCT CODE		APERTURE		SHAPE		LUMENS		CRI		CCT		DRIVER	
<input type="text"/>		<input type="text"/>		<input type="text"/>		<input type="text"/>		<input type="text"/>		<input type="text"/>		<input type="text"/>	
DRD5S	Module	4	4" Aperture	R	Round	07	750 lm	9	90+ CRI	27	2700K	T	Integrated TRIAC/ELV, 120V only
				S	Square	10	1000 lm			30	3000K	O	Integrated 0-10V, 120/277V
										35	3500K	TDF	Integrated TRIAC/ELV, 120V only, Non-Conductive ¹
												ODF	Integrated 0-10V, 120/277V, Non-Conductive ¹
												EM	Emergency ¹ w/ Test Switch

¹ EM option (housing) and Emergency driver (module) must be selected together

² Only available for Round shape, 750 lm, 2700K or 3000K CCT



HOUSING

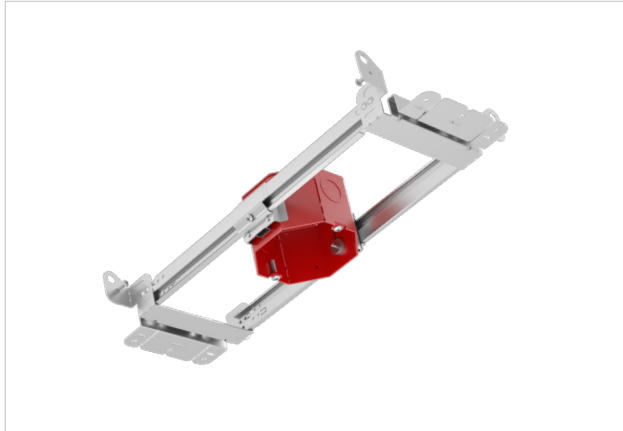

SurfaceFrame

New Construction Octagonal Junction Box

DRDHNJO

SUMMARY

JUNCTION BOX: Equipped with (4) 1/2" trade size knockouts (two side, two top) to allow straight conduit runs. Approved for 6 (three in, three out) #12 AWG 70°C through wiring conductors.

MOUNTING: Pre-installed mounting brackets allow vertical adjustment of bar hangers up to 1"

CEILING: 1/2" up to 1 3/4"

CUTOUT: 4 1/8" (105mm) octagonal opening

LISTINGS: Metallic outlet box certified UL514A, code compliant for use in appropriate fire-rated assemblies for up to 2-hours, STC/IIC Sound Rated, ASTM E283 certified Air Tight, IC (Insulation Contact) rated

WARRANTY: 5 year limited warranty

SurfaceFrame

DRDHNJO

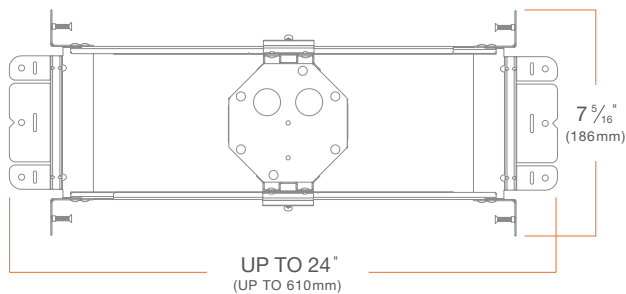
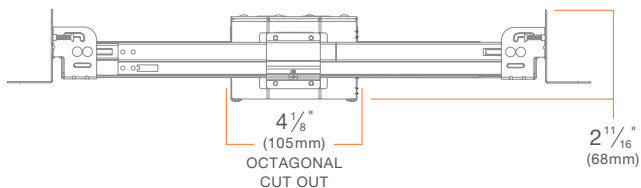

SurfaceFrame w/ Emergency Lighting

DRDHNJO EM

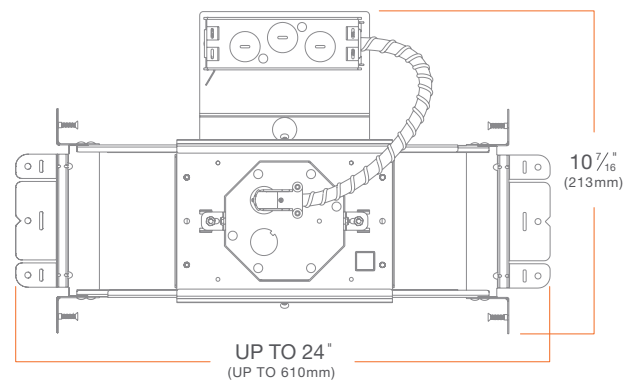
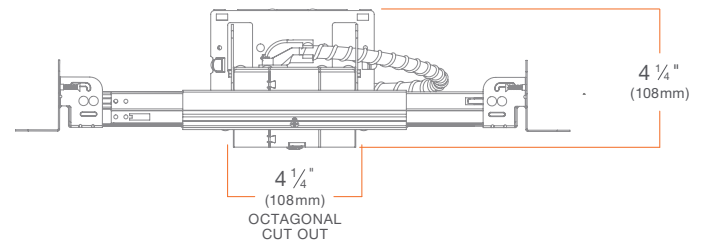

MODULE



DRD5S

Surface Mount LED Module

DRD5S

SUMMARY

LED: Optimized LED array

SHAPE: 4" Round, 4" Square

MODULE LUMENS: 750 lm (9.0W), 1000 lm (12.0W)

COLOR QUALITY: 90+ CRI, less than 3-step SDCM

CCT: 2700K, 3000K, 3500K

INPUT VOLTAGE: 120V only (TRIAC/ELV), 120/277V (0-10V)

DIMMING: Down to less than 5% for TRIAC/ELV at 120V, 1% for 0-10V at 120/277V

MAX INPUT CURRENT (120V): 0.075 amps, 0.1047 amps

MAX INPUT CURRENT (277V): 0.034 amps, 0.047 amps

POWER FACTOR: Greater than 0.9

TOTAL HARMONIC DISTORTION: Less than 20%

AMBIENT OPERATING TEMPERATURE: -20°C to 40°C

EMERGENCY LIGHTING: Optional Emergency LED Driver with Integrated Test Switch for lighting up to 90 minutes in event of power failure

PHOTOMETRIC TESTING: Tested in accordance to IESNA LM-79-2008

LISTINGS: ENERGY STAR® qualified, California Title 24 2019 JA8 compliant, UL Listed for Wet Location, UL Closet Rating compliant (750 lm only), cULus Listed

LIFETIME: 50,000 hours at 70% lumen maintenance

WARRANTY: 5 year limited warranty

4" Round

DRD5S4R

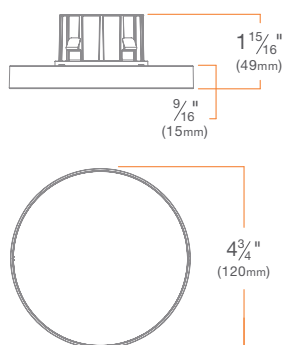

4" Square

DRD5S4S

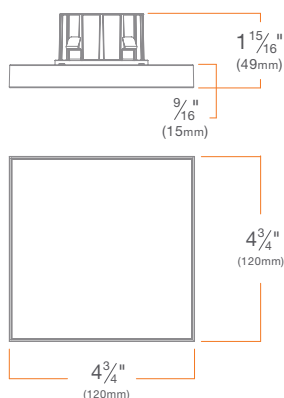

4" Round w/ EM Test Switch

DRD5S4R EM

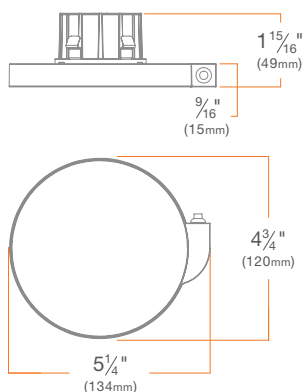

4" Square w/ EM Test Switch

DRD5S4S EM

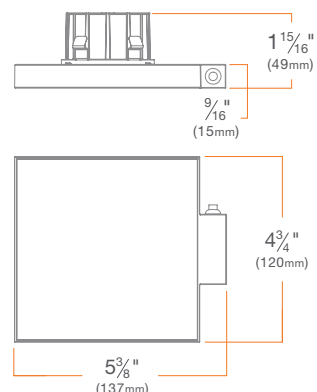



PHOTOMETRY

DRD5S 4" Round, 750 lm, 90 CRI, 3000K **DRD5S4R07930**

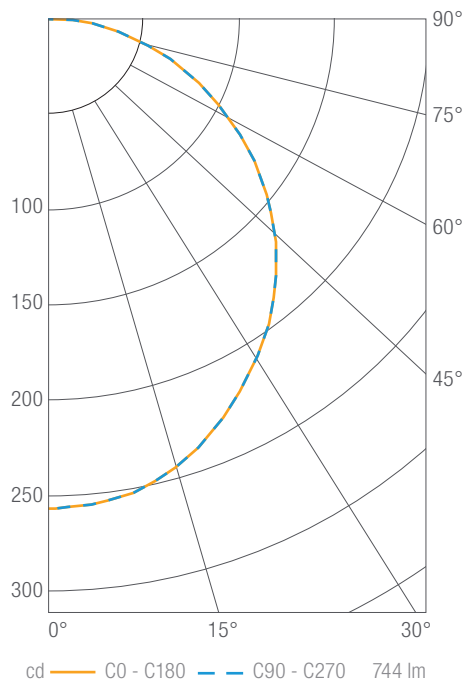

Luminous Intensity

Gamma	C 0°
0°	258
5°	256
10°	253
15°	247
20°	237
25°	226
30°	213
35°	200
40°	185
45°	169
50°	151
55°	132
60°	113
65°	93
70°	73
75°	54
80°	35
85°	18
90°	6

Values in candela

Zonal Lumen Summary

Zone	Lumens	Luminaire %
0-30	199	27
0-40	324	44
0-60	573	77
0-90	744	100
0-180	744	100

Illuminance Chart

Distance from LED	Foot Candles	Diameter
3.0'	29	8.8'
6.0'	7	17.7'
9.0'	3	26.5'
12.0'	2	35.3'

Beam Angle: 70°

DRD5S 4" Round, 1000 lm, 90 CRI, 3000K **DRD5S4R10930**

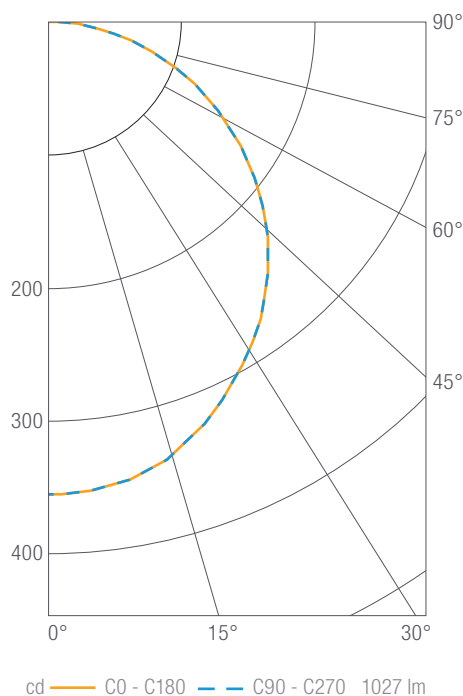

Luminous Intensity

Gamma	C 0°
0°	356
5°	354
10°	349
15°	340
20°	327
25°	312
30°	294
35°	276
40°	255
45°	233
50°	209
55°	183
60°	155
65°	128
70°	101
75°	74
80°	48
85°	25
90°	9

Values in candela

Zonal Lumen Summary

Zone	Lumens	Luminaire %
0-30	274	27
0-40	447	44
0-60	790	77
0-90	1027	100
0-180	1027	100

Illuminance Chart

Distance from LED	Foot Candles	Diameter
3.0'	40	8.8'
6.0'	10	17.7'
9.0'	4	26.5'
12.0'	2	35.3'

Beam Angle: 63°

**DIMMER COMPATIBILITY****Recommended Phase-control Dimmers** (Dims down to 5% nominal measured light output)

Brand	Series	Model Number	Max Load 750lm DRD5S4R07	Max Load 1000lm DRD5S4R10
Cooper	Aspire	9573	29	23
Leviton	Vizia	VPE06	64	48
Lutron	CL Series	AYCL-253, DVCL-253	26	20
	Grafik Eye 3000	QSGR-3P, QSGR-6P	31	24
	Grafik Sys / Homeworks	RPM-4U	44	35
	Maestro CL	MACL-153M, MSCL-OP153M, MSCL-VP153M	16	12

Compatible Phase-control Dimmers¹ (Dims down to 20% nominal measured light output)

Brand	Series	Model Number	Max Load 750lm DRD5S4R07	Max Load 1000lm DRD5S4R10
Cooper	Decorator	DLC03P, DAL06P	29	23
Legrand	Adorne	ADTP703	48	38
	Digital Light Management	LMRC-221	250	195
Leviton	IllumaTech	IPE04	32	25
	Vizia	VPE04	42	32
Lutron	CL Series	AYCL-153, CTCL-153, DVCL-153, LGCL-513, SCL-153, TGCL-513	15	11
	Maestro Wireless	MRF2-6ELV, MRF2-6CL	15	12
	Radio RA	RRD-6NA, RRD-6CL, RRD-6D	15	12
	Skylark Contour CL	CTCL-153P	15	12

¹ Dimmer compatibility reflects performance compatibility only. Please reference your local codes for application.

**DIMMER COMPATIBILITY****Recommended 0-10V Dimmers** (Dims down to 1% nominal measured light output)

Brand	Series	Model Number	Max Load 750lm DRD5S4R07	Max Load 1000lm DRD5S4R10
Legrand	Titan	CD4FB	200	150
Leviton	IllumaTech	IP710-DLZ	120	90
Lithonia	Synergy	ISD BC	120	90
Lutron	Diva	DVTV	100	75
	Nova	NFTV	200	150
	Nova	NTSTV-DV	100	75
	Vive-PowPak	RMJS-8T-DV-B	60	45
Watt Stopper	Micro-Decorator	DCLV1	60	45
	DLM	LMRC-211	100	75



SurfaceFrame Options

Shallow Recessed LED Downlight

DRD2 & SurfaceFrame

DRDHNJO Octagonal Junction Box

DRD2 & SurfaceFrame Alt/EM

Alternate Dimming and/or Emergency Lighting

DRDHNJO Octagonal Junction Box

Surface Mount LED Downlight

DRD5S & SurfaceFrame

DRDHNJO Octagonal Junction Box



Nuvo Lighting 26W, Blink Plus Surface Mount LED Light Fixture, White Finish Features:

- Comes in gunmetal grey, white, or bronze finish.
- Fixture requires 1, 26W LED module, Included.
- 3000K Color Temperature provides a warm yellow-toned light perfect for hospitality applications.
- Has a 5 Year Warranty.
- up to 50,000 average rated hours.
- Compatible dimmer at 120V only.
- Ceiling mount installation/application.
- Dimensions: 1"(H), 15" MOD.

Image may not depict product actual color, inclusions or accessories



Similar Flush Mount LED Lights Products



ESL Vision 6-in 15W LED Disk Light, Round, Dimmable, 1150 lm...

DSK-6-15W-340-WH

\$10.50 Each



ESL Vision 6-in 15W LED Disk Light, Round, Dimmable, 1050 lm...

DSK-6-15W-327-WH

\$10.50 Each



HomEnhancements 5/6-in 15W LED Disk Light, Dim, 1150 lm, White

LED-DL56-WH(AC15W/3000K)PLUS

\$19.45 Each



NaturaLED 15W LED Flush Mount Compact Light, Dimmable, 900 l...

9367

\$11.36 Each



GlobaLux 7-in 15W LED Disk Light, Edge Lit, Dimmable, 1016 l...

RDL-7-15-120D-930-WH

\$29.99 Each

NEW LOW PRICE ?

Add to cart to see price

Free Shipping

1

ADD TO CART

SKU **NUV-621191**

In Stock

Usually ships **3 to 7 Business Days**



[Visit The Nuvo Store](#)

Product Specifications

Part Number	62-1191, 62/1191
Bulb Included	Yes
Bulb Type	LED
Certificate	ETL Listed
Color / Finish	White
Color Temperature	3000K
CRI	90
Dimmable	Yes
Lamp Base	Connector
Lamp Type/Light Source	LED
Maximum Voltage	120V-277V
Number of Lights	1
Replaceable Light Source	No
Style	Utility
Warranty	5 Yr
Wattage	26W
Weight	0.50 lb

AREA LIGHTING

FORM AND FUNCTION

- Sleek, low profile housing
- Spec grade performance
- Engineered for optimum thermal management
- Low depreciation rate
- Reduces energy consumption and costs up to 65%
- Exceeds IES foot candle levels utilizing the least number of poles and fixtures per project
- Optical system designed for:
 - Parking Lots
 - Auto Dealerships
 - General Area Lighting

CONSTRUCTION

- Die Cast Aluminum
- External cooling fins, Finite Element Analysis (FEA) designed
- Corrosion resistant external hardware
- One-piece silicone gasket ensures IP-65 seal for electronics compartment
- One-piece Optics Plate™ mounting silicone Micro Optics
- Two-piece silicone Micro Optic system ensures IP-67 level seal around each PCB
- Grade 2 Clear Anodized Optics Plate™ standard

FINISH

- 3-5 mils electrostatic powder coat.
- NLS' standard high-quality finishes prevent corrosion protects against and extreme environmental conditions

WARRANTY

Five-year limited warranty for drivers and LEDs.



LISTINGS

- Certified to UL 1598
- UL 8750
- CSA C22.2 No. 250.0
- DesignLights Consortium® (DLC)
- DesignLights Consortium Premium® (DLCP)
- IP65/ IP67 Rated
- 3G Vibration Rated per ANSI C136.31-2010

LED WATTAGE CHART

	16L	32L	48L	64L
350 milliamps	18w	-	-	-
530 milliamps	28w	-	-	-
700 milliamps	36w	71w	104w	136w
1050 milliamps	56w	106w	156w	205w

Project Name:

Type:

Cat #	Light Dist.	No. of LEDs	Milliamps	Kelvin	Volts	Mounting	Color	Options
NV Size 1 (NV-1)	Type 2 (T2)	16 (16L)	350	3000K	120-277	Direct Pole Single, D180 3" (DPS3) D90, T90, T120, QD 7" (DPS7) Knuckle Mount (KM) Wall Mount (WM) Trunnion Mount (TM) <i>*Standard finish is stainless steel. Can be painted to match fixture</i> Tennis Arm (TA) <i>*See next page for Arm Configurations *For Round Pole, please specify RPA4 or RPA5</i>	Bronze (BRZ)	Bird Deterant (BD)
	Type 3 (T3)	32 (32L)	350	3000K	120-277		White (WHT)	Marine Grade Finish (MGF)
		48 (48L)	530	4000K	347-480		Silver (SVR)	Optic Plate Painted to Match Fixture (OPP)
		64 (64L)	530	4000K	347-480			Nema 7-Pin Receptacle (PE7)
	Type 4 (T4)	700	5000K	30° Narrow Beam (N3)	1050		Black (BLK)	Photocell + Receptacle (PCR)
Type 5 (T5)	700	5000K	Receptacle + Shorting Cap (PER)					
							Graphite (GPH)	FSP-211 with Motion Sensor (UNV Voltage)
							Grey (GRY)	(FSP-20) *9'-20' Heights
							Custom (CS)	(FSP-40) *21'-40' Heights
								Quick Mount Bracket (QMB)
								Retrofit Mount Bracket (RQMB)
								Round Pole Adaptor 3"- 4" Pole (RPA4)
								Round Pole Adaptor 5"- 6" Pole (RPA5)
								Rotated Optic Left (ROL)
								Rotated Optic Right (ROR)
								Automotive House Side Shield (AHS)
								House Side Shield (HSS)
								*HSS not applicable with N3 - NEMA 30° Optics

ELECTRICAL

- 120-277 Volts (UNV) or 347-480 Volts (HV)
- 0-10V dimming driver by Philips Advance
- Driver power factor at maximum load is $\geq .95$, THD maximum load is 15%
- All internal wiring UL certified for 600 VAC and 105°C
- All drivers, controls, and sensors housed in enclosed IP-65 compartment
- Lumileds Luxeon MX LED's
- CRI >70
- Color temperatures: 3000K, 4000K, 5000K
- Surge Protection: 20KVA supplies as standard.

OPTIONS

- **BIRD DETERRANT (BD)**—offers effective and humane deterrent for larger bird species and provides cost-effective long-term solution to nuisance bird infestations and protect your property.
- **MARINE GRADE FINISH (MGF)**—A multi-step process creating protective finishing coat against harsh environments.
 - Chemically washed in a 5 stage cleaning system.
 - Pre-baked
 - Powder coated 3-5 mils of Zinc Rich Super Durable Polyester Primer.
 - 1-2 feet inside pole coverage top and bottom.
 - Oven Baked.
 - Finished Powder Coating of Super Durable Polyester Powder Coat 3-5 mil thickness.
- **SHIELDS (HSS, AHS)**—House Side Shield (HSS) is designed for full property line cut-off. Automotive House Side Shield (AHS) is a single-sided shield allowing partial cut-off on either side or front of luminaire.
- **ROUND POLE ADAPTER (RPA)**— When using round poles, specify Round Pole Adapter (RPA). Specify RPA4 when installing on 3"-4" round poles, and RPA5 when installing on 5"-6" round poles.

CONTROLS

- **FSP-211 (FSP-X)**—Passive infrared (PIR) sensor providing multi-level control based on motion/daylight contribution.
 - All control parameters adjustable via wireless configuration remote storing and transmitting sensor profiles.
 - FSP-20 mounting heights 9-20 feet
 - FSP-40 mounting heights 21-40 feet.
 - Includes 5 dimming event cycles, 0-10V dimming with motion sensing, reprogrammable in the field.
- **NEMA 7-PIN RECEPTACLE (PE7)**—An ANSI C136.41-2013 receptacle provides electrical and mechanical interconnection between photo control cell and luminaire. Dimming receptacle available two or four dimming contacts supports 0-10 VDC dimming methods or Digital Addressable Lighting Interface (DALI), providing reliable power interconnect.

OPTICS

Silicone optics high photothermal stability and light output provides higher powered LEDs with minimized lumen depreciation LED life. UV and thermal stability with scratch resistance increases exterior application durability.

- IES Types

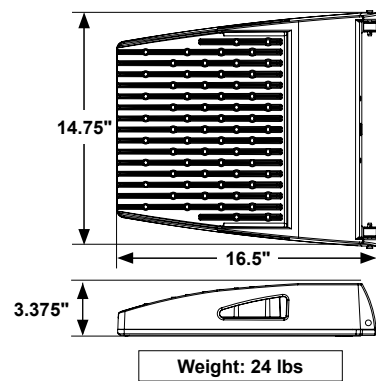
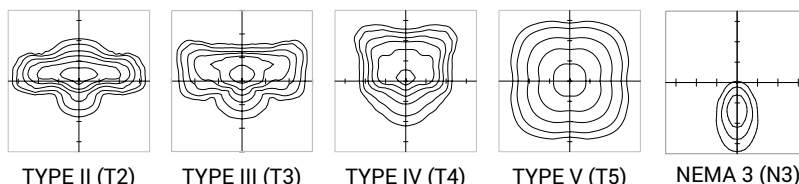

RPA4 / RPA5

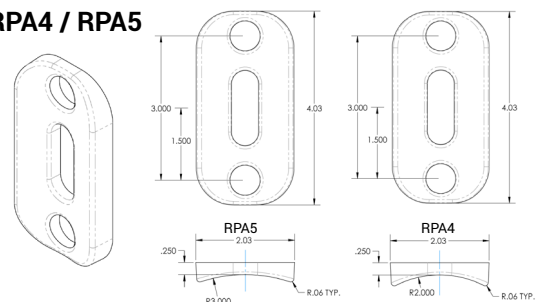

HOUSE SIDE SHIELD

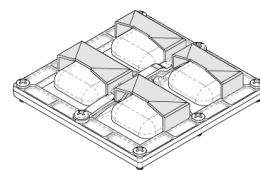

AUTOMOTIVE HOUSE SIDE SHIELD

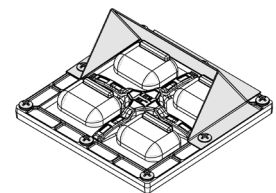

FSP-211

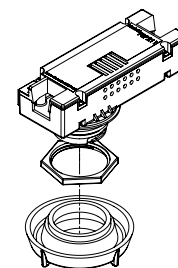

LUMENS

PART NUMBER	N3	LM/W	T2	LM/W	DLC	T3	LM/W	DLC	T3 HSS	LM/W	T4	LM/W	DLC	T4 AHS	LM/W	T4 HSS	LM/W	T5	LM/W	DLC	W
NV-1-16L-35-30K	2016	112	2106	117	P	2106	117	P	1134	63	2187	116	P	1296	72	1116	62	2231	118	P	18
NV-1-16L-35-40K	2088	116	2268	126	P	2286	127	P	1206	67	2250	125	P	1368	76	1188	66	2304	128	P	18
NV-1-16L-35-50K	2160	120	2376	132	P	2394	133	P	1278	71	2358	131	P	1440	80	1260	70	2412	134	P	18
NV-1-16L-53-30K	3136	112	3192	114	P	3220	115	P	1764	63	3119	113	P	2016	72	1736	62	3248	116	P	28
NV-1-16L-53-40K	3248	116	3472	124	P	3472	124	P	1876	67	3444	123	P	2128	76	1848	66	3500	125	P	28
NV-1-16L-53-50K	3360	120	3612	129	P	3640	130	P	1988	71	3584	128	P	2240	80	1960	70	3668	131	P	28
NV-1-16L-7-30K	4032	112	3960	110	P	3960	110	P	2268	63	3973	109	P	2592	72	2232	62	3996	111	P	36
NV-1-16L-7-40K	4176	116	4428	123	P	4284	119	P	2412	67	4212	117	P	2736	76	2376	66	4320	120	P	36
NV-1-16L-7-50K	4320	120	4644	129	P	4500	125	P	2556	71	4428	123	P	2880	80	2520	70	4500	125	P	36
NV-1-16L-1-30K	6272	112	6160	110	S	6384	114	P	3528	63	6232	112	P	4032	72	3472	62	6440	115	P	56
NV-1-16L-1-40K	6496	116	6832	122	P	6888	123	P	3752	67	6776	121	P	4256	76	3696	66	6944	124	P	56
NV-1-16L-1-50K	6720	120	7168	128	P	7224	129	P	3976	71	7112	127	P	4480	80	3920	70	7280	130	P	56
NV-1-32L-7-30K	7952	112	7810	110	S	7810	110	S	4473	63	7739	109	S	5112	72	4402	62	7881	111	S	71
NV-1-32L-7-40K	8236	116	9017	127	P	8449	119	P	4757	67	8307	117	P	5396	76	4686	66	8520	120	P	71
NV-1-32L-7-50K	8520	120	9159	129	P	8875	125	P	5041	71	8733	123	P	5680	80	4970	70	8946	126	P	71
NV-1-32L-1-30K	11872	112	11660	110	S	12084	114	S	6678	63	11820	112	S	7632	72	6572	62	12190	115	S	106
NV-1-32L-1-40K	12296	116	12932	122	P	13038	123	P	7102	67	12826	121	P	8056	76	6996	66	13144	124	P	106
NV-1-32L-1-50K	12720	120	13568	128	P	13674	129	P	7526	71	13462	127	P	8480	80	7420	70	13780	130	P	106
NV-1-48L-7-30K	11648	112	11440	110	S	11440	110	S	6552	63	11336	109	S	7488	72	6448	62	11544	111	S	104
NV-1-48L-7-40K	12064	116	13208	127	P	12376	119	P	6968	67	12168	117	P	7904	76	6864	66	12480	120	P	104
NV-1-48L-7-50K	12480	120	13520	130	P	13000	125	P	7384	71	12792	123	P	8320	80	7280	70	13104	126	P	104
NV-1-48L-1-30K	17472	112	17160	110	S	17784	114	S	9828	63	17472	112	S	11232	72	9672	62	17940	115	S	156
NV-1-48L-1-40K	18096	116	19032	122	P	19188	123	P	10452	67	18876	121	P	11856	76	10296	66	19344	124	P	156
NV-1-48L-1-50K	18720	120	19968	128	P	20124	129	P	11076	71	19812	127	P	12480	80	10920	70	20280	130	P	156
NV-1-64L-7-30K	15232	112	14960	110	S	14960	110	S	8568	63	14824	109	S	9792	72	8432	62	15096	111	S	136
NV-1-64L-7-40K	15776	116	17272	127	P	16184	119	P	9112	67	15912	117	P	10336	76	8976	66	16320	120	P	136
NV-1-64L-7-50K	16320	120	17680	130	P	17000	125	P	9656	71	16728	123	P	10880	80	9520	70	17136	126	P	136
NV-1-64L-1-30K	22960	112	22550	110	S	23370	114	S	12915	63	22960	112	S	14760	72	12710	62	23575	115	S	205
NV-1-64L-1-40K	23780	116	25010	122	P	25215	123	P	13735	67	24805	121	P	15580	76	13530	66	25420	124	P	205
NV-1-64L-1-50K	24600	120	26240	128	P	26445	129	P	14555	71	26035	127	P	16400	80	14350	70	26650	130	P	205

*DLC S= Standard  P= Premium 

BUG RATINGS

PART NUMBER	T2	T3	T3 HSS	T4	T4 HSS	T5
NV-1-16L-35-30K	B1-U0-G1	B1-U0-G1	B0-U0-G0	B1-U0-G1	B0-U0-G0	B2-U0-G0
NV-1-16L-35-40K	B1-U0-G1	B1-U0-G1	B0-U0-G0	B1-U0-G1	B0-U0-G0	B2-U0-G0
NV-1-16L-35-50K	B1-U0-G1	B1-U0-G1	B0-U0-G0	B1-U0-G1	B0-U0-G0	B2-U0-G2
NV-1-16L-53-30K	B1-U0-G1	B1-U0-G1	B0-U0-G1	B1-U0-G1	B0-U0-G1	B2-U0-G1
NV-1-16L-53-40K	B1-U0-G1	B1-U0-G1	B0-U0-G1	B1-U0-G1	B0-U0-G1	B2-U0-G1
NV-1-16L-53-50K	B1-U0-G1	B1-U0-G1	B0-U0-G1	B1-U0-G1	B0-U0-G1	B2-U0-G1
NV-1-16L-7-30K	B1-U0-G1	B1-U0-G1	B0-U0-G1	B1-U0-G1	B0-U0-G1	B3-U0-G1
NV-1-16L-7-40K	B1-U0-G1	B1-U0-G1	B0-U0-G1	B1-U0-G1	B0-U0-G1	B3-U0-G1
NV-1-16L-7-50K	B1-U0-G1	B1-U0-G1	B0-U0-G1	B1-U0-G1	B0-U0-G1	B3-U0-G1
NV-1-16L-1-30K	B1-U0-G1	B1-U0-G1	B0-U0-G1	B1-U0-G1	B0-U0-G1	B3-U0-G1
NV-1-16L-1-40K	B1-U0-G1	B2-U0-G2	B0-U0-G1	B2-U0-G2	B0-U0-G1	B3-U0-G2
NV-1-16L-1-50K	B1-U0-G2	B2-U0-G2	B0-U0-G1	B2-U0-G2	B0-U0-G1	B3-U0-G2
NV-1-32L-7-30K	B1-U0-G2	B2-U0-G2	B0-U0-G1	B2-U0-G2	B0-U0-G1	B3-U0-G2
NV-1-32L-7-40K	B1-U0-G2	B2-U0-G2	B0-U0-G1	B2-U0-G2	B0-U0-G2	B3-U0-G2
NV-1-32L-7-50K	B2-U0-G2	B2-U0-G2	B0-U0-G2	B2-U0-G2	B0-U0-G2	B3-U0-G2
NV-1-32L-1-30K	B2-U0-G2	B2-U0-G2	B0-U0-G2	B2-U0-G2	B0-U0-G2	B4-U0-G2
NV-1-32L-1-40K	B2-U0-G2	B2-U0-G2	B0-U0-G2	B3-U0-G2	B0-U0-G2	B4-U0-G2
NV-1-32L-1-50K	B2-U0-G2	B3-U0-G3	B0-U0-G2	B3-U0-G3	B0-U0-G2	B4-U0-G2
NV-1-48L-7-30K	B2-U0-G2	B2-U0-G2	B0-U0-G2	B2-U0-G2	B0-U0-G2	B4-U0-G2
NV-1-48L-7-40K	B2-U0-G2	B2-U0-G2	B0-U0-G2	B2-U0-G2	B0-U0-G2	B4-U0-G2
NV-1-48L-7-50K	B2-U0-G2	B3-U0-G3	B0-U0-G2	B2-U0-G2	B0-U0-G2	B4-U0-G2
NV-1-48L-1-30K	B3-U0-G3	B3-U0-G3	B1-U0-G2	B3-U0-G3	B1-U0-G2	B4-U0-G2
NV-1-48L-1-40K	B3-U0-G3	B3-U0-G3	B1-U0-G2	B3-U0-G3	B1-U0-G2	B5-U0-G3
NV-1-48L-1-50K	B3-U0-G3	B3-U0-G3	B1-U0-G2	B3-U0-G3	B1-U0-G2	B5-U0-G3
NV-1-64L-7-30K	B2-U0-G2	B3-U0-G3	B0-U0-G2	B3-U0-G3	B1-U0-G2	B4-U0-G2
NV-1-64L-7-40K	B3-U0-G3	B3-U0-G3	B0-U0-G2	B3-U0-G3	B1-U0-G2	B4-U0-G2
NV-1-64L-7-50K	B3-U0-G3	B3-U0-G3	B1-U0-G2	B3-U0-G3	B1-U0-G2	B4-U0-G2
NV-1-64L-1-30K	B3-U0-G3	B3-U0-G3	B1-U0-G2	B3-U0-G3	B1-U0-G3	B5-U0-G3
NV-1-64L-1-40K	B3-U0-G3	B3-U0-G3	B1-U0-G3	B3-U0-G4	B1-U0-G3	B5-U0-G3
NV-1-64L-1-50K	B3-U0-G3	B3-U0-G3	B1-U0-G3	B3-U0-G4	B1-U0-G3	B5-U0-G3



701 Kingshill Place, Carson, CA 90746
Call Us Today (310) 341-2037

nslighting.com

OPTICAL CONFIGURATIONS

Rotatable Optics (ROR) Rotated Right, (ROL) Rotated Left options available. Optics field and factory rotatable.

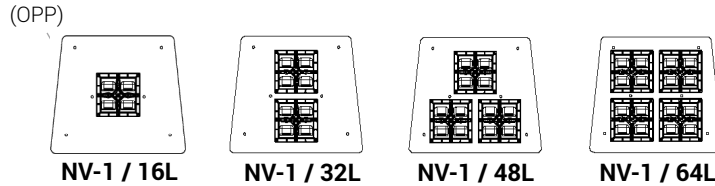

* **OPTIC PLATE PAINTED TO MATCH FIXTURE FINISH (OPP)**– Optic Plate standard clear anodized, Grade 2. When (OPP) specified, Optic Plate finish will match fixture finish.

EPA

EPA	SGL	D90	D180	T90	T120	QD
NV-1-DP	0.46	1.14	0.92	1.34	1.37	1.34
NV-1-KM	0.54	N/A	1.08	N/A	N/A	N/A
NV-1-ASA	0.75	1.29	1.50	1.99	2.05	1.99

L70/L90 DATA

TEMP.	NV-1	
	L70 (64L-1050mA)	L90 (64L-1050mA)
25°C	483,000	160,000

DPX ARM LENGTH

DPX ARM LENGTH	SGL	D90	D180	T90	T120	QD
NV-1	3"	7"	3"	7"	7"	7"

MOUNTING OPTIONS

DIRECT POLE (DP)

Standard mounting arm is extruded aluminum in lengths of 3" and 7".

*Arm lengths may vary depending on configuration

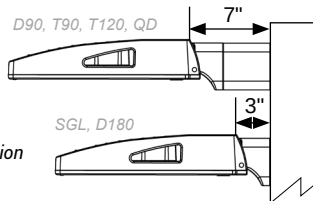

TENNIS ARM (TA)

Steel fitter slips over 3.5" x 1.5" rectangular arm.

*See Tennis Arm Spec Sheet for details

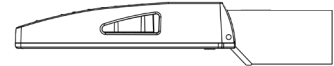

WALL MOUNT (WM)

Cast Aluminum Plate for direct wall mount. 3" extruded aluminum arm mounts directly to a cast wall mount box.

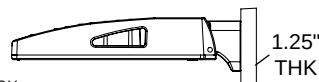

TRUNNION MOUNT (TM)

Steel, bolt-on-mounting for adjustable installation with a maximum uplift of 90 degrees.

*Unpainted stainless steel is standard

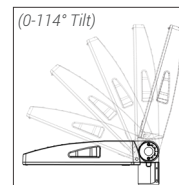
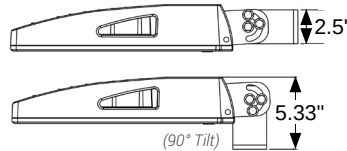

KNUCKLE MOUNT (KM)

Die Cast Knuckle great for adjustable installation on 2-3/8" OD vertical or horizontal tenon.

- Max Uptilt of 114 degrees
- Adjustable in 6 degree increments

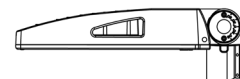

OPTIONAL

Optional Cast Aluminum Bracket, **Quick Mount Bracket (QMB)** and **Retrofit Quick Mount Bracket (RQMB)**, designed for quick mounting on Direct Square or Round Poles. Cleat mounts directly to pole for easily hung fixtures.

