

CATHEDRAL ROCK COMMONS COMMERCIAL

A PORTION OF THE NORTHEAST QUARTER OF THE SOUTHEAST QUARTER OF SECTION 36, TOWNSHIP 11 SOUTH,
RANGE 67 WEST OF THE 6TH P.M., EL PASO COUNTY, COLORADO

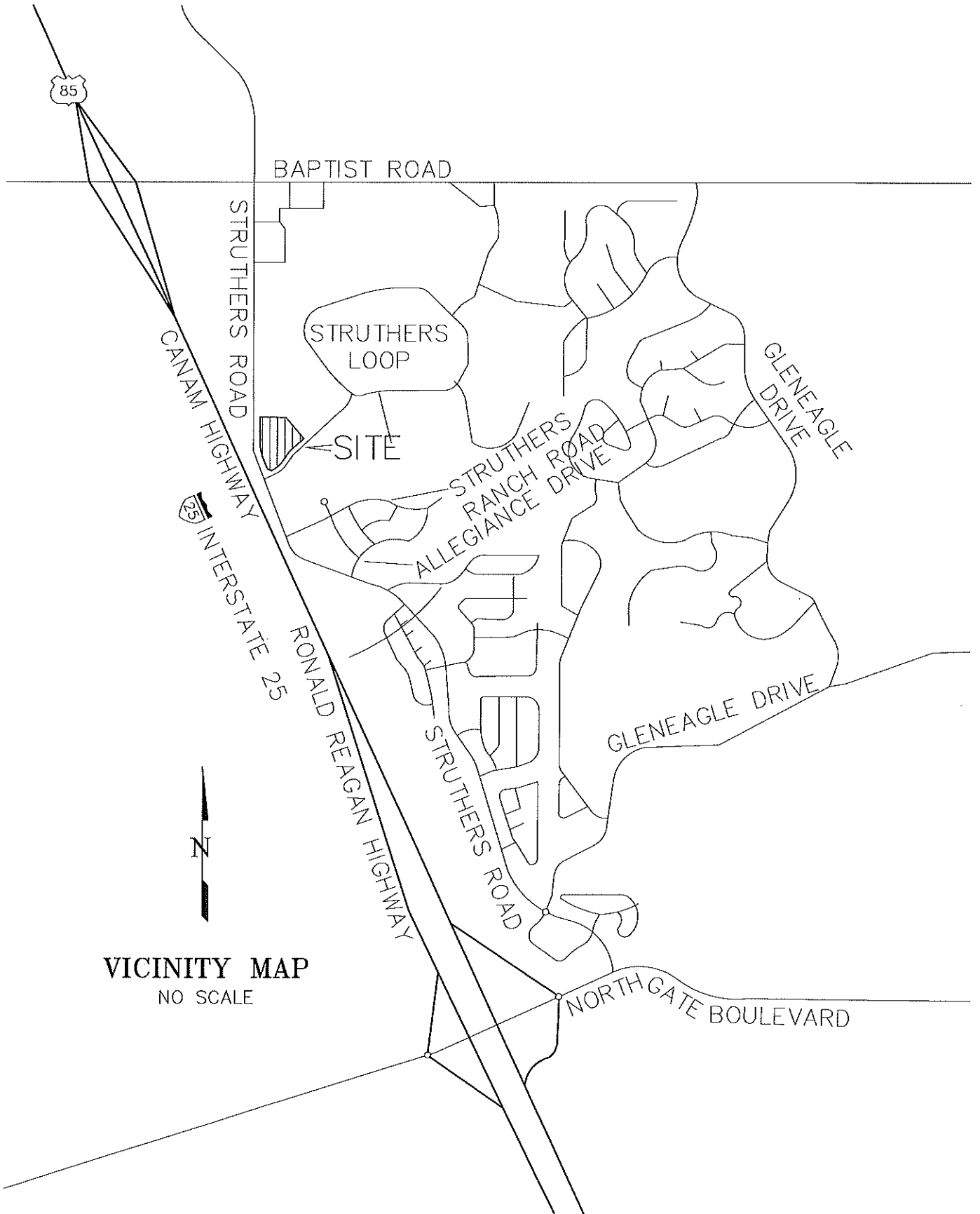

VICINITY MAP
NO SCALE