

# STRATMOOR HILLS WATER DISTRICT - CENTRALIZED WATER TREATMENT

SITE DEVELOPMENT PLANS  
 LOT 2, GLENARM SUBDIVISION FILING NO. 2  
 PCD Filing No. PPR2026

- EXISTING LEGEND**
- ~A~ ASPHALT SURFACE
  - ~C~ CONCRETE SURFACE
  - FL FLOW LINE
  - TBC TOP/BACK OF CURB
  - ROW RIGHT-OF-WAY
  - ~LS~ LANDSCAPING
  - FO FIBER OPTIC VAULT
  - ⊕ GAS SIGN
  - ☆ LIGHT POLE
  - ⊞ MAILBOX
  - ⊙ SANITARY SEWER MANHOLE
  - ⊙ TRAFFIC BOLLARD
  - ⊙ TRAFFIC SIGN
  - ⊞ TELEPHONE PEDestal
  - ⊙ UNKNOWN MANHOLE
  - UTILITY GUY WIRE
  - ⊙ UTILITY POLE
  - ⊙ VENT PIPE
  - ⊙ WATER HYDRANT
  - ⊙ WATER METER
  - ⊙ WATER VALVE
  - ⊙ WATER MANHOLE
  - (OE)— OVERHEAD UTILITY LINE(S)
  - (UE)— UNDERGROUND ELECTRICAL LINE(S)
  - (FO)— UNDERGROUND FIBER OPTIC LINE(S)
  - (UG)— UNDERGROUND GAS LINE(S)
  - (SS)— UNDERGROUND SANITARY SEWER LINE(S)
  - (UT)— UNDERGROUND TELEPHONE LINE(S)
  - (UL)— UNDERGROUND WATERMAIN LINE(S)
  - (CL)— CHAIN-LINK FENCE
  - (WF)— WOOD FENCE
  - (PF)— PLASTIC FENCE
  - (WS)— WIRE STRAND FENCE
- PROPOSED LEGEND**
- PW— POTABLE WATER LINE
  - RW— RAW WATER LINE
  - SS— SANITARY SEWER LINE
- BMP LEGEND**
- VTC VEHICLE TRACKING CONTROL
  - SBIP STRAW BALE INLET PROTECTION
  - SF SILT FENCE
  - SFB SAND FILTER BASIN

STORM DRAIN SYSTEM DATA	
INLET	<ul style="list-style-type: none"> <li>• TOP OF GRATE - EL. 5773.0'</li> <li>• INLET FLOOR - EL. 5769.0'</li> <li>• 12" INV. OUT - EL. 5770.0'</li> </ul>
STORM MANHOLE	<ul style="list-style-type: none"> <li>• INV. IN - EL. 5759.65'</li> <li>• INV. OUT - EL. 5769.45'</li> </ul>
SAND FILTER INFILTRATION BASIN	<ul style="list-style-type: none"> <li>• 12" SD DISCHARGE - INV. EL. 5769.0'</li> </ul>

**NOTES:**

- THE SAND FILTER BASIN IS DESIGNED FOR INFILTRATION TO PREVENT STANDING WATER AFTER STORM EVENTS HAVE ENDED. STRATMOOR HILLS WATER DISTRICT WILL REGULARLY MONITOR THE SAND FILTER BASIN AND TAKE ACTIONS TO PREVENT LONG PERIODS OF STANDING WATER TO CONTROL MOSQUITO BREEDING HABITAT, THEREBY MINIMIZING THE POTENTIAL FOR MOSQUITO-SPREAD VIRUSES.

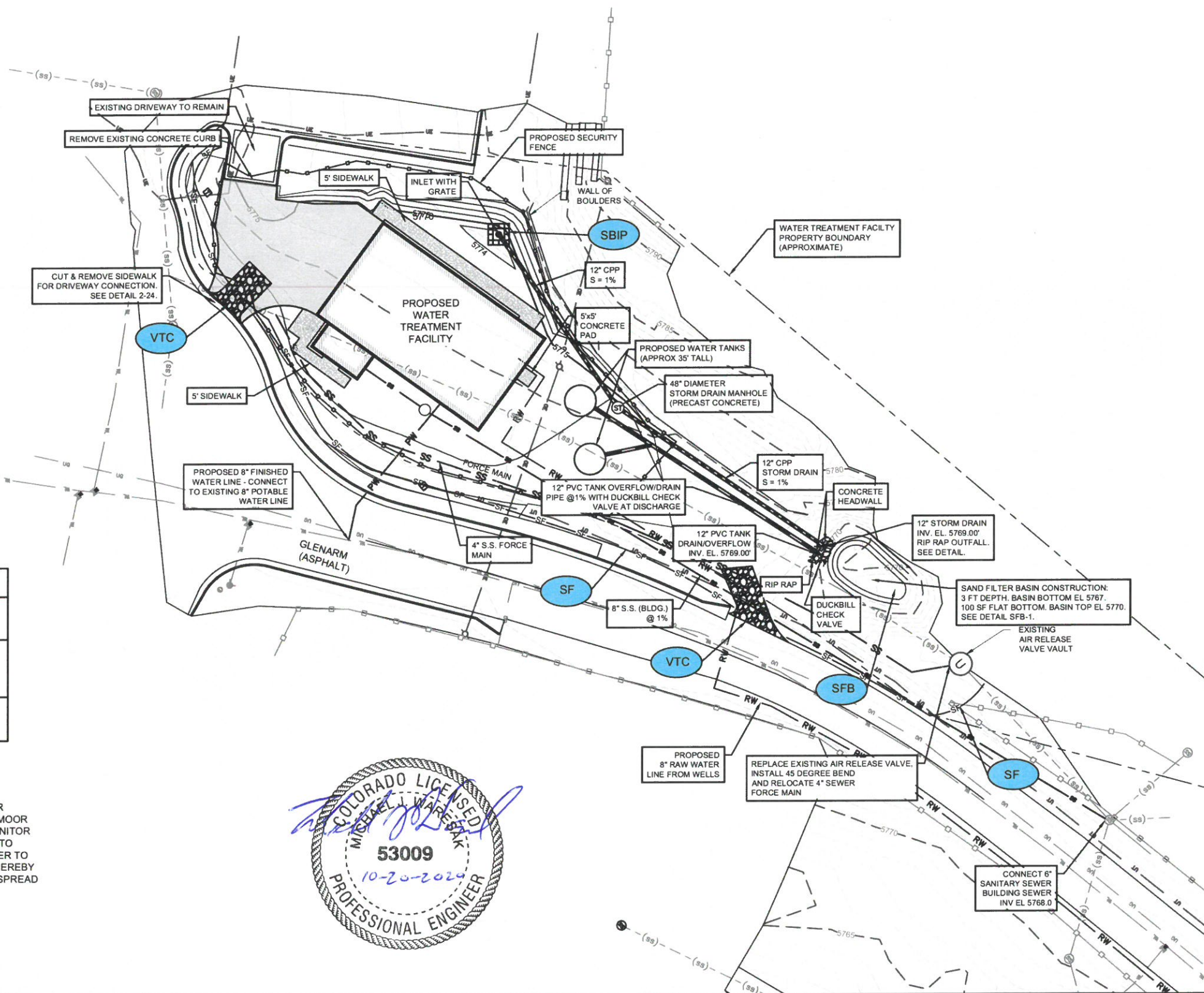
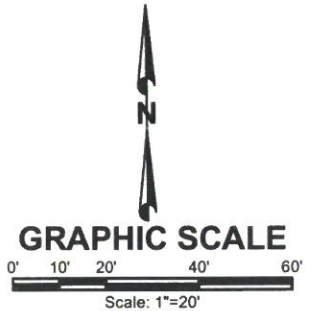

P:\Clients\Stratmoor Hills WSD\04-18-0103 - Centralized Treatment\CAD\Sheet\SS\Site Development Plans\SS GRADING AND EROSION CONTROL.dwg - 10/20/2020 11:38 AM

<table border="1" style="width: 100%; border-collapse: collapse;"> <tr> <td style="width: 5%;">NO.</td> <td style="width: 10%;">REVISIONS</td> <td style="width: 5%;">BY</td> <td style="width: 5%;">DATE</td> </tr> <tr> <td> </td> <td> </td> <td> </td> <td> </td> </tr> </table>	NO.	REVISIONS	BY	DATE					DRAWN _____ S. CALE DESIGNED _____ C. KOCH APPROVED _____ M. WARESAK QA _____ QA BY _____	<b>ATTENTION</b> LINE IS 2 INCHES AT FULL SIZE (IF NOT 2" SCALE ACCORDINGLY)	<b>STRATMOOR HILLS                  WATER DISTRICT</b>	 56 INVERNESS DRIVE EAST #112, ENGLEWOOD, CO 80112 PH: 720-214-5884	<b>CENTRALIZED WATER TREATMENT</b> <b>GRADING AND EROSION CONTROL PLAN</b>	PROJECT NO: <b>04-18-0103</b> SHEET NO: <b>5</b> DATE: AUG. 2020 PAGE NO: 5 OF 7
NO.	REVISIONS	BY	DATE											