



290 E. Woodmen Rd., Colorado Springs, CO 80919

719.388.5000 • info@woodmenvalley.org

woodmenvalley.org

Rockrimmon Christian Preschool @ Woodmen Valley Chapel Land Use Statement

Land Use Statement:

From the document submitted named "Legal Description and Map of WVC 260 E Woodmen" on page 2, named "DP-2" of the site plan, you will see the existing "Noah's Ark Sunday School" which is the building at 260 E. Woodmen Road and is currently used as the Elementary Sunday School building at Woodmen Valley Chapel-Rockrimmon Campus. Elementary Sunday School is used on Saturday evening during one service and on Sunday morning for two services.

The outdoor use of the playground consists of the areas labeled as "Emily's Playground", "Upper Playground" and the "Lower Playground" to the East and South East of the building. See below:

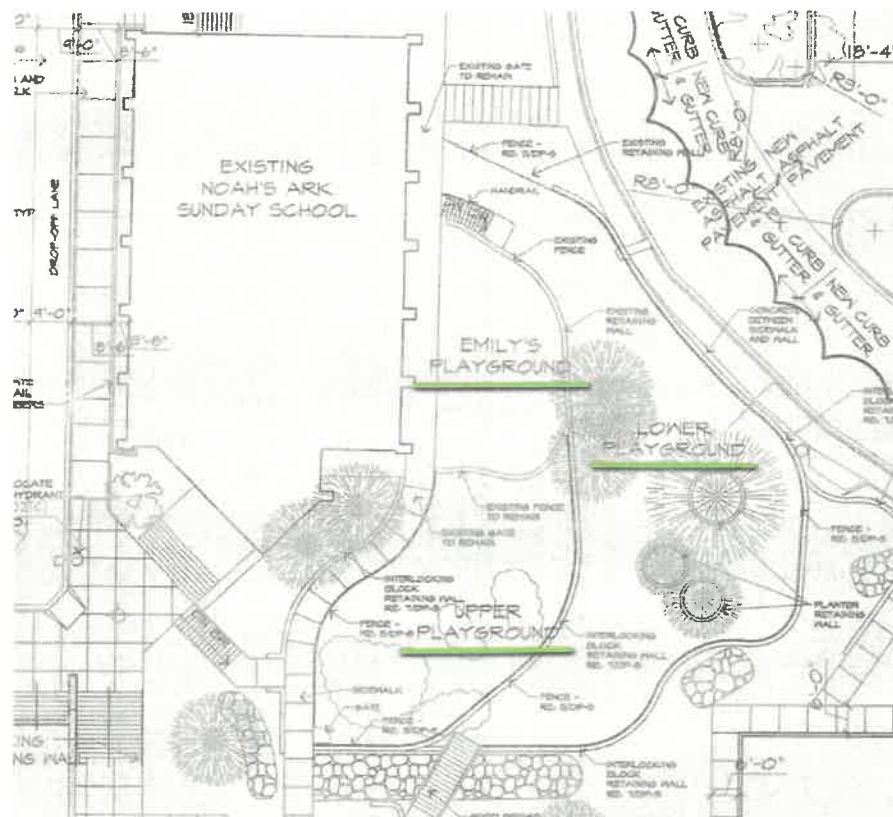

It is Woodmen Valley Chapel and Rockrimmon Christian Preschool's understanding that this outside land use of the playground conforms with, and is compatible with, all adjacent development patterns, including but not limited to light, noise and traffic. There is no other land use planned by Rockrimmon Christian Preschool.